



* 0 0 B R E A K 0 0 *



**ADVANCED
IMAGING
SYSTEMS**

www.aisimc.com

An Information
Management Company

City of Charlotte – Planning Dept. Scanning Rezoning Files

Petition # _____

Document type:

- Applications
- Correspondence
- Department Comments
- Land Use Consistency
 - Mail Info
 - Mapping
 - Other
- Site Plans



* 0 0 B R E A K 0 0 *

MECKLENBURG COUNTY, NC GIS PUBLIC ACCESS SYSTEM

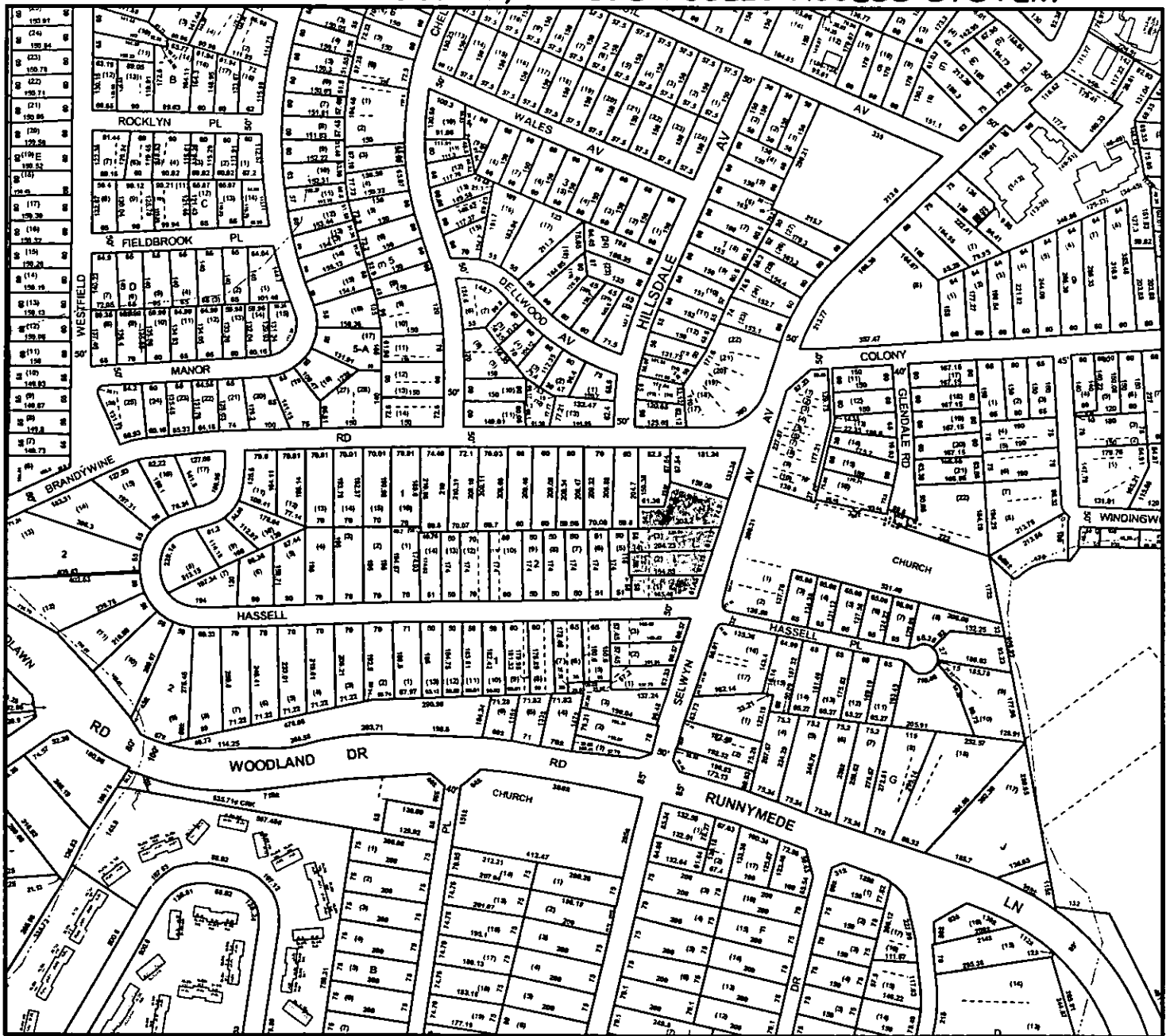

Tax Parcel-Id#s Selected: See Tax Information Report for List of Parcel-Id#s

Tax Book & Page Selected: N/A

02-143

LEGEND

- County Boundary
- Rivers/Creeks/Streams
- Railroad ROW
- Water Bodies
- Jurisdictions**
- County
- Charlotte
- Cornelius
- Davidson
- Huntersville
- Matthews
- Mint Hill
- Pineville

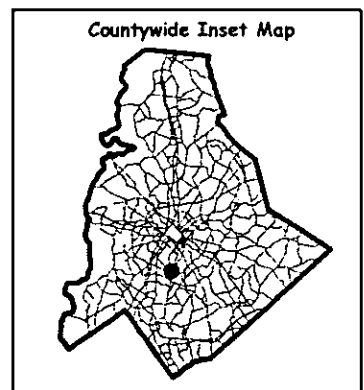
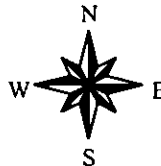

Scale : 1 Inch = 400 Feet

Map Created on Thursday, January 2, 2003 12:34 PM

This map is prepared for the inventory of real property within Mecklenburg County and is compiled from recorded deeds, plats, tax maps, surveys, planimetric maps, and other public records and data. Users of this map are hereby notified that the aforementioned public primary information sources should be consulted for verification. Mecklenburg County and its mapping contractors assume no legal responsibility for the information contained herein.

02-143

Zone	ODzone_area
99	0.495690
100	0.373582
101	0.444010
104	0.335682
105	0.277821
106	0.492670
107	0.240029
108	0.505347
109	0.900398
110	0.520117
127	0.477862
131	0.626537
132	0.345611
137	0.460724
138	0.881082
142	0.233962
156	0.288154

Petition #: 2002-143

Petitioner: The Boulevard 2000, LLC

Hearing Date: December 16, 2002

Zoning Classification (Existing): O-2 and R-5

Zoning Classification (Requested): UR-2(CD)

Acresage & Location Approximately 1.2 acres located at the northwest corner of Selwyn Avenue and Hassell Place

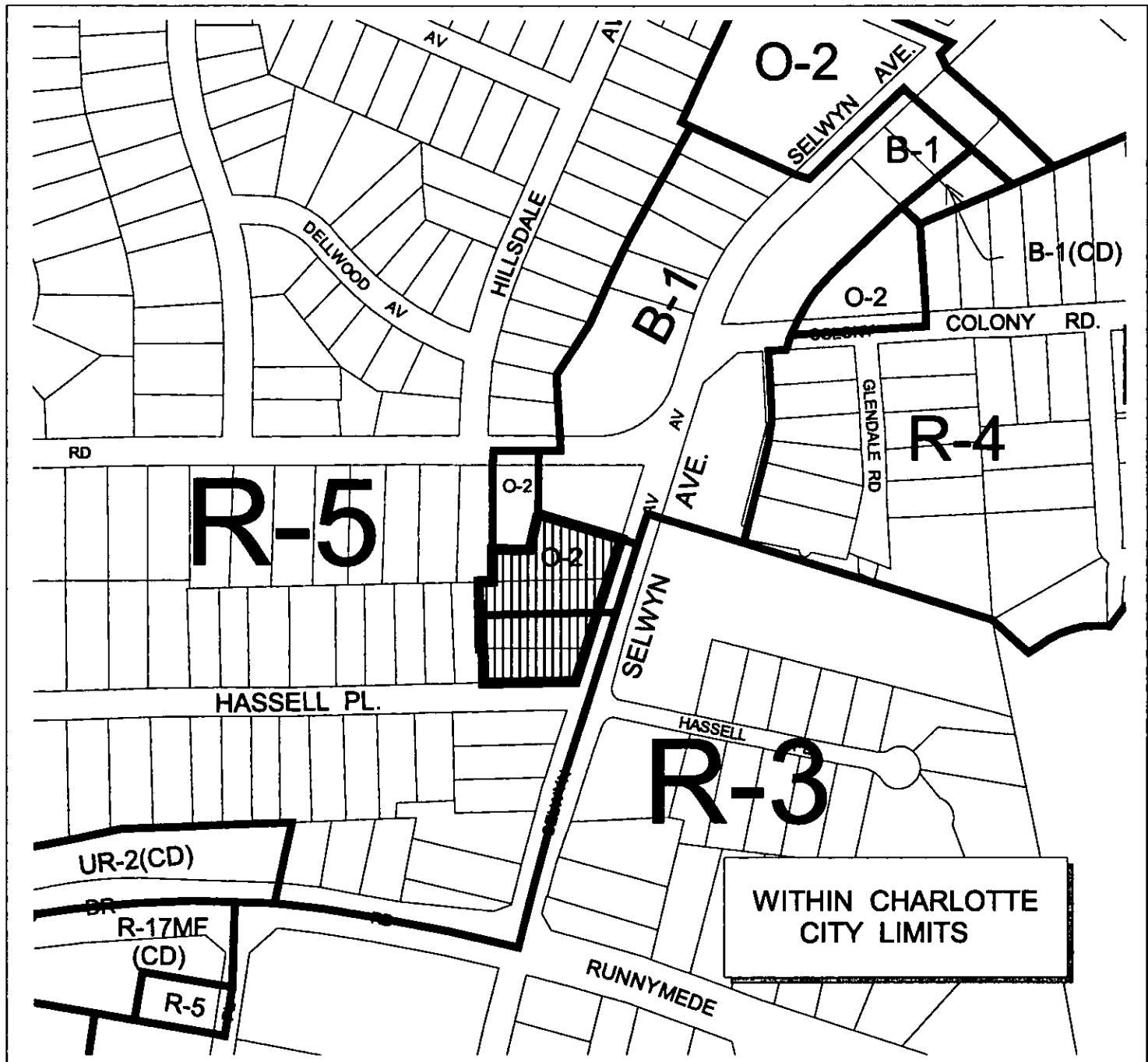

WITHIN CHARLOTTE CITY LIMITS



Zoning Map #(s):

125

Map Legend

	EU		Neighborhood
	Alcoholship		County Line
	Watershed		City Limits
	Historic District		