

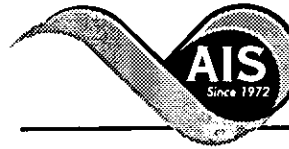

\* 0 0 B R E A K 0 0 \*



**ADVANCED  
IMAGING  
SYSTEMS**

www.aisimc.com

An Information  
Management Company

# City of Charlotte – Planning Dept. Scanning Rezoning Files

Petition # \_\_\_\_\_

## Document type:

- Applications
- Correspondence
- Department Comments
- Land Use Consistency
  - Mail Info
  - Mapping
  - Other
- Site Plans



\* 0 0 B R E A K 0 0 \*

Mecklenburg County, North Carolina

**POLARIS**

Property Ownership Land Records Information System

Date Printed: Wed Oct 12 08:37:34 EDT 2005

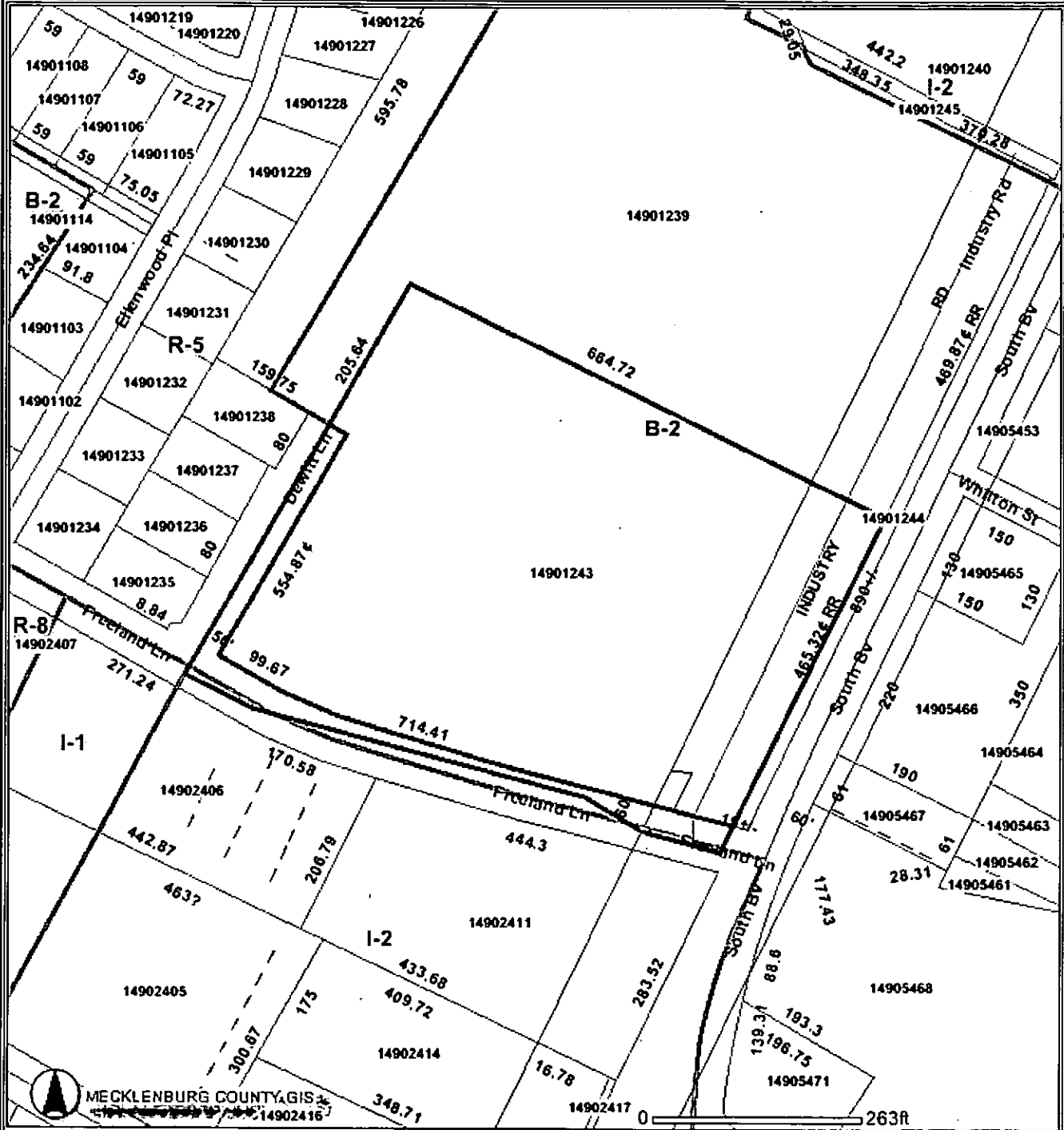

This map is prepared for the inventory of real property within Mecklenburg County and is compiled from recorded deeds, plats, tax maps, surveys, planimetric maps, and other public records and data. Users of this map are hereby notified that the aforementioned public primary information sources should be consulted for verification. Mecklenburg County and its mapping contractors assume no legal responsibility for the information contained herein.

Petition #: **2006-009**

Petitioner: Charlotte Mecklenburg Planning Commission

Zoning Classification (Existing): B-2  
(General Business)

Zoning Classification (Requested): TOD-M  
(Transit Oriented Development, Mixed-use)

Acreage & Location : Approximately 8.248 acres located west of South Blvd  
and north of Freeland Ln.

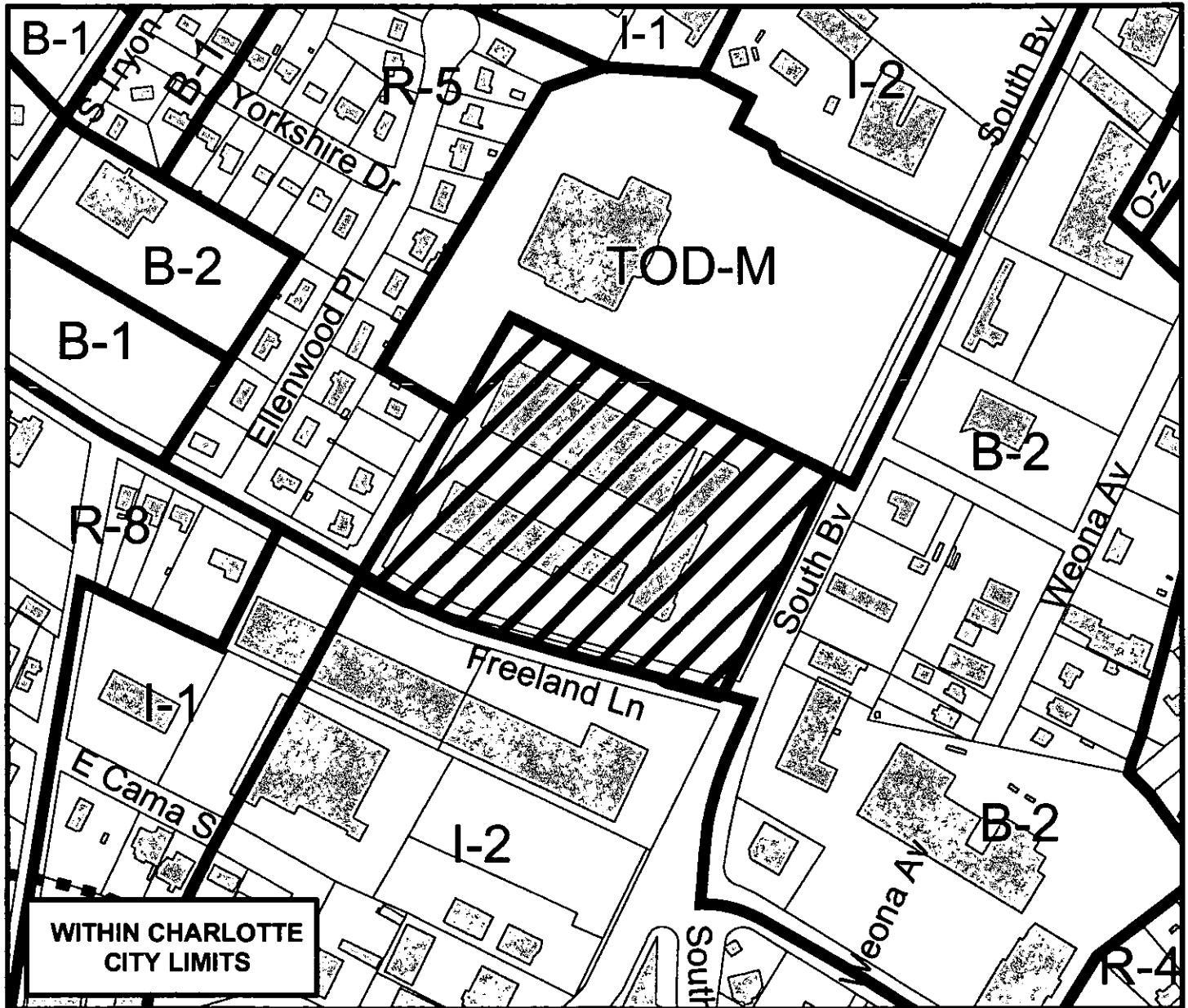

Zoning Map #(s) **110**

Map Produced by the  
Charlotte-Mecklenburg Planning Commission  
10-12-2005



	<b>Requested TOD-M from B-2</b>		Fema Flood Plain
	Existing Building Footprints		Lakes and Ponds
	Existing Zoning Boundaries		Creeks and Streams
	Charlotte City Limits		