



\* 0 0 B R E A K 0 0 \*



**ADVANCED  
IMAGING  
SYSTEMS**

www.aisimc.com

An Information  
Management Company

# City of Charlotte – Planning Dept. Scanning Rezoning Files

Petition # \_\_\_\_\_

## Document type:

- Applications
- Correspondence
- Department Comments
- Land Use Consistency
  - Mail Info
  - Mapping
  - Other
- Site Plans



\* 0 0 B R E A K 0 0 \*

Petition #: **2006-105**

Petitioner: Charlotte-Mecklenburg Planning Commission

Zoning Classification (Existing): I-2  
(General industrial)

Zoning Classification (Requested): TOD-M  
(Transit-oriented development, mixed-use)

Acreage & Location : Approximately 4.16 acres located on the west side of South Boulevard in the vicinity of Meacham Street

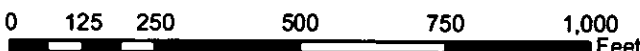
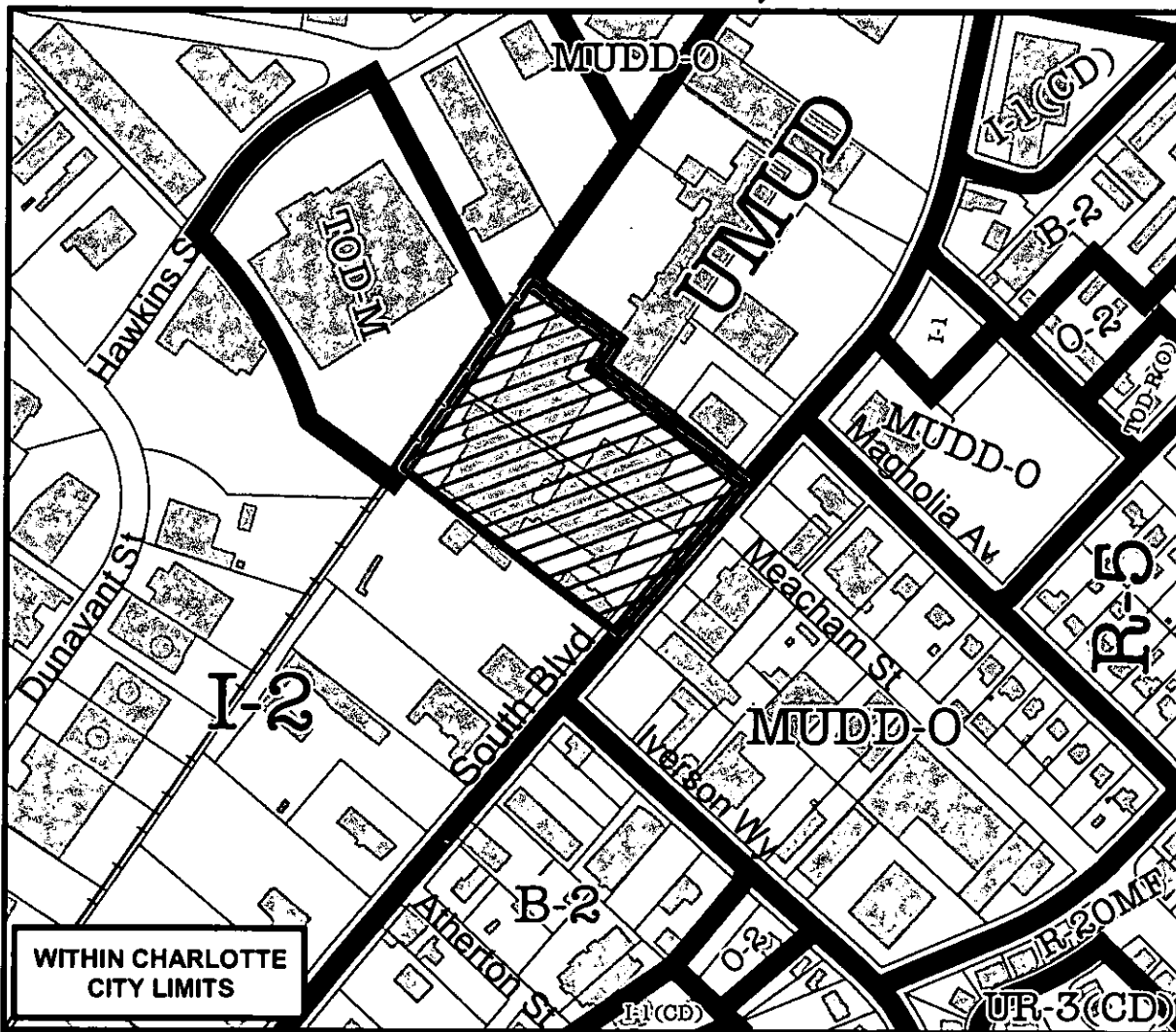

Zoning Map #(s) **110**

Map Produced by the  
Charlotte-Mecklenburg Planning Commission  
05-26-2006



	Requested TOD-M from I-2		FEMA flood plain
	Existing Building Footprints		Watershed
	Existing Zoning Boundaries		Lakes and Ponds
	Charlotte City Limits		Creeks and Streams

Mecklenburg County, North Carolina  
**POLARIS**  
 Property Ownership Land Records Information System

Date Printed: Fri May 26 11:28:26 EDT 2006

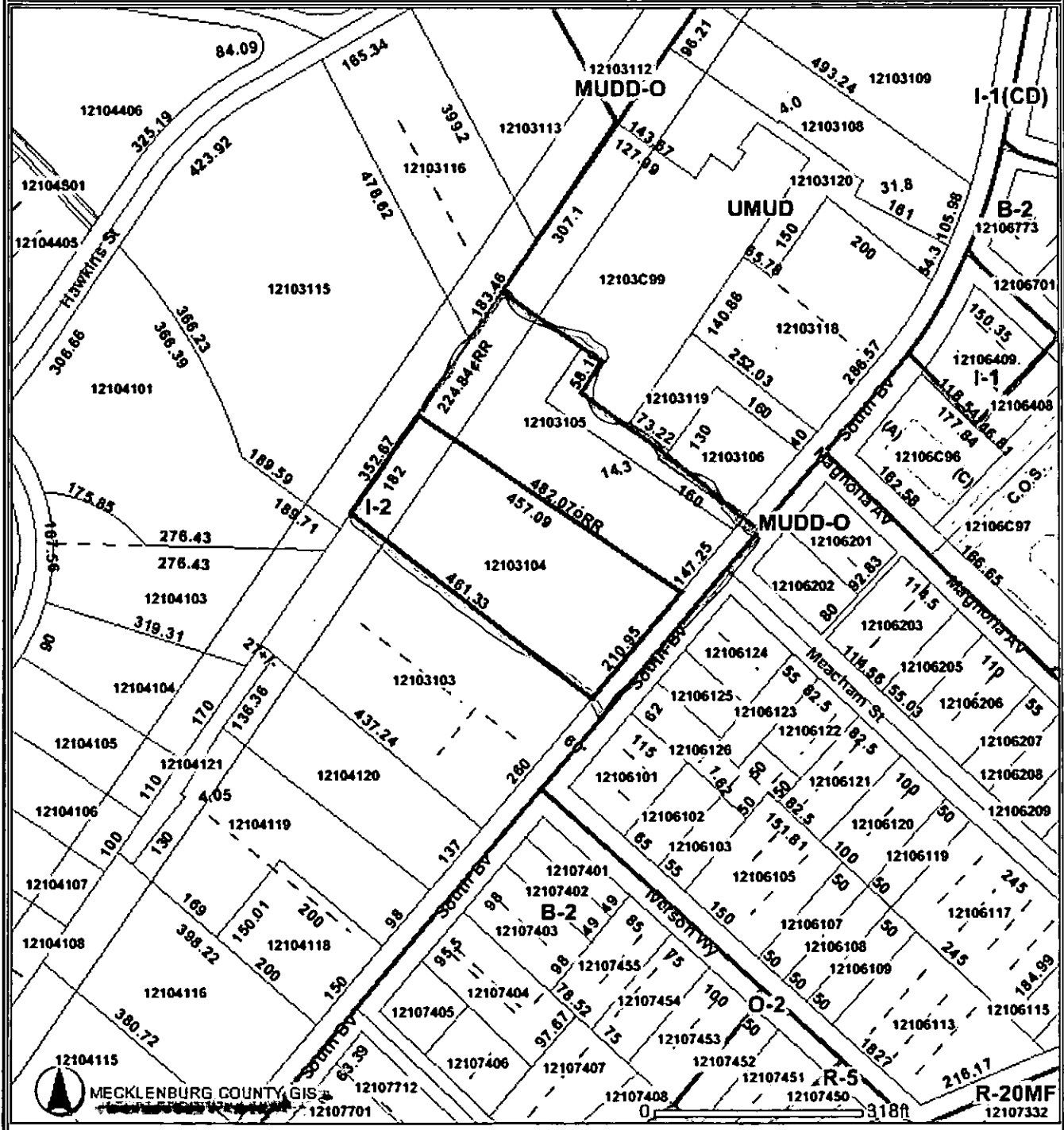

MECKLENBURG COUNTY GIS  
 12107712  
 12107701

This map is prepared for the inventory of real property within Mecklenburg County and is compiled from recorded deeds, plats, tax maps, surveys, planimetric maps, and other public records and data. Users of this map are hereby notified that the aforementioned public primary information sources should be consulted for verification. Mecklenburg County and its mapping contractors assume no legal responsibility for the information contained herein.