



* 0 0 B R E A K 0 0 *



**ADVANCED
IMAGING
SYSTEMS**

www.aisimc.com

An Information
Management Company

City of Charlotte – Planning Dept. Scanning Rezoning Files

Petition # _____

Document type:

- Applications
- Correspondence
- Department Comments
- Land Use Consistency
 - Mail Info
 - Mapping
 - Other
- Site Plans



* 0 0 B R E A K 0 0 *

Mecklenburg County, North Carolina
POLARIS
 Property Ownership Land Records Information System

Date Printed: Mon Aug 28 13:25:14 EDT 2006

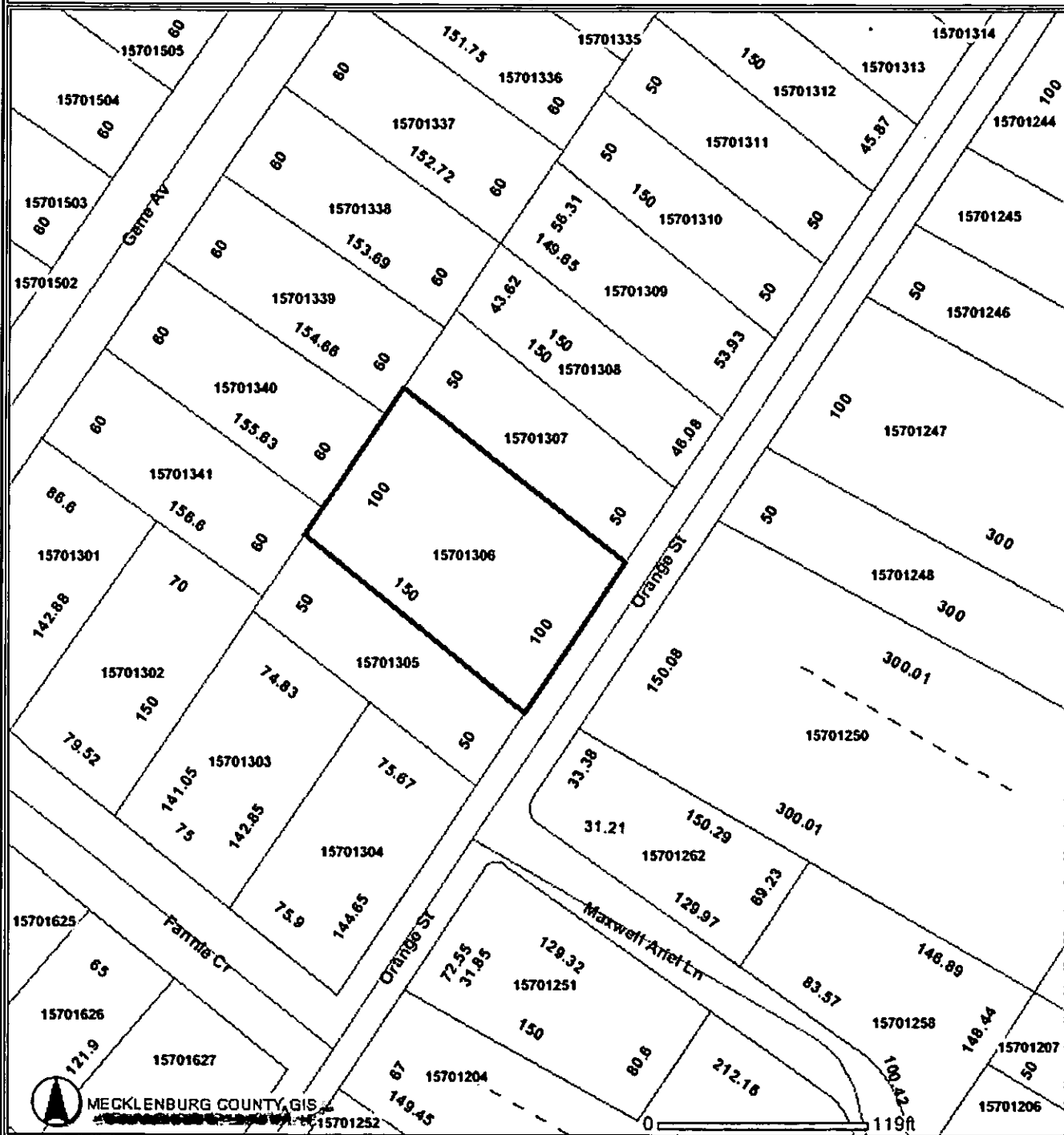

This map is prepared for the inventory of real property within Mecklenburg County and is compiled from recorded deeds, plats, tax maps, surveys, planimetric maps, and other public records and data. Users of this map are hereby notified that the aforementioned public primary information sources should be consulted for verification. Mecklenburg County and its mapping contractors assume no legal responsibility for the information contained herein.

Petition #: **2006-159**

Petitioner: City of Charlotte Neighborhood Development

Zoning Classification (Existing): R-5
(Single-Family Residential, up to 5 dwelling units per acre)

Zoning Classification (Requested): R-6
(Single-Family Residential, up to 6 dwelling units per acre)

Acreeage & Location : Approximately 0.4 acres located on the west side of Orange Street north of Maxwell Ariel Lane.

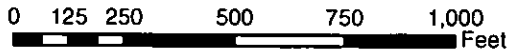
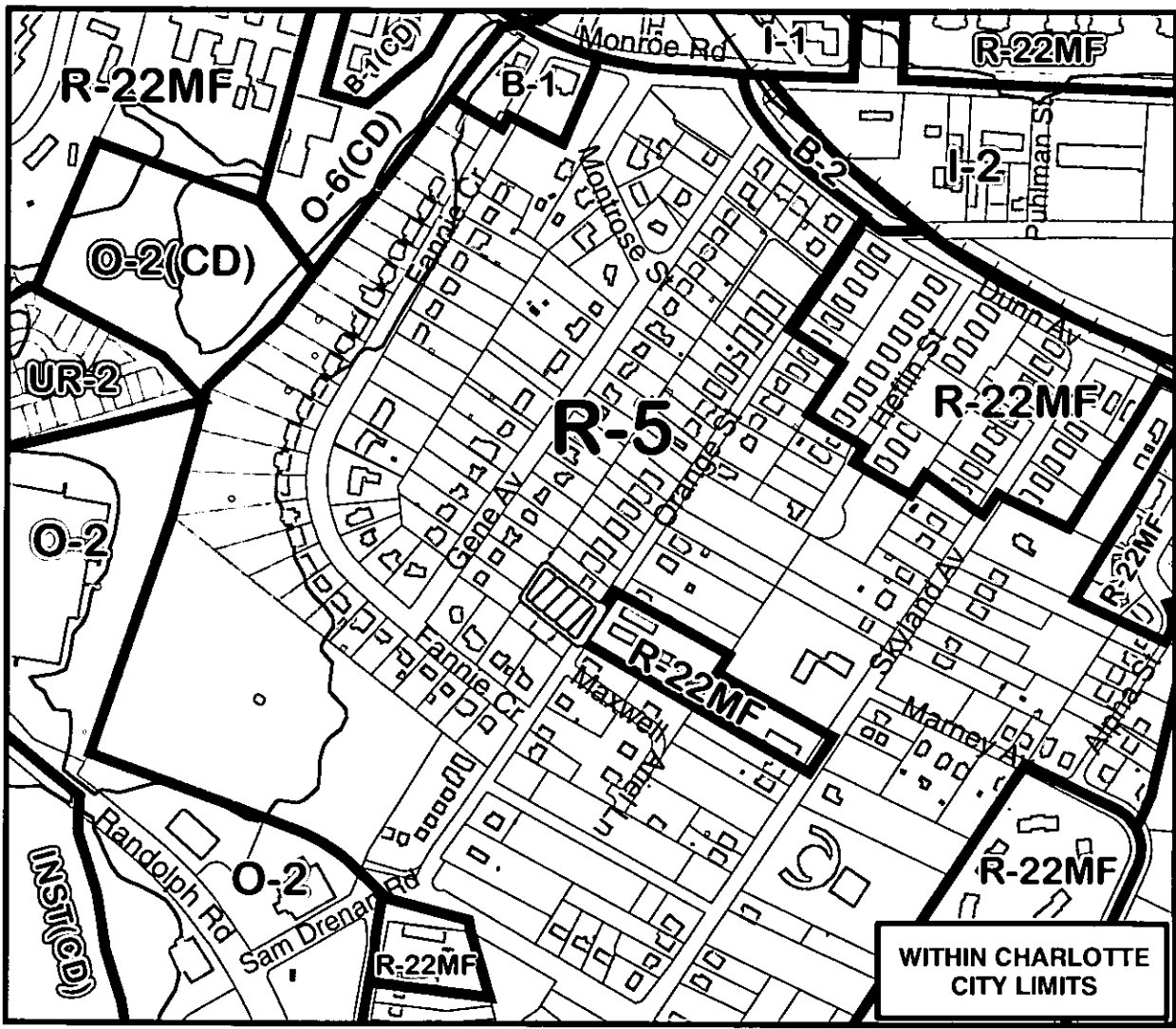

Zoning Map #(s) **112**

Map Produced by the
Charlotte-Mecklenburg Planning Commission
09-07-2006



	Requested R-6 from R-5		FEMA flood plain
	Existing Building Footprints		Watershed
	Existing Zoning Boundaries		Lakes and Ponds
	Charlotte City Limits		Creeks and Streams