



Cole Jenest & Stone

Site Planning, Landscape Architecture, Civil Engineering, Urban Design

300 South Tryon Street, Suite 1400 Charlotte, NC 28202

POPE & LAND ENTERPRISES, INC

CITY PARK

CHARLOTTE, NORTH CAROLINA

TECHNICAL DATA SHEET For Public Hearing Petition # 2007-082

Project No. 3592 Issued 03.26.07

Revised 09/14/07, 10/25/07, 11/16/07, 12/14/07, 04/12/08 - ADMINISTRATIVE AMENDMENT

ATTACHED TO ADMINISTRATIVE APPROVAL

DATED March 25, 2007 BY: DEBRA D. CAMPBELL

SCALE: 1" = 20'

RZ1.0

The drawings, the project manual and the design show them as instruments of Cole Jenest & Stone, P.A. The reproduction or unauthorized use of the documents without consent of Cole Jenest & Stone, P.A. is prohibited.

Cole Jenest & Stone, P.A. © 2007

ORIGINAL

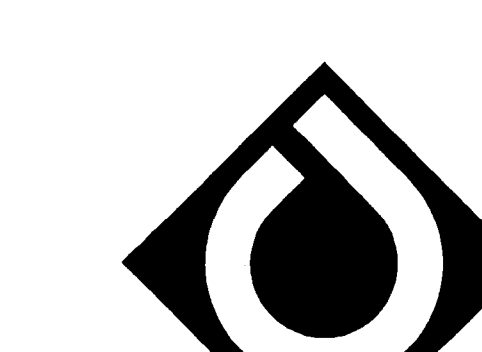

Cole Jenest & Stone

Site Planning, Landscape Architecture, Civil Engineering, Urban Design

300 South Tryon Street, Suite 1400 Charlotte, NC 28202

POPE & LAND ENTERPRISES, INC

CITY PARK

CHARLOTTE, NORTH CAROLINA

DEVELOPMENT NOTES For Public Hearing Petition # 2007-082

Project No. 3592 Issued 03.26.07

Revised 09/14/07, 10/25/07, 11/16/07, 12/14/07, 02/26/08, 03/12/09 STORMWATER NOTE AMENDMENT

ATTACHED TO ADMINISTRATIVE APPROVAL

DATED March 25, 2007 BY: DEBRA D. CAMPBELL

RZ2.0

The drawings, the project manual and the design show them as instruments of Cole Jenest & Stone, P.A. The reproduction or unauthorized use of the documents without consent of Cole Jenest & Stone, P.A. is prohibited.

Cole Jenest & Stone, P.A. © 2007

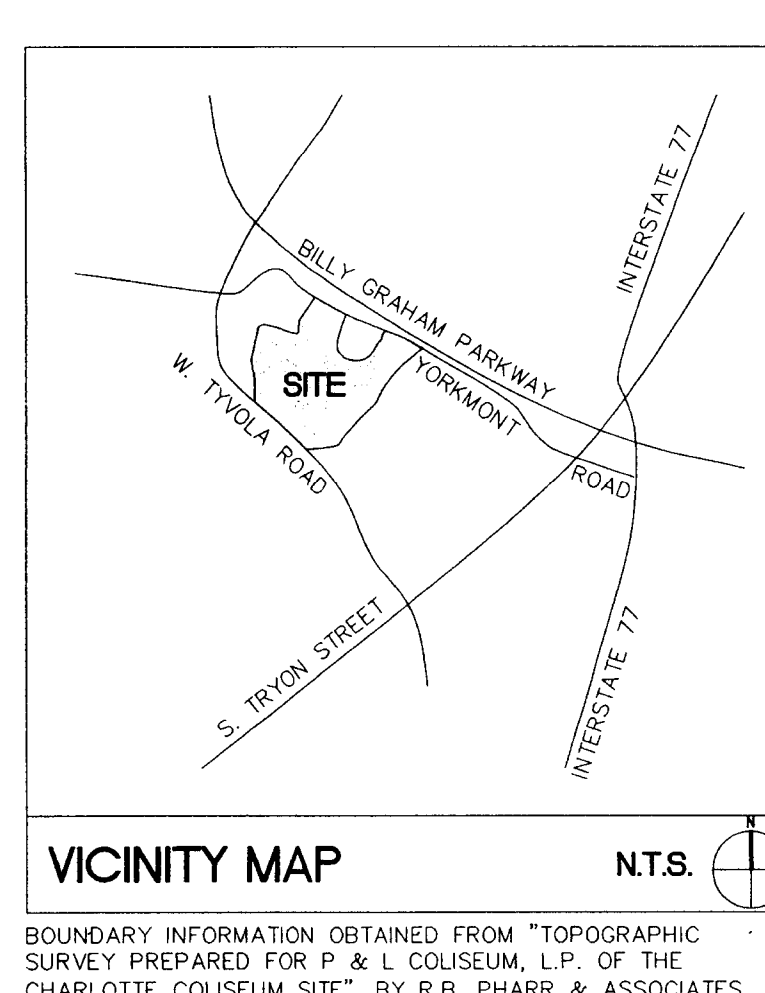
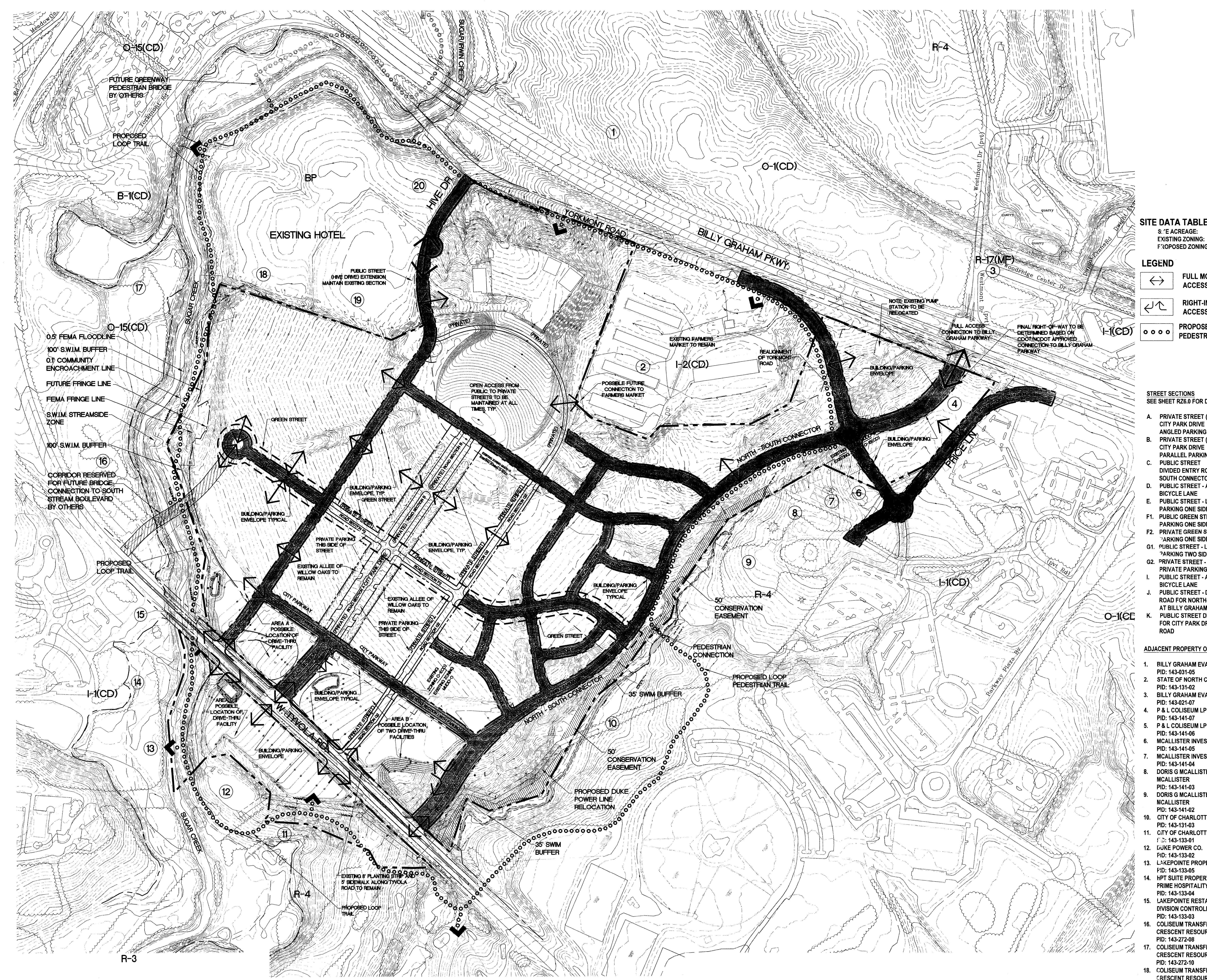

SITE DATA TABLE: S/E ACRES: 170.2887 AC, EXISTING ZONING: MUDO-O-1(CD)-O-15(CD), R-4, FUTURE ZONING: MUDO-O

LEGEND: FULL MOVEMENT ACCESS POINT, RIGHT-IN, RIGHT-OUT ACCESS POINT, PROPOSED PEDESTRIAN TRAIL, PROPOSED RIGHT OF WAY, PROPERTY LINE, 50' CONSERVATION EASEMENT, PUBLIC STREET

STREET SECTIONS: A. PRIVATE STREET (MAIN STREET) CITY PARK DRIVE, B. PRIVATE STREET (MAIN STREET) PABBLE STREET, C. PUBLIC STREET DIVIDED ENTRY ROAD FOR NORTH-SOUTH CONNECTOR AT TYOLA ROAD, D. PUBLIC STREET - AVENUE WITH PUBLIC GREEN STREET - PUBLIC PARKING ONE SIDE, E. PUBLIC STREET - LOCAL STREET - PARKING ONE SIDE, F. PRIVATE GREEN STREET - PRIVATE PARKING TWO SIDES, G. PUBLIC STREET - LOCAL STREET - PARKING TWO SIDES, H. PUBLIC STREET - AVENUE WITHOUT BICYCLE LANE, I. PUBLIC STREET - DIVIDED ENTRY ROAD FOR NORTH-SOUTH CONNECTOR AT BILLY GRAHAM PARKWAY, K. PUBLIC STREET DIVIDED ENTRY ROAD FOR CITY PARK DRIVE AT TYOLA ROAD

ADJACENT PROPERTY OWNERS: 1. BILLY GRAHAM EVANGELISTIC ASSOC. PID: 143-931-05, 2. STATE OF NORTH CAROLINA PID: 143-133-02, 3. BILLY GRAHAM EVANGELISTIC ASSOC. PID: 143-133-02, 4. P & L COLISEUM LP PID: 143-141-07, 5. P & L COLISEUM LP PID: 143-141-06, 6. MALLISTER INVESTMENT PROP. #5 PID: 143-141-04, 7. MALLISTER INVESTMENT PROP. #5 PID: 143-141-04, 8. DONIS G MALLISTER AND R J MALLISTER PID: 143-141-03, 9. DONIS G MALLISTER AND R J MALLISTER PID: 143-141-02, 10. CITY OF CHARLOTTE PID: 143-141-01, 11. CITY OF CHARLOTTE PID: 143-133-02, 12. LAKEPONTE PROPERTY OWNERS PID: 143-133-01, 13. HPT SUTE PROPERTIES TRUST AND PUBLISHERS CITY CORP. PID: 143-133-01, 14. LAKEPONTE RESTAURANT AND DIVISION CONTROLLER PID: 143-133-03, 15. COLISEUM TRANSFER INC AND CRESCENT RESOURCES LLC PID: 143-272-08, 16. COLISEUM TRANSFER INC AND CRESCENT RESOURCES LLC PID: 143-272-09, 17. COLISEUM TRANSFER INC AND CRESCENT RESOURCES LLC PID: 143-272-10, 18. COLISEUM TRANSFER INC AND CRESCENT RESOURCES LLC PID: 143-272-11, 19. TRUM FINANCE L.P. PID: 143-272-12, 20. COLISEUM TRANSFER INC AND CRESCENT RESOURCES LLC PID: 143-272-14

1. GENERAL PROVISIONS: THESE DEVELOPMENT STANDARDS FORM A PART OF THE TECHNICAL DATA SHEET (SHEET #1) ASSOCIATED WITH THE REZONING PETITION... 2. REQUIREMENTS FOR REMEDIATION PLAN PART FEE: THERE IS CURRENTLY IN PLACE IN FRONT OF THE CHARLOTTE COLISEUM A PLAN FOR PUBLIC ART... 3. PERMITTED USES: EXCEPT AS OTHERWISE PROVIDED IN THE TEXT... 4. MAXIMUM DEVELOPMENT: THE MAXIMUM AREA/MAJOR USE DEVELOPMENT WHICH MAY TAKE PLACE ON THE SITE SHALL BE AS FOLLOWS: COMMERCIAL: 100,000 SQUARE FEET OF RETAIL DEVELOPMENT... 5. MINIMUM ROADWAY IMPROVEMENTS: FOR PHASE ONE DEVELOPMENT... 6. STORMWATER DETENTION AND QUALITY PROTECTION MEASURES: 6.1 SWIM BUFFERS SHALL BE PROVIDED AS REQUIRED BY THE ORDINANCE... 6.2 ATTACHED SUPPLEMENTAL DRAINAGE BASIN EXHIBIT D218/208... 6.3 MINOR ROADWAY IMPROVEMENTS FOR PHASE TWO DEVELOPMENT... 6.4 MINOR ROADWAY IMPROVEMENTS FOR PHASE THREE DEVELOPMENT... 7. PHASING: THE PHASING OF THE DEVELOPMENT SHALL BE AS FOLLOWS: PHASE ONE: CONSTRUCTION OF THE NORTH/SOUTH CONNECTOR ROAD... PHASE TWO: CONSTRUCTION OF THE EAST/WEST CONNECTOR ROAD... PHASE THREE: CONSTRUCTION OF THE BILLY GRAHAM PARKWAY... 8. CONNECIVITY: PEDESTRIAN AND VEHICULAR CONNECTIVITY WILL BE ENHANCED BY THE PROPOSED LOOP AT CITY PARK...

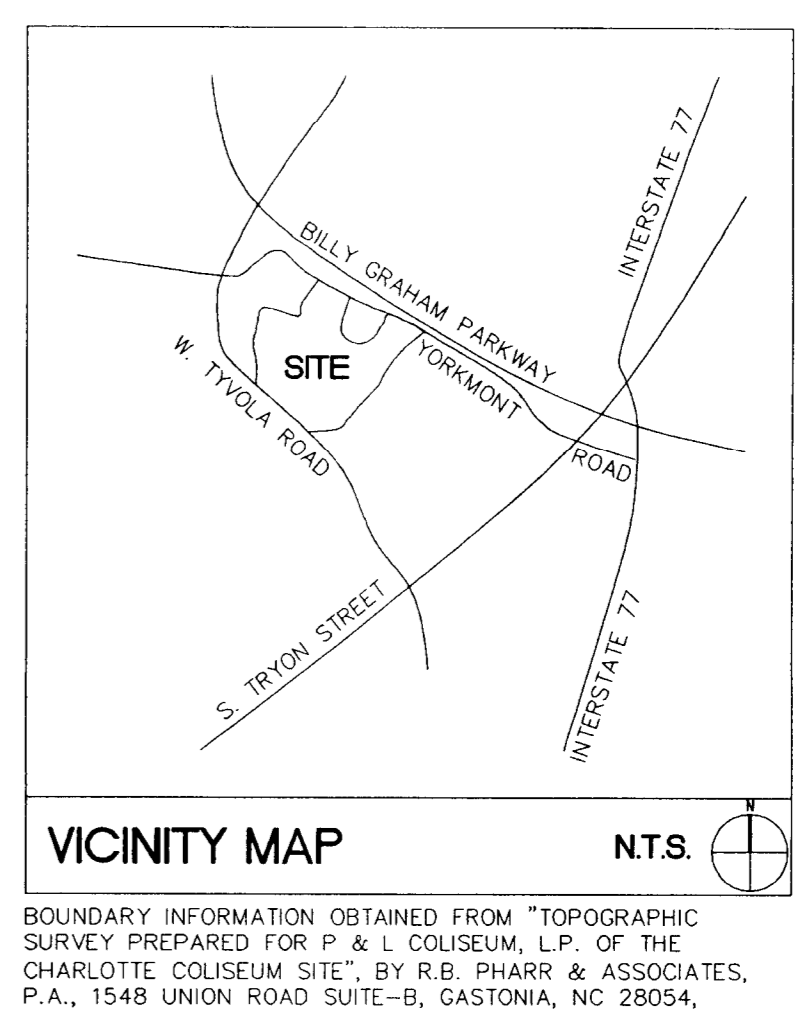
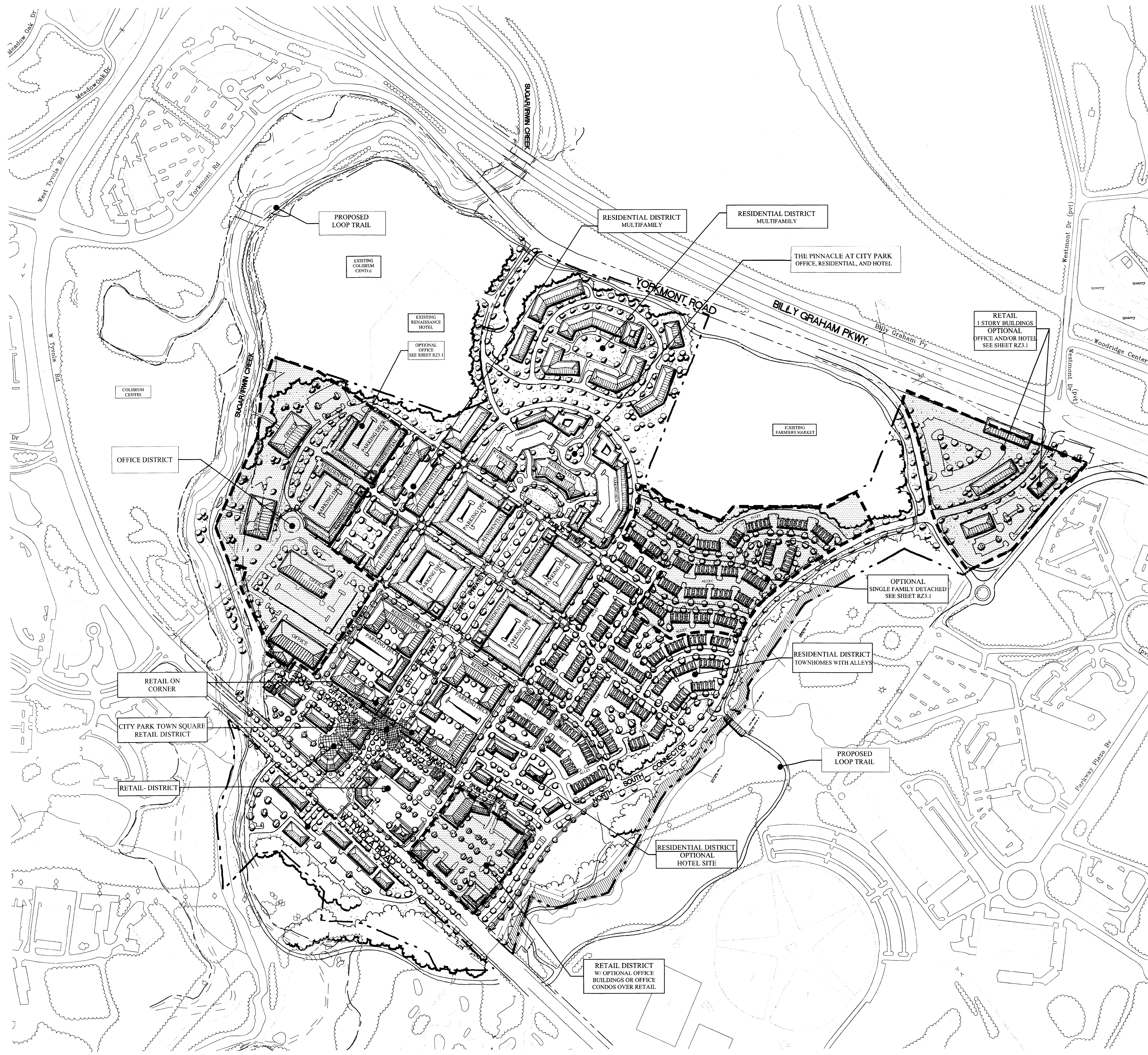

Cole Jenest & Stone
 Shaping the Environment
 Restoring the Possibilities

Land Planning
 Landscape Architecture
 Civil Engineering
 Urban Design

890 South Tryon Street, Suite 1400, Charlotte, NC 28202
 or PO Box 1855 • Tel: 270.781.1911 • www.colejenest.com

POPE & LAND ENTERPRISES, INC
 CUMBERLAND CENTER IV
 3225 CUMBERLAND BLVD, SUITE 400
 ATLANTA, GEORGIA 30339

CITY PARK

CHARLOTTE, NORTH CAROLINA

CONCEPTUAL SITE PLAN
 For Public Hearing
 Petition # 2007-082

Project No.
 3592

Issued
 03/26/07

Revised
 09/14/07
 11/16/07
 12/14/07

ATTACHED TO ADMINISTRATIVE
 FILE # 2007-082

DATED: March 25, 2007 **BY:** DEBRA D. CAMPBELL

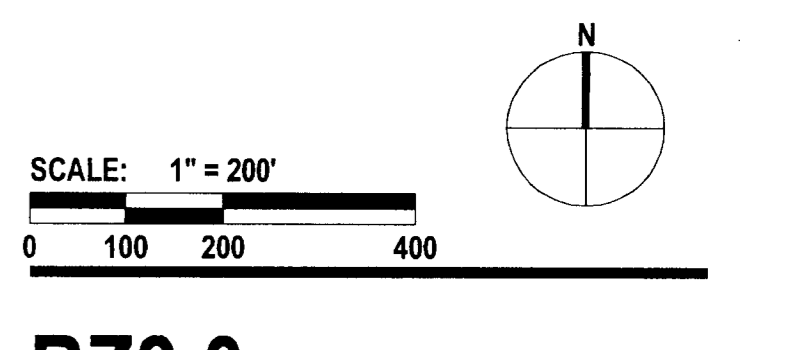

RZ3.0

The drawings, the project manual and the design shown herein are instruments of Cole Jenest & Stone, P.A. The reproduction or unauthorized use of the documents without consent of Cole Jenest & Stone, P.A. is prohibited.

Cole Jenest & Stone, P.A. 2007 ©

ORIGINAL

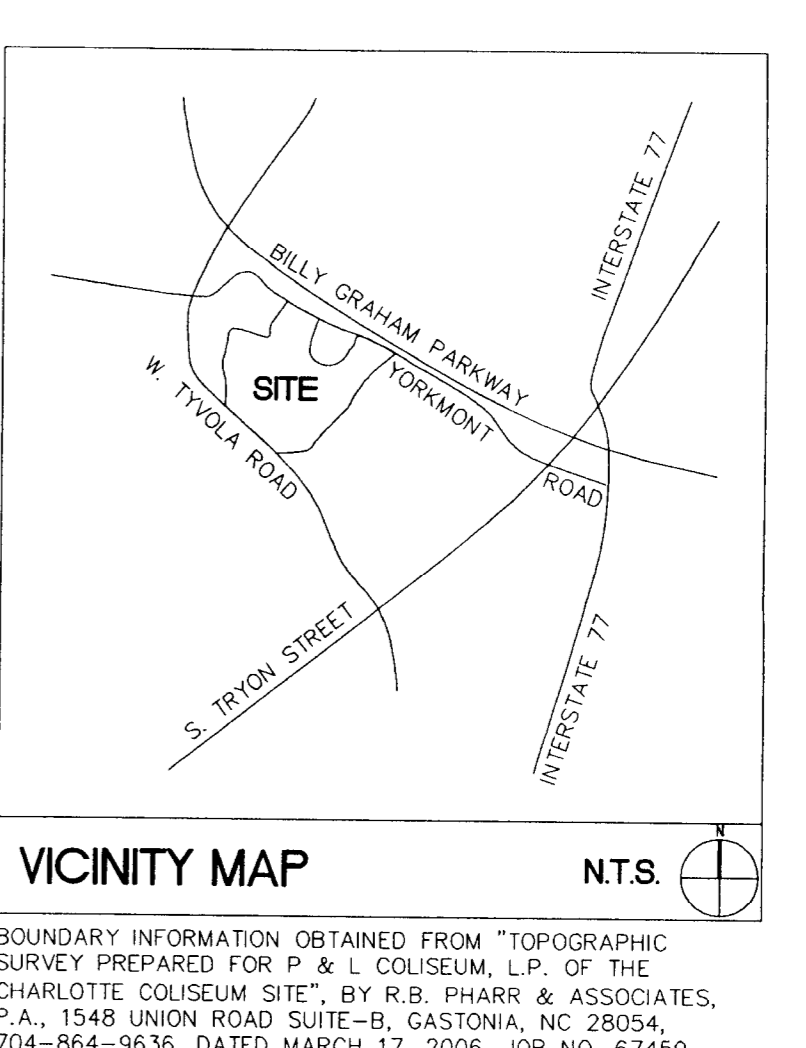
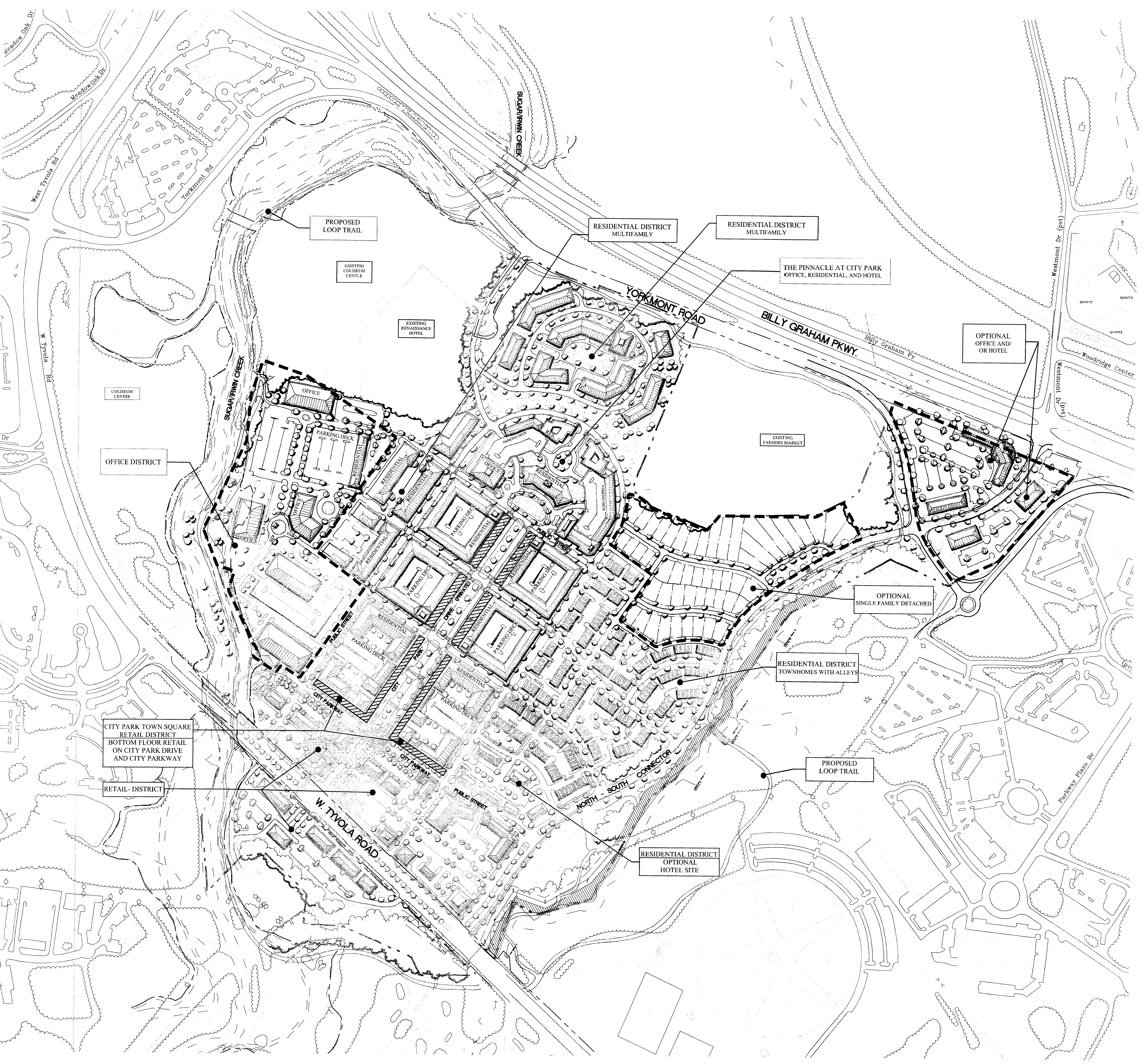

Cole Jenest & Stone
 Shaping the Environment
 Restoring the Possibilities

Land Planning
 Landscape Architecture
 Civil Engineering
 Urban Design

890 South Tryon Street, Suite 1400, Charlotte, NC 28202
 or PO Box 1855 • Tel: 270.781.1911 • www.colejenest.com

POPE & LAND ENTERPRISES, INC
 CUMBERLAND CENTER IV
 3225 CUMBERLAND BLVD, SUITE 400
 ATLANTA, GEORGIA 30339

CITY PARK

CHARLOTTE, NORTH CAROLINA

CONCEPTUAL SITE PLAN ALTERNATE
 For Public Hearing
 Petition # 2007-082

Project No.
 3592

Issued
 03/26/07

Revised
 09/14/07
 11/16/07
 12/14/07

ATTACHED TO ADMINISTRATIVE
 FILE # 2007-082

DATED: March 25, 2007 **BY:** DEBRA D. CAMPBELL

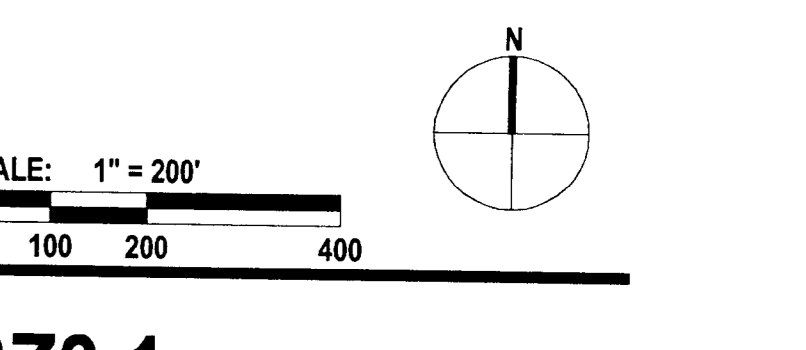

RZ3.1

The drawings, the project manual and the design shown herein are instruments of Cole Jenest & Stone, P.A. The reproduction or unauthorized use of the documents without consent of Cole Jenest & Stone, P.A. is prohibited.

Cole Jenest & Stone, P.A. 2007 ©

ORIGINAL

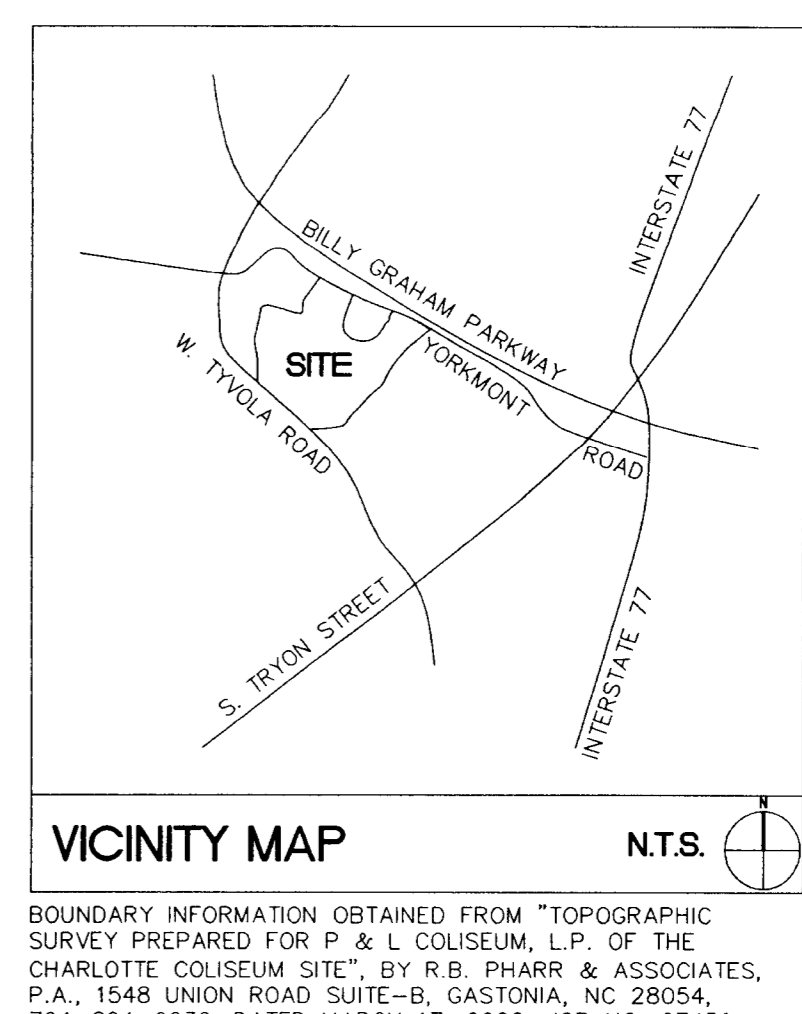

SITE DATA TABLE:

EXISTING ZONING:	MUDD-O, O-1(CD), O-15(CD), R-4
PROPOSED ZONING:	MUDD-O
SITE ACREAGE:	170.287 AC
EXISTING WOODED AREA:	74.8 AC
PROPOSED TREE SAVE AREA:	124 AC
TREE SAVE AREA % OF TOTAL PROPERTY AREA:	7.28%

LEGEND

PROPOSED PHASE I DEVELOPMENT AREA	PROPERTY LINE
EXISTING WOODED AREA	PROPOSED TREE SAVE AREA
PROPOSED SIDEWALK	EXISTING BIKE TRAIL
PROPOSED PEDESTRIAN LOOP "THE LOOP"	FUTURE PEDESTRIAN TRAIL DESIGNED BY OTHERS

ColeJenest & Stone
Shaping the Environment
Rebuilding the Foundation

Land Planning
Landscape Architecture
Civil Engineering
Urban Design

200 South Tryon Street, Suite 1400 Charlotte, NC 28202
Tel: 704.333.1100 • Fax: 704.333.1101 • www.colejenest.com

POPE & LAND ENTERPRISES, INC
CUMBERLAND CENTER IV
3225 CUMBERLAND BLVD, SUITE 400
ATLANTA, GEORGIA 30339

CITY PARK

CHARLOTTE, NORTH CAROLINA

SUPPLEMENTAL DATA SHEET For Public Hearing Petition # 2007-082

Project No. 3592
Issued 03/26/07

Revised 09/14/07
11/16/07
12/14/07

ATTACHED TO ADMINISTRATIVE APPROVAL
DATED: March 25, 2007
BY: DEBRA D. CAMPBELL

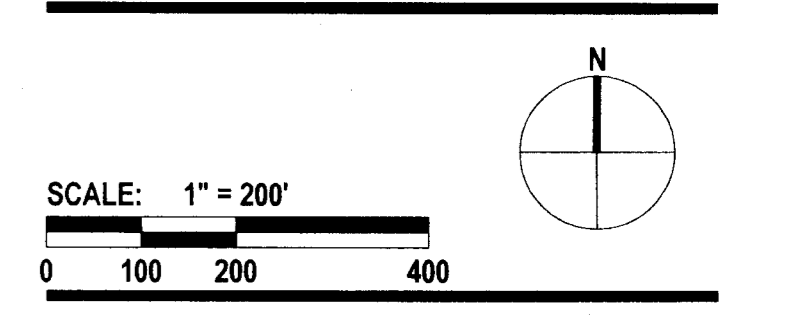

RZ4.0

The drawings, the project manual and the design shown herein are instruments of ColeJenest & Stone, P.A. The reproduction or unauthorized use of the documents without consent of ColeJenest & Stone, P.A. is prohibited.

ORIGINAL

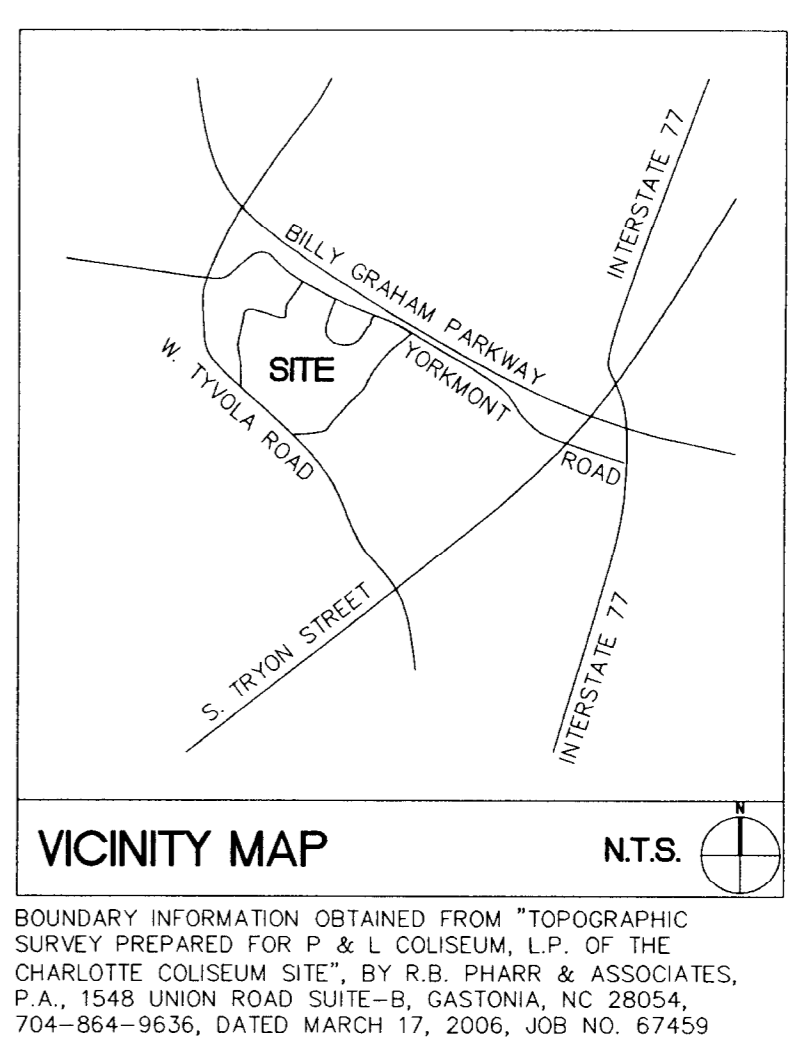
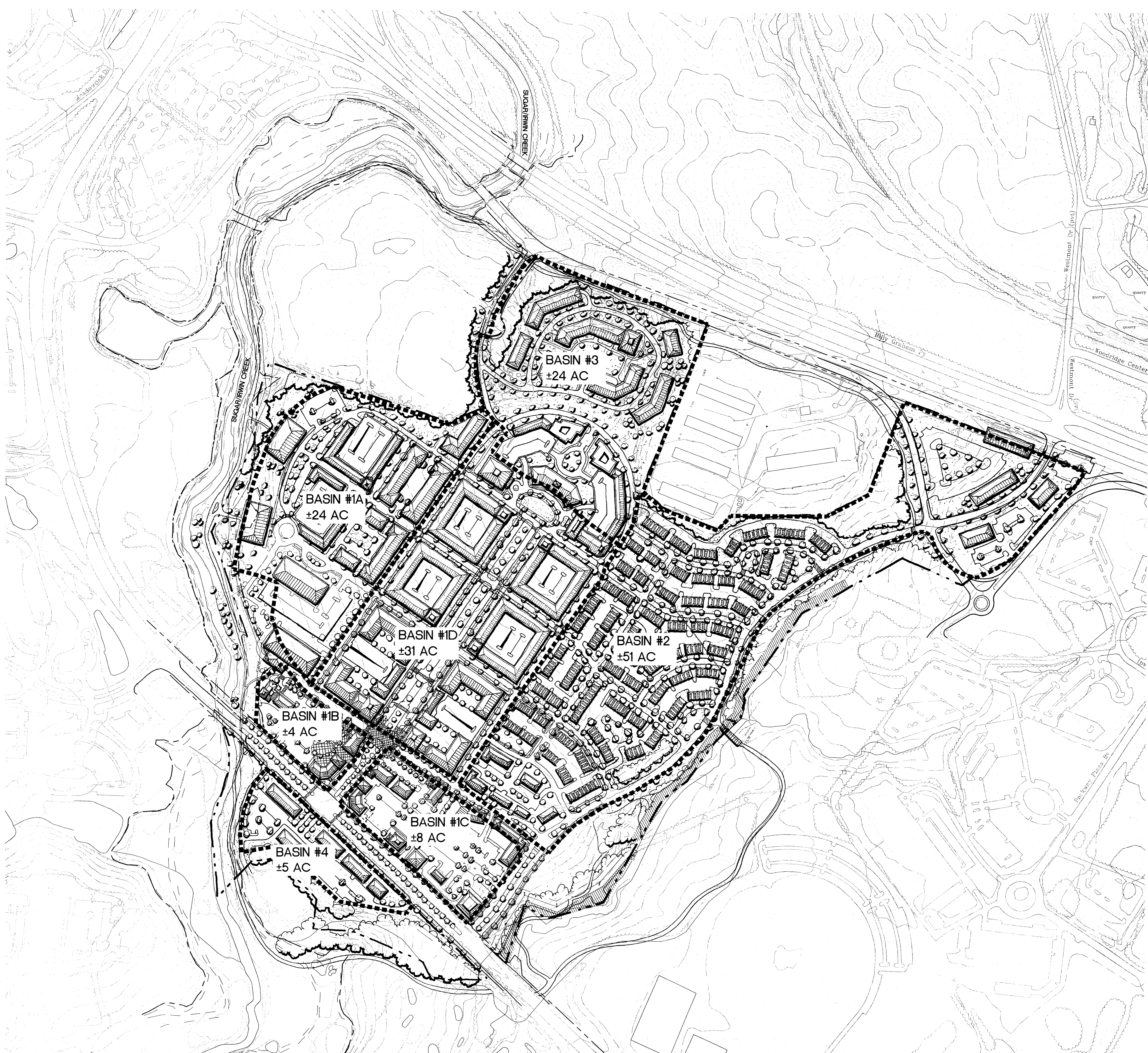

SITE DATA TABLE:

EXISTING ZONING:	MUDD-O, O-1(CD), O-15(CD), R-4
PROPOSED ZONING:	MUDD-O
SITE ACREAGE:	170.287 AC
EXISTING WOODED AREA:	74.8 AC
PROPOSED TREE SAVE AREA:	124 AC
TREE SAVE AREA % OF TOTAL PROPERTY AREA:	7.28%

LEGEND

PROPOSED PHASE I DEVELOPMENT AREA	PROPERTY LINE
EXISTING WOODED AREA	PROPOSED TREE SAVE AREA
PROPOSED SIDEWALK	EXISTING BIKE TRAIL
PROPOSED PEDESTRIAN LOOP "THE LOOP"	FUTURE PEDESTRIAN TRAIL DESIGNED BY OTHERS

ColeJenest & Stone
Shaping the Environment
Rebuilding the Foundation

Land Planning
Landscape Architecture
Civil Engineering
Urban Design

200 South Tryon Street, Suite 1400 Charlotte, NC 28202
Tel: 704.333.1100 • Fax: 704.333.1101 • www.colejenest.com

POPE & LAND ENTERPRISES, INC
CUMBERLAND CENTER IV
3225 CUMBERLAND BLVD, SUITE 400
ATLANTA, GEORGIA 30339

CITY PARK

CHARLOTTE, NORTH CAROLINA

SUPPLEMENTAL DATA SHEET For Public Hearing Petition # 2007-082

Project No. 3592
Issued 03/26/07

Revised 09/14/07
11/16/07
12/14/07

ATTACHED TO ADMINISTRATIVE APPROVAL
DATED: March 25, 2007
BY: DEBRA D. CAMPBELL

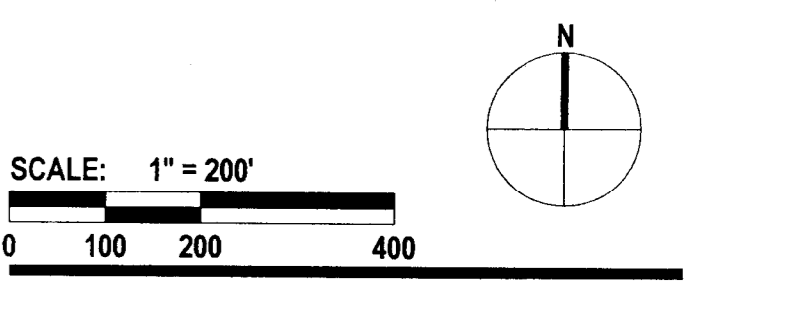

RZ5.0

The drawings, the project manual and the design shown herein are instruments of ColeJenest & Stone, P.A. The reproduction or unauthorized use of the documents without consent of ColeJenest & Stone, P.A. is prohibited.

ORIGINAL

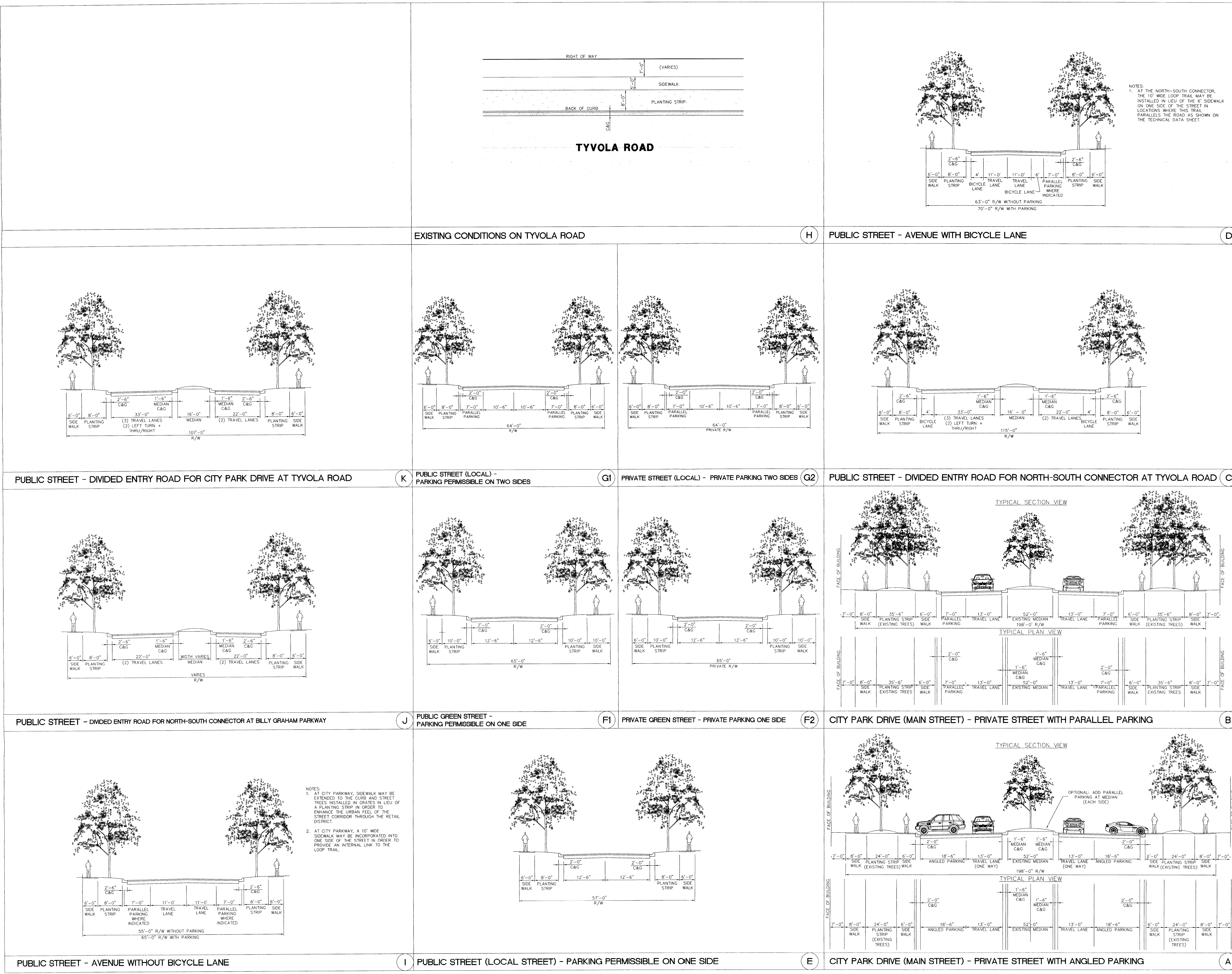

POPE & LAND

CITY PARK

WARFIELD BLANKINSHIP & ASSOCIATES