

P:\2014 Jobs\14008 - City Park Townhomes\CAD\Re zoning\14008 - RZ-BASE.dwg

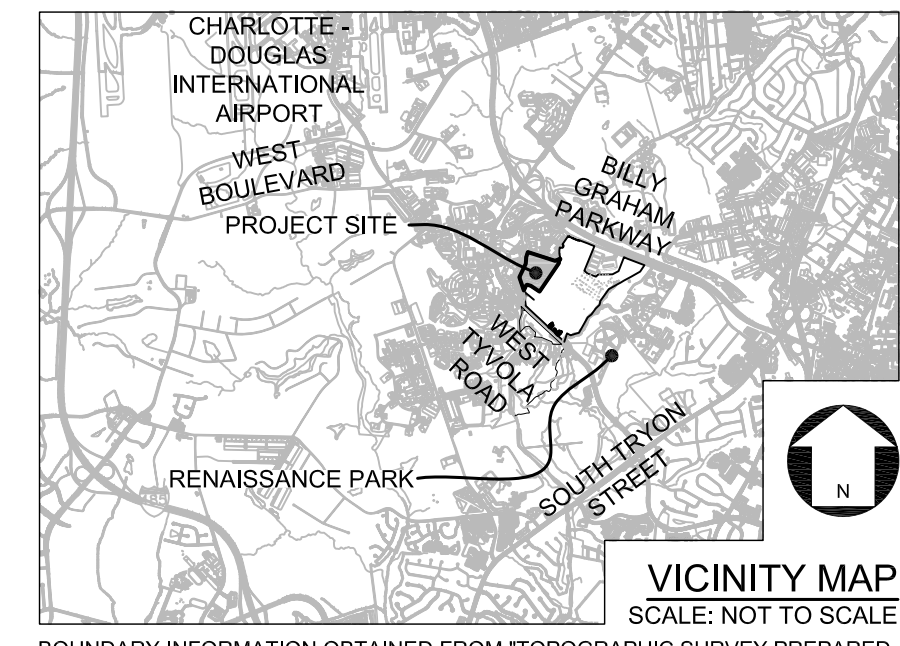
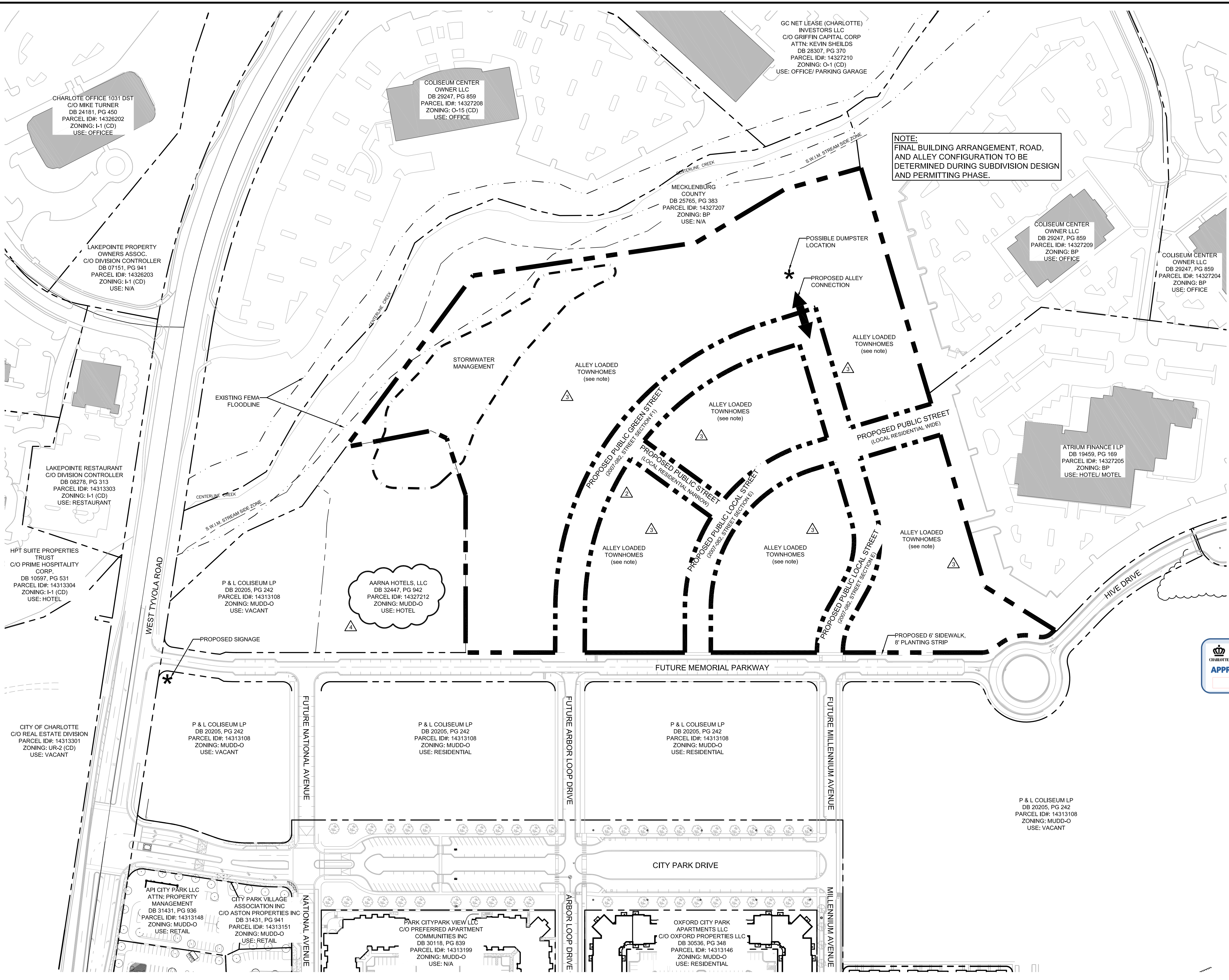

DEVELOPMENT DATA

TAX PARCEL ID:	14313108 (PARTIAL)
ACREAGE:	± 23.38 AC (1,018,363 SF)
EXISTING ZONING:	MUDD-O
EXISTING USE:	COMMERCIAL
PROPOSED ZONING:	MUDD-O (SPA)
PROPOSED USE:	SINGLE-FAMILY ATTACHED TOWNHOMES
PROPOSED UNITS:	UP TO 260 TOWNHOMES
PROPOSED DENSITY:	±11.12 UNITS/ AC MAX.
WASTE MANAGEMENT:	ROLLOUT CONTAINERS - SERVICE TO BE PROVIDED BY HOA

MAXIMUM TOWNHOMES / SINGLE FAMILY BUILDING HEIGHT: 60' MAXIMUM (WITHIN THE REZONING AREA DEPICTED ON THE REZONING PLAN)

GENERAL NOTES

ALLEY-LOADED TOWNHOMES MAY BE REPLACED WITH ALLEY-LOADED OR FRONT-LOADED SINGLE FAMILY DETACHED HOMES WITHIN THE PARAMETERS OF THE REZONING PLAN



This Plan Is A Preliminary Design. NOT Released For Construction.

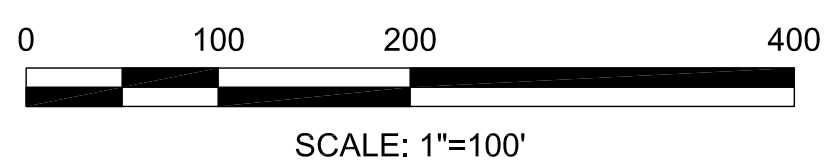

REVISIONS:

No.	Date	By	Description
1	02/12/18	DRW	PER REVIEW COMMENTS
2	03/19/18	SDW	PER REVIEW COMMENTS
3	06/25/18	SDW	PER REVIEW COMMENTS
4	09/21/18	SDW	PER REVIEW / DISCUSSION COMMENTS

CITY PARK TOWNHOMES
CHARLOTTE, NC
2250 WEST TYVOLA ROAD
CHARLOTTE, NC 28217

REZONING SITE PLAN

PETITION: 2017-205

CORPORATE CERTIFICATIONS
NC PE - C-2930 NC LA - C-293
SC ENG - NO. 3599 SC LA - NO. 211

Project Manager: MDL

Drawn By: DRW

Checked By: MDL

Date: 12/18/17

Project Number: 14008

Sheet Number:

RZ1.0

