

**URBAN
DESIGN
PARTNERS**

1318-e6 central ave. p 704.334.3303
charlotte, nc 28205 f 704.334.3305
urbanpartners.com
nc firm no: P-0418
sc cda no: C-03044

DEVELOPMENT DATA TABLE:

SITE AREA: +/- 0.33 ACRES
TAX PARCELS: 079-015-04 AND 079-015-05
EXISTING ZONING: I-2
PROPOSED ZONING: UR-2(CD)
EXISTING USE: RESIDENTIAL
PROPOSED USES: UP TO TWENTY ONE (21) MULTIFAMILY DWELLING UNITS
MAXIMUM BUILDING HEIGHT: THREE (3) STORIES, 45 FEET

I. GENERAL PROVISIONS

- THESE DEVELOPMENT STANDARDS FORM A PART OF THE REZONING PLAN ASSOCIATED WITH THE REZONING PETITION FILED BY MISSION PROPERTIES (THE "PETITIONER") TO ACCOMMODATE THE DEVELOPMENT OF A MULTI-FAMILY RESIDENTIAL COMMUNITY ON THAT APPROXIMATELY 0.33-ACRE SITE LOCATED AT THE SOUTHWEST INTERSECTION OF SYLVANIA AVENUE AND DUNLOE STREET, AS MORE PARTICULARLY DEPICTED ON THE REZONING PLAN (THE "SITE"). THE SITE IS COMPRISED OF TAX PARCEL NUMBERS 079-015-04 AND 079-015-05.
- DEVELOPMENT OF THE SITE WILL BE GOVERNED BY THE REZONING PLAN, THESE DEVELOPMENT STANDARDS AND THE APPLICABLE PROVISIONS OF THE CITY OF CHARLOTTE ZONING ORDINANCE (THE "ORDINANCE").
- UNLESS THE REZONING PLAN OR THESE DEVELOPMENT STANDARDS ESTABLISH MORE STRINGENT STANDARDS, THE REGULATIONS ESTABLISHED UNDER THE ORDINANCE FOR THE UR-2 ZONING DISTRICT SHALL GOVERN THE DEVELOPMENT AND USE OF THE SITE.
- THE DEVELOPMENT AND LAYOUT DEPICTED ON THE REZONING PLAN ARE SCHEMATIC IN NATURE AND ARE INTENDED TO DEPICT THE GENERAL ARRANGEMENT OF SUCH USES AND IMPROVEMENTS ON THE SITE. ACCORDINGLY, THE ULTIMATE LAYOUT, LOCATIONS AND SIZES OF THE DEVELOPMENT AND SITE ELEMENTS DEPICTED ON THE REZONING PLAN ARE GRAPHIC REPRESENTATIONS OF THE PROPOSED DEVELOPMENT AND SITE ELEMENTS, AND THEY MAY BE ALTERED OR MODIFIED IN ACCORDANCE WITH THE SETBACK, YARD, LANDSCAPING AND TREE SAVE REQUIREMENTS SET FORTH ON THIS REZONING PLAN AND THE DEVELOPMENT STANDARDS, PROVIDED, HOWEVER, THAT ANY SUCH ALTERATIONS AND MODIFICATIONS SHALL BE MINOR IN NATURE AND NOT MATERIALLY CHANGE THE OVERALL DESIGN INTENT DEPICTED ON THE REZONING PLAN.
- FUTURE AMENDMENTS TO THE REZONING PLAN AND/OR THESE DEVELOPMENT STANDARDS MAY BE APPLIED FOR BY THE THEN OWNER(S) OF THE SITE IN ACCORDANCE WITH THE PROVISIONS OF CHAPTER 6 OF THE ORDINANCE. MINOR ALTERATIONS TO THE REZONING PLAN ARE SUBJECT TO SECTION 6.207 OF THE ORDINANCE.

II. PERMITTED USES

THE SITE MAY BE DEVOTED ONLY TO A RESIDENTIAL COMMUNITY CONTAINING A MAXIMUM OF TWENTY ONE (21) MULTI-FAMILY DWELLING UNITS AND ANY INCIDENTAL AND ACCESSORY USES RELATING THERETO THAT ARE PERMITTED BY-RIGHT OR UNDER PRESCRIBED CONDITIONS IN THE UR-2 ZONING DISTRICT.

III. TRANSPORTATION

- SITE ACCESS SHALL BE AS GENERALLY DEPICTED ON THE REZONING PLAN, AND MINOR ADJUSTMENTS TO THE LOCATION OF THE ACCESS POINT(S) SHALL BE ALLOWED DURING THE CONSTRUCTION PERMITTING PROCESS.
- THE PETITIONER SHALL CONSTRUCT TWO (2) PROWAG STANDARD ACCESSIBLE RAMPS AT THE DUNLOE STREET AND SYLVANIA AVENUE INTERSECTION LOCATION, AS GENERALLY DEPICTED ON THE REZONING PLAN.
- THE PETITIONER SHALL DEDICATE ALL NECESSARY RIGHTS-OF-WAY IN FEE SIMPLE CONVEYANCE TO THE CITY OF CHARLOTTE BEFORE THE SITE'S FIRST BUILDING CERTIFICATE OF OCCUPANCY IS ISSUED.
- UNLESS STATED OTHERWISE HEREIN, THE PETITIONER SHALL ENSURE THAT ALL TRANSPORTATION IMPROVEMENTS ARE SUBSTANTIALLY COMPLETED PRIOR TO THE ISSUANCE OF THE SITE'S FIRST BUILDING CERTIFICATE OF OCCUPANCY.

IV. ARCHITECTURAL STANDARDS

- PREFERRED EXTERIOR BUILDING MATERIALS: ALL PRINCIPAL AND ACCESSORY STRUCTURES SHALL BE COMPRISED OF EITHER OR A COMBINATION OF BRICK, NATURAL STONE (OR ITS SYNTHETIC EQUIVALENT), STUCCO, CEMENTITIOUS SIDING, FIBER CEMENT ("HARDIPLANK") AND/OR OTHER MATERIALS APPROVED BY THE PLANNING DIRECTOR SUCH AS WOOD SHUTTERS AND ARCHITECTURAL BRACKETS.
- PROHIBITED EXTERIOR BUILDING MATERIALS: (I) VINYL SIDING (EXCLUDING: (A) VINYL HAND RAILS, (B) VINYL WINDOWS, (C) VINYL SOFFITS, DOORS OR DOOR TRIM), AND (II) CONCRETE MASONRY UNITS NOT ARCHITECTURALLY FINISHED.
- BUILDING ELEVATIONS SHALL BE DESIGNED WITH VERTICAL BAYS OR ARTICULATED ARCHITECTURAL FAÇADE FEATURES WHICH SHALL INCLUDE A MINIMUM OF THREE (3) OF THE FOLLOWING: (A) A COMBINATION OF EXTERIOR WALL MATERIALS, (B) EXTERIOR WALL OFFSETS (PROJECTIONS OR RECESSES), (C) DORMERS, (D) BAY WINDOWS, (E) ARCHITECTURAL FEATURES SUCH AS MEDALLIONS, BRACKETS AND SHUTTERS, (F) COLUMNS, (G) PILASTERS, (H) BANDING, OR (I) CHANGE IN COLORS.
- BUILDINGS SHALL BE DESIGNED WITH A RECOGNIZABLE ARCHITECTURAL BASE ON ALL FAÇADES FACING DUNLOE STREET AND SYLVANIA AVENUE. SUCH BASES MAY BE EXECUTED THROUGH THE USE OF PREFERRED EXTERIOR BUILDING MATERIALS OR ARTICULATED ARCHITECTURAL FAÇADE FEATURES AND COLOR CHANGES.
- BUILDING ELEVATIONS FACING DUNLOE STREET AND SYLVANIA AVENUE SHALL NOT HAVE BLANK WALLS GREATER THAN TWENTY (20) FEET IN ALL DIRECTIONS AND SHALL HAVE ARCHITECTURAL FEATURES SUCH AS, BUT NOT LIMITED TO, BANDING, MEDALLIONS, BRACKETS, SHUTTERS, OR DESIGN FEATURES OR MATERIALS TO AVOID A STERILE, UNARTICULATED BLANK TREATMENT OF SUCH WALLS.
- BUILDING MASSING SHALL BE DESIGNED TO BREAK UP LONG MONOLITHIC BUILDING FORMS AS FOLLOWS: BUILDING EXCEEDING 125 FEET IN LENGTH SHALL INCLUDE MODULATIONS OF THE BUILDING MASSING/FAÇADE PLANE (SUCH AS RECESSES, PROJECTIONS, AND ARCHITECTURAL DETAILS). MODULATIONS SHALL BE A MINIMUM OF TEN (10) FEET WIDE AND SHALL PROJECT OR RECESS A MINIMUM OF TWO (2) FEET EXTENDING THROUGH AT LEAST A FULL FLOOR.
- ROOF FORM AND ARTICULATION - ROOF FORM AND LINES SHALL BE DESIGNED TO AVOID THE APPEARANCE OF A LARGE MONOLITHIC ROOF STRUCTURE AS FOLLOWS:
 - LONG PITCHED OR FLAT ROOF LINES SHALL AVOID CONTINUOUS EXPANSES WITHOUT VARIATION BY INCLUDING CHANGES IN HEIGHT AND/OR ROOF FORM TO INCLUDE BUT NOT BE LIMITED TO GABLES, HIPs, SHED ROOFS, DORMERS OR PARAPETS.
 - ROOFTOP HVAC AND RELATED MECHANICAL EQUIPMENT WILL BE SCREENED FROM PUBLIC VIEW AT GRADE FROM THE EXISTING PUBLIC STREET.

V. ENVIRONMENTAL FEATURES

- THE PETITIONER SHALL COMPLY WITH THE CHARLOTTE CITY COUNCIL APPROVED AND ADOPTED POST CONSTRUCTION STORMWATER ORDINANCE. THE LOCATION, SIZE, AND TYPE OF STORMWATER MANAGEMENT SYSTEMS DEPICTED ON THE REZONING PLAN ARE SUBJECT TO REVIEW AND APPROVAL AS PART OF THE FULL DEVELOPMENT PLAN SUBMITTAL AND ARE NOT IMPLICITLY APPROVED WITH THIS REZONING. ADJUSTMENTS MAY BE NECESSARY IN ORDER TO ACCOMMODATE ACTUAL STORM WATER TREATMENT REQUIREMENTS AND NATURAL SITE DISCHARGE POINTS.
- THE PETITIONER SHALL COMPLY WITH THE TREE ORDINANCE.

VI. LIGHTING

ALL FREESTANDING LIGHTING FIXTURES INSTALLED ON THE SITE GREATER THAN TWENTY ONE (21) FEET IN TOTAL HEIGHT (I.E., EXCLUDING DECORATIVE LIGHTING LESS THAN 21' IN HEIGHT THAT MAY BE INSTALLED ALONG THE DRIVEWAYS AND SIDEWALKS AS PEDESTRIAN/LANDSCAPING LIGHTING) SHALL BE FULLY CAPPED AND SHIELDED AND THE ILLUMINATION DOWNWARDLY DIRECTED SO THAT DIRECT ILLUMINATION DOES NOT EXTEND PAST ANY PROPERTY LINE OF THE SITE.

VII. AMENDMENTS TO REZONING PLAN

FUTURE AMENDMENTS TO THE REZONING PLAN AND THESE DEVELOPMENT STANDARDS MAY BE APPLIED FOR BY THE THEN OWNER OR OWNERS OF A PARTICULAR TRACT WITHIN THE SITE INVOLVED IN ACCORDANCE WITH THE PROVISIONS OF CHAPTER 6 OF THE ORDINANCE.

VIII. BINDING EFFECT OF THE REZONING DOCUMENTS AND DEFINITIONS

IF THIS REZONING PETITION IS APPROVED, ALL CONDITIONS APPLICABLE TO DEVELOPMENT OF THE SITE IMPOSED UNDER THE REZONING PLAN AND THESE DEVELOPMENT STANDARDS WILL, UNLESS AMENDED IN THE MANNER PROVIDED UNDER THE ORDINANCE, BE BINDING UPON AND INURE TO THE BENEFIT OF THE PETITIONER AND SUBSEQUENT OWNERS OF THE SITE AND THEIR RESPECTIVE SUCCESSORS IN INTEREST AND ASSIGNS.

THROUGHOUT THESE DEVELOPMENT STANDARDS, THE TERMS, "PETITIONER" AND "OWNER" OR "OWNERS" SHALL BE DEEMED TO INCLUDE THE HEIRS, DEVISEES, PERSONAL REPRESENTATIVES, SUCCESSORS IN INTEREST AND ASSIGNS OF THE PETITIONER OR THE OWNER OR OWNERS OF ANY PART OF THE SITE FROM TIME TO TIME WHO MAY BE INVOLVED IN ANY FUTURE DEVELOPMENT THEREOF.

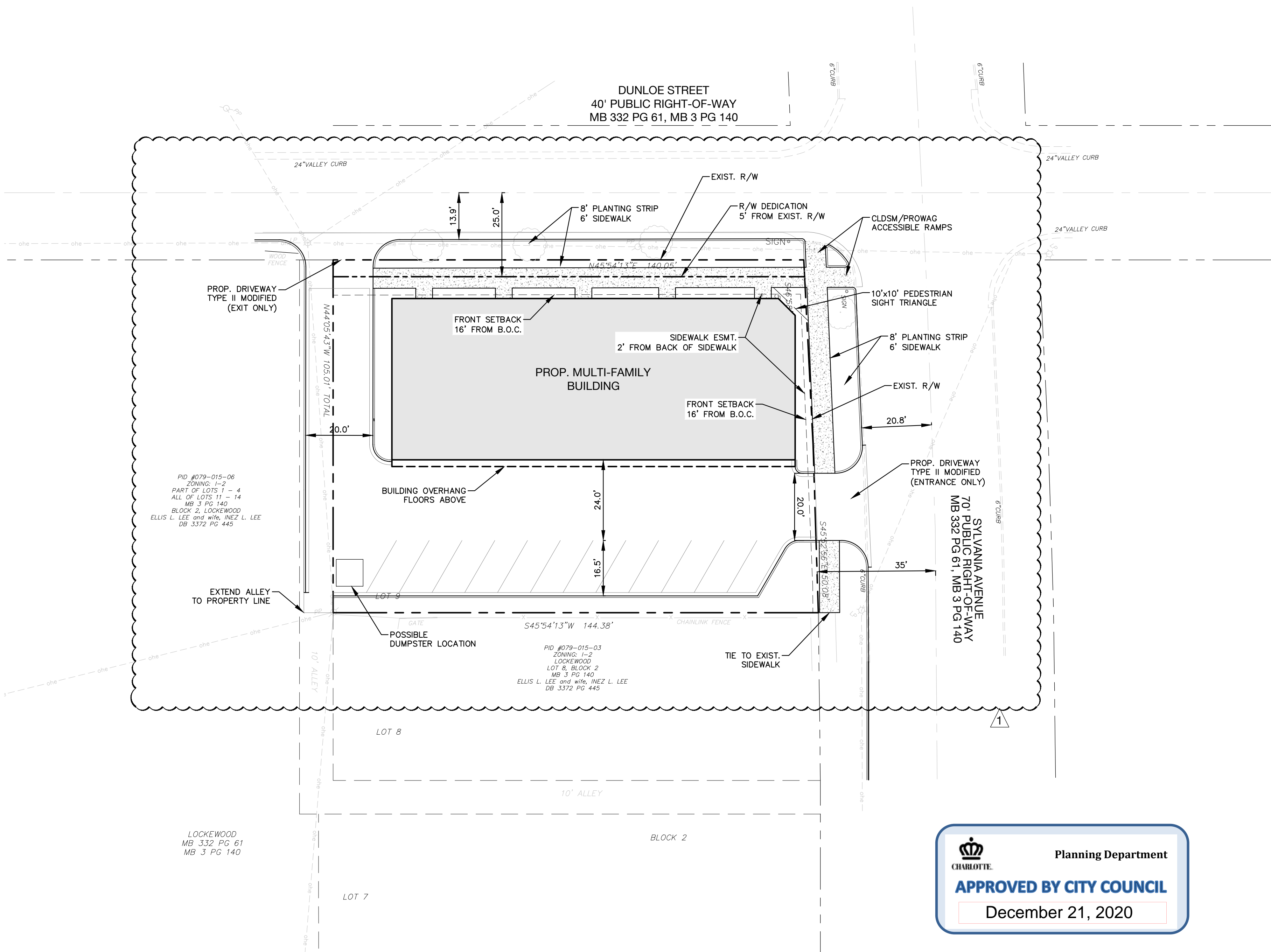

Planning Department
APPROVED BY CITY COUNCIL
December 21, 2020

Dunloe Apartments

Rezoning Plan
117 & 121 Sylvania Avenue Charlotte, NC 28206

NO.	DATE	BY	REVISIONS
1	10.12.20	BDS	PER CITY COMMENTS

Project No: 20-CLT-046
Date: 07.08.2020
Designed by: UDP
Drawn By: UDP
Sheet No:

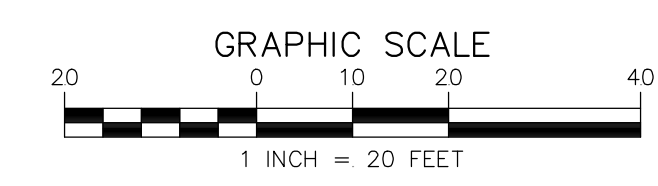

REZONING PETITION #2020-124

RZ-1.0