

LEGEND	
	FOCAL POINT ON KEY CORNER
	REQUIRED INTERNAL PRIVATE STREET DESIGNED TO PUBLIC STANDARDS
	PRIVATE ACCESS DRIVE
	BUILDING FRONTAGE AREA
	RETAIL BUILDING CORNER
	PERMISSIBLE PARKING AREA
	SETBACK/BUFFER LINE
	EXISTING RIGHT-OF-WAY
	FUTURE RIGHT-OF-WAY
	FULL MOVEMENT ACCESS POINTS
	POTENTIAL FULL MOVEMENT SITE/BUILDING ACCESS POINTS INTO DEVELOPMENT
	OPTIONAL RIGHT IN/RIGHT OUT MOVEMENT ACCESS POINTS
	AMENITIZED PUBLICLY ACCESSIBLE OPEN SPACE
	EXISTING BUILDING (MAY REMAIN)

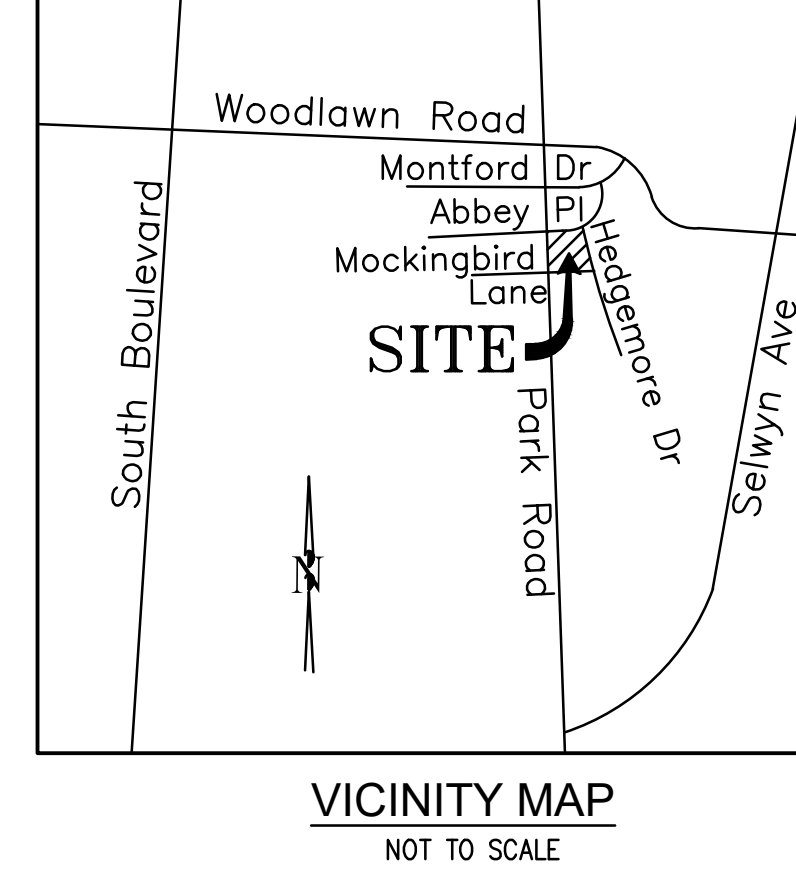

**ZONING CODE SUMMARY**  
 PROJECT NAME: PARK ROAD REDEVELOPMENT  
 OWNER: PARK CHARLOTTE, LLC  
 CLIENT NAME: GRUBB PROPERTIES, PHONE# (704) 372-5616  
 PLANS PREPARED BY: KIMLEY-HORN AND ASSOCIATES PHONE# (704)333-5131  
 TAX PARCEL ID: 17514405  
 STREET ADDRESS: PARK ROAD AT ABBEY PLACE  
 EXISTING ZONING: MUDD-O  
 PROPOSED ZONING: MUDD-O  
 PROPOSED USE: MIXED USE - RETAIL/OFFICE/MULTIFAMILY  
 PROPOSED BUILDING HEIGHT: AS ALLOWED BY THE APPLICABLE ZONING DISTRICT. SEE TECHNICAL DEVELOPMENT STANDARDS (RZ-2) FOR MORE INFORMATION.  
 EXISTING LOT SIZE: ±10.66 ACRES  
 JURISDICTION: CITY OF CHARLOTTE

**Kimley-Horn**  
 © 2023 KIMLEY-HORN AND ASSOCIATES, INC.  
 200 SOUTH TRYON ST., SUITE 200, CHARLOTTE, NC 28202  
 WWW.KIMLEY-HORN.COM  
 NC LICENSE # F-0102

**NOT FOR CONSTRUCTION**

KH PROJECT	018740008
DATE	01/31/2023
SCALE	AS SHOWN
DESIGNED BY	LKH
DRAWN BY	LKH
CHECKED BY	RTL

**TECHNICAL DATA SHEET**

**PARK ROAD REDEVELOPMENT**  
 PARK RD AT ABBEY PLACE

SHEET NUMBER  
**RZ-1**

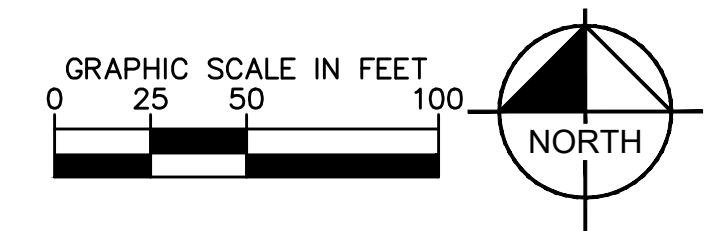
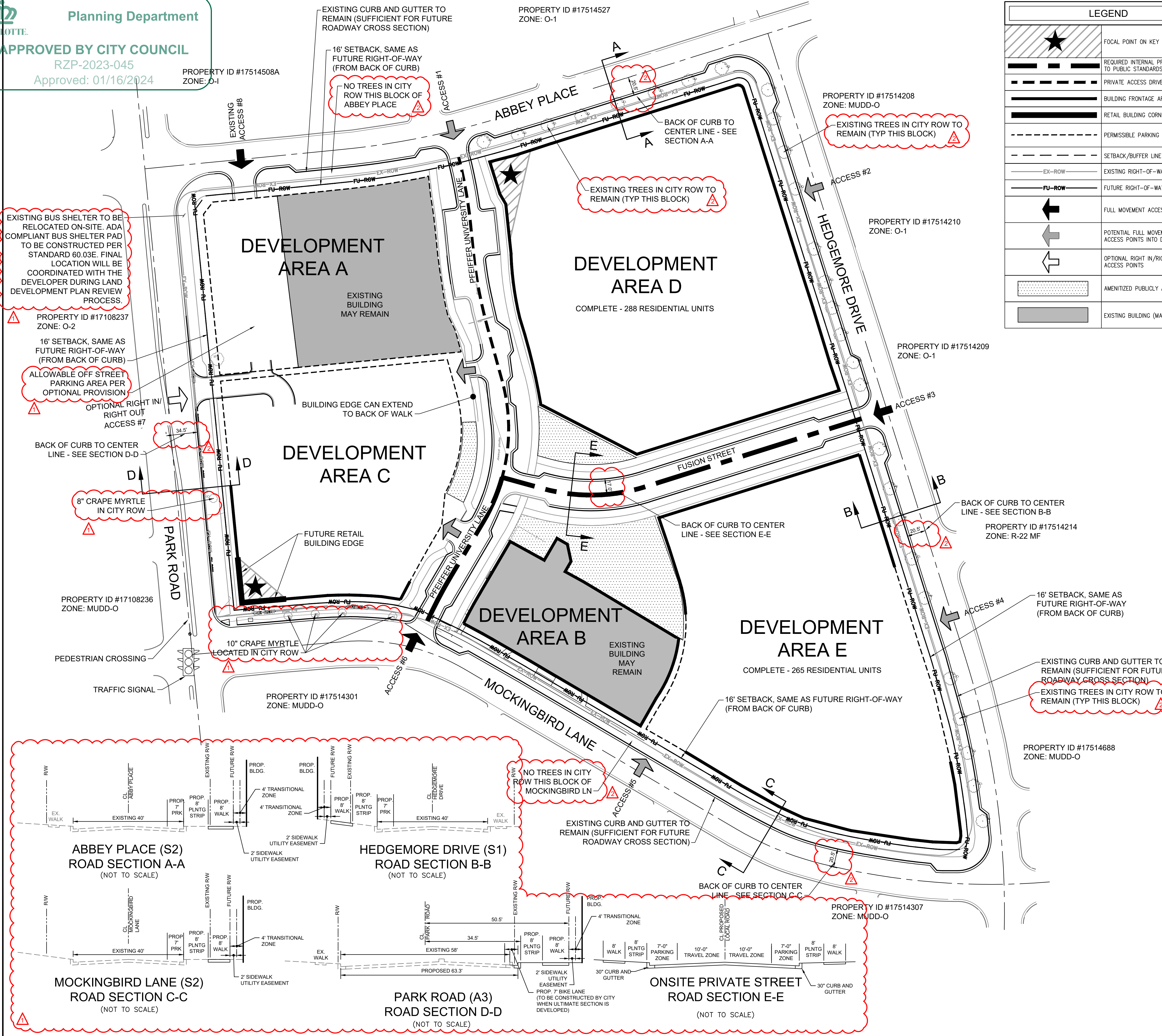

Planning Department
APPROVED BY CITY COUNCIL
RZP-2023-045
Approved: 01/16/2024
REZONING PETITION NO. 2023-XXX
SUBJECT: GRUBB PROPERTIES, PETITIONER
SUBJECT TO CONVERSION RIGHTS AS DEFINED HEREIN.

811 logo
Kimley-Horn logo
© 2023 KIMLEY-HORN AND ASSOCIATES, INC.
200 SOUTH IRYON ST., SUITE 200, CHARLOTTE, NC 28202
WWW.KIMLEY-HORN.COM
NC LICENSE # 0102
REVISIONS table with columns for No., Description, and Date.