

I, DAVID H. SNIDER, CERTIFY THAT THIS PLAT WAS PREPARED UNDER MY SUPERVISION AND THAT THE PLAT WAS PREPARED FOR THE PURPOSE OF EASEMENTS ONLY, AND IS NOT INTENDED TO BE A BOUNDARY SURVEY OF PROPERTY SHOWN.

David H. Snider 9/11/13
 DAVID H. SNIDER, NC P.L.S. L-2942 DATE

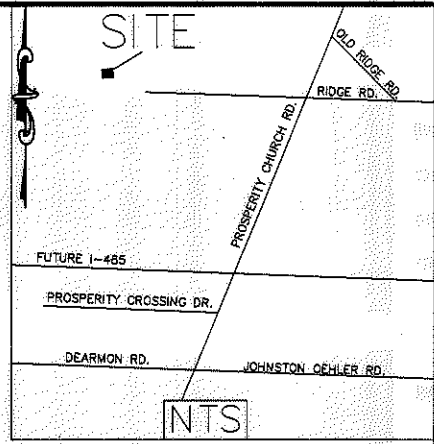
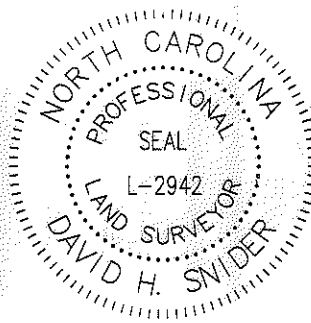

LEGEND

- IRON PIN FOUND ○
- CALCULATED POINT ●
- LINES SURVEYED _____
- LINES NOT SURVEYED - - - - -
- TEMP. CONSTRUCTION EASEMENT

Line Table		
Line #	Length	Direction
L1	22.02	N75°37'45"W
L2	25.52	S36°16'39"E
L3	16.34	N22°34'34"E
L4	82.98	S22°12'45"W
L5	16.40	S21°50'40"W
L6	15.52	N22°34'34"E

FOGGY MEADOW RD.
 50' RIGHT-OF-WAY

(N75°37'45"W 81.83') TOTAL

-Y4-
 100+12.47
 24.41' LT

(N14°37'55"E 130.00')

⑦
 027-568-01
JONATHAN M. FENTRESS
 DB 17985 PG 729
 8931 FOGGY MEADOW RD.

- 1) BEARINGS AND DISTANCES SHOWN IN PARENTHESES ARE BASED ON RECORDED MAP INFORMATION.
- 2) TOTAL AREA 9,504 SQ. FT.
- 3) TEMP CONSTRUCTION EASEMENT 178 SQ. FT.
- 4) AREA REMAINING 9,504 SQ. FT.

(S22°12'45"W 82.98')

(N75°37'45"W 64.47')

COMBINED GRID
 FACTOR= 0.999841662
 N: 595448.56
 E: 1466233.28

STATE OF NORTH CAROLINA
 COUNTY OF MECKLENBURG

I, _____ REVIEW OFFICER OF MECKLENBURG COUNTY, CERTIFY THAT THE MAP OR PLAT TO WHICH THIS CERTIFICATION IS AFFIXED MEETS ALL STATUTORY REQUIREMENTS FOR RECORDING.

REVIEW OFFICER _____ DATE _____

PREPARED BY:
 CITY OF CHARLOTTE
 ENGINEERING DEPARTMENT
 600 EAST FOURTH STREET
 CHARLOTTE, NC 28202
 704-336-2291

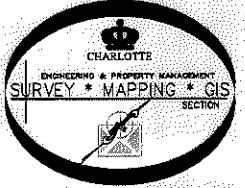

		CHARLOTTE ENGINEERING DEPARTMENT
REVISIONS	PROSPERITY VILLAGE NW ARC B	JOB NO. 512-14-003
SCALE 0 1" = 20" 1"		214003
DRAWN BY P.S.	PROPERTY OF JONATHAN M. FENTRESS CHARLOTTE, MECKLENBURG CO., NC	SHEET 1
DATE	CHECKED BY DS SURVEY SUPVR. <i>AK</i>	OF 1
K:\AutoCad\En_su-LD4\214003\Prosperity Village NW B\Plats\#7 027-568-01		