

I, JACKIE W. BRIM, CERTIFY THAT THIS PLAT WAS PREPARED UNDER MY SUPERVISION AND THAT THE PLAT WAS PREPARED FOR THE PURPOSE OF ACQUISITION AND EASEMENTS ONLY, AND IS NOT INTENDED TO BE A BOUNDARY SURVEY OF PROPERTY SHOWN.

Jackie W. Brim 4-14-2016
 JACKIE W. BRIM, NC P.L.S. L-4348 DATE

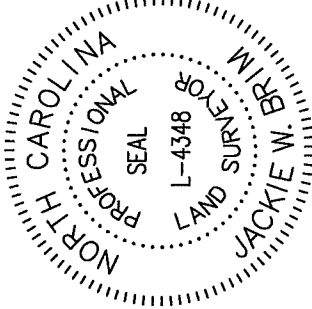

**ERNEST RUSSELL COURT
 (50' PUBLIC R/W)**

REBAR FOUND (SENT)

- NOTE:
- 1) BEARINGS AND DISTANCE SHOWN IN PARENTHESIS ARE BASED ON RECORDED INFORMATION.
 - 2) COMPUTED PROJECT DISTANCE - * 6,000 SQ.FT.
 - 3) TOTAL AREA 467 SQ.FT.
 - 4) TEMP. CONSTRUCTION EASEMENT 230 SQ.FT.
 - 5) STORM DRAINAGE EASEMENT 230 SQ.FT.
 - 6) EXISTING STORM DRAINAGE EASEMENT AREA TO BE ACCEPTED BY THE CITY OF CHARLOTTE AS SDE 230 SQ.FT.
 - 7) EXISTING STORM DRAINAGE EASEMENT AND SDE OVERLAP AREA 230 SQ.FT.
 - 8) TOTAL AREA REMAINING 6,000 SQ.FT.

STATE OF NORTH CAROLINA
 COUNTY OF MECKLENBURG

REVIEW OFFICER OF MECKLENBURG COUNTY, CERTIFY THAT THE MAP OR PLAT TO WHICH THIS CERTIFICATION IS AFFIXED MEETS ALL STATUTORY REQUIREMENTS FOR RECORDING.

REVIEW OFFICER _____ DATE _____

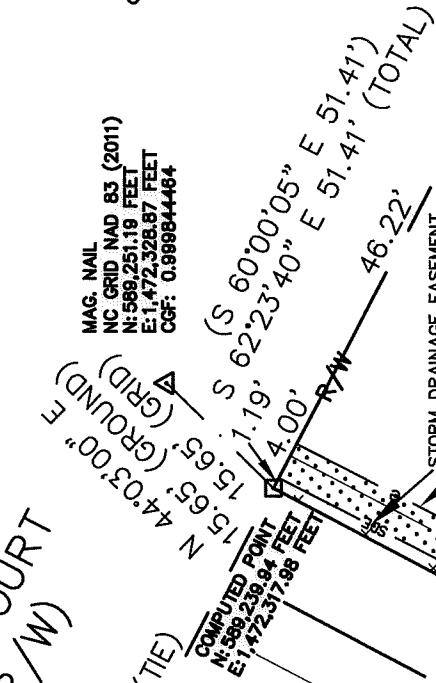

02934469
 JOYA WILMOT
 DB 28189/PG 78
 3207 ERNEST RUSSELL COURT

02934496
 HATTIE'S MEADOW OWNERS ASSOCIATION, INC.
 DB 22060/PG 936
 ERNEST RUSSELL COURT

02934468
 SABICAH A. MUHAMMAD
 DB 22621/PG 475
 3203 ERNEST RUSSELL COURT

02934467
 NICOLE J. NOCERINO
 DB 28236/PG 897
 11623 RUTH POLK COURT

LEGEND

- REBAR OR IRON PIN FOUND
- COMPUTED POINT
- PROPERTY LINES
- EXISTING RIGHT-OF-WAY
- EXISTING EASEMENTS
- TEMP. CONSTRUCTION EASEMENT
- STORM DRAINAGE EASEMENT

PREPARED BY:
 CITY OF CHARLOTTE
 ENGINEERING & PROPERTY MANAGEMENT DEPARTMENT
 600 EAST FOURTH STREET
 CHARLOTTE, NC 28202
 704-356-2291



CHARLOTTE ENGINEERING & PROPERTY MANAGEMENT DEPARTMENT		JOB NO. SMDES00416	SHEET 1
3211 ERNEST RUSSEL COURT STORM WATER MAINTENANCE IMPROVEMENT PROJECT		FILE NO. 029-344-69	OF 1
PROPERTY OF JOYA WILMOT		CHECKED BY JWB SURVEY SUPVR.	
DRAWN BY LG		DATE	
K:\AutoCad\En_jw-LD4\SMDES00416-ErnestRussellCourt.dwg\ErnestRussellCourt-C320215.DWG			