

I, DAVID H. SNIDER, CERTIFY THAT THIS PLAT WAS PREPARED UNDER MY SUPERVISION AND THAT THE PLAT WAS PREPARED FOR THE PURPOSE OF EASEMENTS ONLY, AND IS NOT INTENDED TO BE A BOUNDARY SURVEY OF PROPERTY SHOWN.

David H. Snider 11/2/14
 DAVID H. SNIDER, NC P.L.S. L-2942 DATE

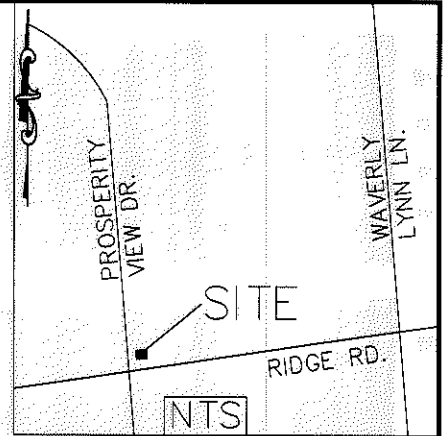
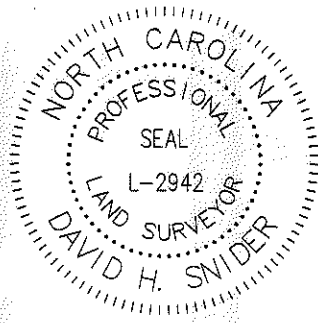

N88°59'34"W 208.20'
 (N88°59'12"W 208.32')

LEGEND

- IRON PIN FOUND ○
- CALCULATED POINT ●
- LINES SURVEYED ———
- LINES NOT SURVEYED - - - - -
- TEMP. CONSTRUCTION EASEMENT [Stippled Area]
- SIDEWALK UTILITY EASEMENT [Hatched Area]

COMBINED GRID
 FACTOR= 0.099841662
 N: 595905.43
 E: 1470197.05

5

029-41C-99
 Ridge Road Villas Condominium Unit
 Owners Association, Inc. as agent for the
 individual owners of the condominiums
 U/F 831 PG 32

S0°58'31"W 250.35'
 (S0°00'48"W 250.36')

6

029-411-03

S0°37'24"W
 20.54'

-Y1-
 41+46.21
 41.5587 LT

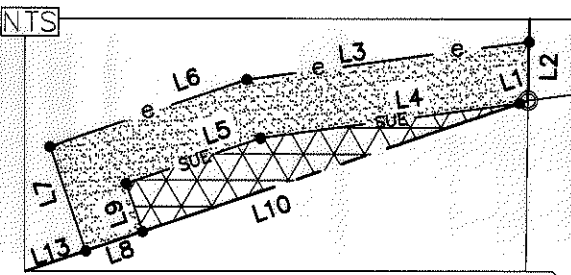

029-411-48
 MULTIPLE OWNERS
 PROSPERITY VIEW DR
 TOWNHOMES

STATE OF NORTH CAROLINA
 COUNTY OF MECKLENBURG

RIDGE RD.
 (RIGHT-OF-WAY VARIES)

1) BEARINGS AND DISTANCES SHOWN IN PARENTHESES ARE BASED ON RECORDED MAP INFORMATION.

- 2) TOTAL AREA 51,332 SQ. FT.
- 3) TEMP CONSTRUCTION EASEMENT 222 SQ. FT.
- 4) SIDEWALK UTILITY EASEMENT 96 SQ. FT.
- 5) AREA REMAINING 51,332 SQ. FT.

I, _____, REVIEW OFFICER OF MECKLENBURG COUNTY, CERTIFY THAT THE MAP OR PLAT TO WHICH THIS CERTIFICATION IS AFFIXED MEETS ALL STATUTORY REQUIREMENTS FOR RECORDING.

REVIEW OFFICER

DATE

PREPARED BY:
 CITY OF CHARLOTTE
 ENGINEERING DEPARTMENT
 600 EAST FOURTH STREET
 CHARLOTTE, NC 28202
 704-336-2291

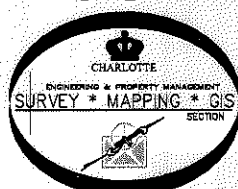

		CHARLOTTE ENGINEERING DEPARTMENT	
REVISIONS		JOB NO.	
12/31/13 OWNER INFO		512-10-043	
12/17/13 OWNER INFO		210043	
SCALE 0 1' = 40" 1'		PROPERTY OF Ridge Road Villas Condominium Unit Owners Association, Inc. as agent for the individual owners of the condominiums CHARLOTTE, MECKLENBURG CO., NC	
DRAWN BY P.S.		SHEET 1	
DATE		OF 2	
CHECKED BY DS		SURVEY SUPVR. <i>DN</i>	
K:\AutoCad\En_su-LD4\210043 Prosperity Ridge Road Prosperity Church Rd\Plots\#5 029-41C-99			

I, DAVID H. SNIDER, CERTIFY THAT THIS PLAT WAS PREPARED UNDER MY SUPERVISION AND THAT THE PLAT WAS PREPARED FOR THE PURPOSE OF EASEMENTS ONLY, AND IS NOT INTENDED TO BE A BOUNDARY SURVEY OF PROPERTY SHOWN.

David H. Snider 1/2/14
 DAVID H. SNIDER, NC P.L.S. L-2942 DATE



NC GRID NAD 83/2001 VRS

Line Table		
Line #	Length	Direction
L1	0.75	S71°02'30"W
L2	4.91	S00°58'31"W
L3	23.75	N82°18'58"E
L4	21.79	N82°18'58"E
L5	11.82	N71°06'28"E
L6	17.31	N71°04'44"E
L7	9.27	N18°53'32"W
L8	5.00	S71°02'30"W
L9	4.27	N18°53'32"W
L10	33.19	S71°02'30"W
L11	50.32	S00°05'20"W
L12	138.59	S14°44'36"E
L13	84.15	S71°02'30"W

Curve Table				
Curve #	Length	Radius	CHORD BEARING	CHORD
C3	56.62	170.00	N9°27'08"W	56.36
C2	33.65	130.00	S7°19'38"E	33.56
C1	49.34	30.00	S61°51'15"E	43.96

STATE OF NORTH CAROLINA
 COUNTY OF MECKLENBURG

I, _____, REVIEW OFFICER OF MECKLENBURG COUNTY, CERTIFY THAT THE MAP OR PLAT TO WHICH THIS CERTIFICATION IS AFFIXED MEETS ALL STATUTORY REQUIREMENTS FOR RECORDING.

REVIEW OFFICER

DATE

PREPARED BY:
 CITY OF CHARLOTTE
 ENGINEERING DEPARTMENT
 600 EAST FOURTH STREET
 CHARLOTTE, NC 28202
 704-336-2291



CHARLOTTE ENGINEERING DEPARTMENT		JOB NO. 512-10-043
PROSPERITY RIDGE CONNECTION		210043
PROPERTY OF Ridge Road Villas Condominium Unit Owners Association, Inc. as agent for the individual owners of the condominiums CHARLOTTE, MECKLENBURG CO., NC		SHEET 2 OF 2
REVISIONS	12/31/13 OWNER INFO 12/17/13 OWNER INFO	
SCALE 0 1" = 40" 1"		
DRAWN BY P.S.	DATE	CHECKED BY DS SURVEY SUPVR. <i>DS</i>
K:\AutoCad\En_Lsu-LD4\210043 Prosperity Ridge Road Prosperity Church Rd\Plats\#5 029-41C-99		