

I, DAVID H. SNIDER, CERTIFY THAT THIS PLAT WAS PREPARED UNDER MY SUPERVISION AND THAT THE PLAT WAS PREPARED FOR THE PURPOSE OF EASEMENTS ONLY, AND IS NOT INTENDED TO BE A BOUNDARY SURVEY OF PROPERTY SHOWN.

*David H. Snider* 4/23/13  
 DAVID H. SNIDER, NC P.L.S. L-2942 DATE

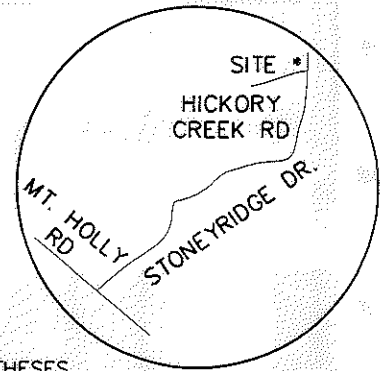
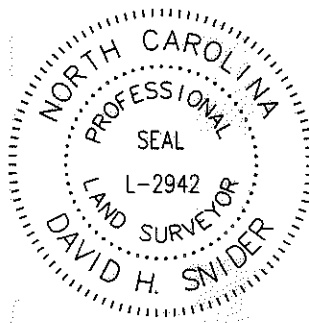

VICINITY MAP  
not to scale

State of North Carolina  
 County of Mecklenburg

I, \_\_\_\_\_, Review Officer of Mecklenburg County, certify that the map or plat to which this certification is affixed meets all statutory requirements for recording.

NOTES:

- 1) BEARINGS AND DISTANCES SHOWN IN PARENTHESES ARE BASED ON RECORDED MAP INFORMATION.
- 2) TOTAL AREA 22,376 SQ.FT.
- 3) STORM DRAINAGE EASEMENT 634 SQ.FT.
- 4) TEMPORARY CONSTRUCTION EASEMENT 1,114 SQ.FT.
- 5) AREA REMAINING 22,376 SQ.FT.

Review Officer \_\_\_\_\_

Date \_\_\_\_\_

CITY TP MAG NAIL  
 N 570900.98  
 E 1414243.75  
 CGF 0.999842389

TAX ID# 031-391-17  
 BILLY J. RICK AND WIFE,  
 ANNA W. RICK  
 DB: 15442-485  
 2225 STONEYRIDGE DR.

STORM DRAINAGE EASEMENT

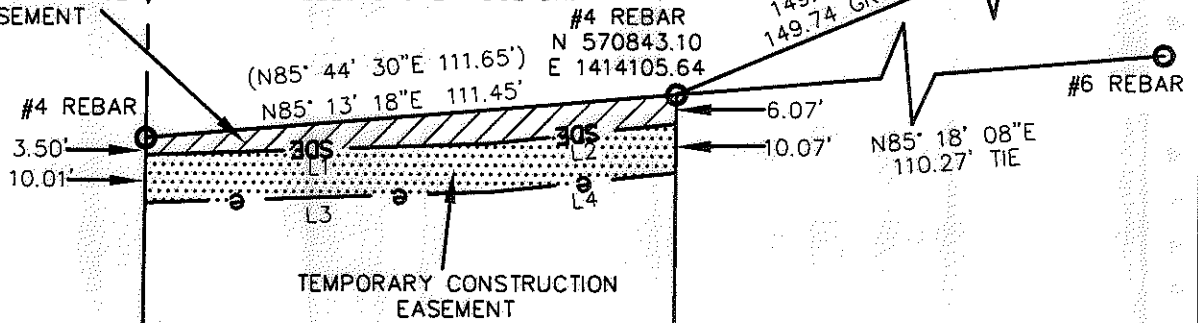

TAX ID# 031-391-14  
 LYNN R. HUGHES AND WIFE,  
 KAREN HUGHES  
 DB: 4034-785  
 9416 HICKORY CREEK RD.

TAX ID# 031-391-15  
 LAWRENCE N. HOLDEN, JR. AND  
 WIFE, PEGGY E. HOLDEN  
 DB: 3926-108  
 9410 HICKORY CREEK RD.

TAX ID# 031-391-16  
 TRACY S. GREGORY  
 DB: 20161-664  
 9400 HICKORY CREEK RD.



(N01° 20' 40" E 207.65')  
 N0° 59' 35" E  
 207.10' TOTAL  
 193.59'

183.48'  
 50° 33' 00" W  
 199.62' TOTAL  
 (50° 58' 00" W 200.00')

LINE TABLE		
LINE	LENGTH	BEARING
L1	71.76	S88° 01' 05" W
L2	39.57	S83° 51' 12" W
L3	72.64	S88° 01' 05" W
L4	38.76	S83° 51' 12" W

(L=114.44', R=364.43')  
 L=114.44' R=364.43'  
 S81° 33' 14" W Chord 113.97'

HICKORY CREEK ROAD  
 50' PUBLIC RIGHT-OF-WAY

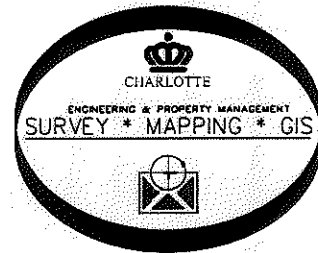

LEGEND

- IRON PIN OR PIPE FOUND
- CITY TRAVERSE MAG NAIL
- CALCULATED POINT
- LINES SURVEYED
- LINES NOT SURVEYED
- STORM DRAINAGE EASEMENT
- TEMPORARY CONSTRUCTION EASEMENT

PREPARED BY:  
 CITY OF CHARLOTTE  
 ENGINEERING & PROPERTY MANAGEMENT  
 600 EAST FOURTH STREET  
 CHARLOTTE, NC 28208  
 704-336-2291

 CHARLOTTE ENGINEERING & PROPERTY MANAGEMENT DEPARTMENT		
REVISIONS	<b>9410 HICKORY CREEK                  STORM WATER MAINTENANCE                  IMPROVEMENT PROJECT</b>	JOB NO. 514-93-096
		FILE NO.
SCALE 1" = 40' 	OWNER: TAX ID# 031-391-15 LAWRENCE N. HOLDEN, JR. AND WIFE, PEGGY E. HOLDEN CHARLOTTE, MECKLENBURG CO., NC	SHEET 1 OF 1
DRAWN BY JBB DATE: _____	CHECKED BY GI SURVEY SUPVR. <i>GI</i>	
P: Surproj\SWATER\MAINT\HICKORY CREEK\9400\PLATS\9410 HICKORY CREEK.dwg		