

VICINITY MAP  
Not to Scale

033-044-03  
WEI JUN CHEN  
DB 24604-342  
11210 CHASTAIN PARC DR.

033-044-05  
OSCAR ALFREDO MORALES-TERAN  
MARIA MORALES  
DB 11447-386  
11209 GOLDEN DR.

033-044-05  
TIMOTHY B. McKYER  
DB 11447-386  
11201 GOLDEN DR.

033-044-04  
JAMES J. KAKACEK  
SUSAN M. KAKACEK  
DB 15793-568  
11204 CHASTAIN PARC DR.

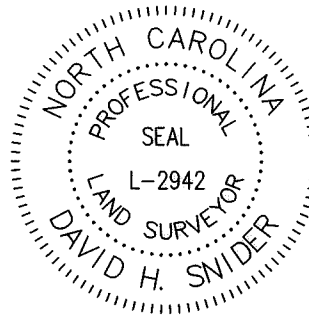

I, DAVID H. SNIDER, CERTIFY THAT THIS PLAT WAS PREPARED UNDER MY SUPERVISION AND THAT THE PLAT WAS PREPARED FOR THE PURPOSE OF EASEMENTS ONLY, AND IS NOT INTENDED TO BE A BOUNDARY SURVEY OF PROPERTY SHOWN.  
*David H. Snider* 01/23/15  
DAVID H. SNIDER, NC P.L.S. L-2942 DATE

State of North Carolina  
County of Mecklenburg

I, \_\_\_\_\_, Review Officer of Mecklenburg County, certify that the map or plat to which this certification is affixed meets all statutory requirements for recording.

Review Officer \_\_\_\_\_ Date \_\_\_\_\_

LEGEND

- REBAR FOUND
- CITY TRAVERSE MAG NAIL
- CALCULATED POINT
- LINES SURVEYED
- LINES NOT SURVEYED
- EXISTING PDE
- STORM DRAINAGE EASEMENT (SDE)
- TEMPORARY CONSTRUCTION EASEMENT (SDE)

NOTES:

- 1) BEARINGS AND DISTANCES SHOWN IN PARENTHESES ARE BASED ON RECORDED INFORMATION, MB 38-243
- 2) TOTAL AREA 11,419 SQ.FT.
- 3) EXISTING EASEMENT TO BE ACCEPTED AS SDE 115 SQ.FT.
- 4) STORM DRAINAGE EASEMENT 410 SQ.FT.
- 5) TOTAL STORM DRAINAGE EASEMENT 525 SQ.FT.
- 6) TEMPORARY CONSTRUCTION EASEMENT 686 SQ.FT.
- 7) AREA REMAINING 11,419 SQ.FT.

NC GRID NAD 83 (2011)

TOTAL  
R=625.00', L=55.29'  
CH=55.27', N32°27'24"W  
(R=625.00', L=55.29'  
CH=55.27', N33°54'37"W)

SIGHT TRIANGLE  
PER MB 30-687

STORM DRAINAGE  
EASEMENT

TEMPORARY  
CONSTRUCTION  
EASEMENT

TOTAL  
R=325.00', L=81.78'  
CH=81.56', S67°24'14"W  
(R=325.00', L=81.38'  
CH=81.17', S66°00'07"W)

LINE	BEARING	DIST.
1	S74°02'13"E	33.58'
2	S60°21'58"W	3.29'
3	S60°21'58"W	18.50'
4	N51°15'14"E	37.48'
5	N83°41'26"E	35.41'
6	N18°00'58"W	1.77'
7	N18°00'58"W	5.11'
8	N83°41'26"E	35.83'
9	N51°15'14"E	38.97'
10	N60°36'07"E	27.21'
11	N74°02'13"W	36.95'

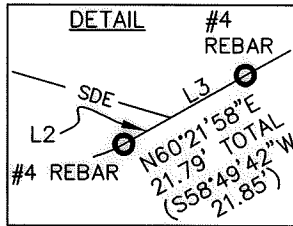

CURVE	RADIUS	LENGTH	CHORD BEARING	DIST.
1	625.00'	4.09'	N30°06'36"W	4.09'
2	625.00'	7.28'	N30°37'52"W	7.28'
3	625.00'	43.92'	S32°58'40"W	43.91'
4	325.00'	11.79'	S61°14'04"W	11.78'
5	325.00'	69.99'	S68°26'34"W	69.86'

MAG NAIL  
NC GRID NAD 83 (2011)  
N 581627.83'  
E 1422536.97'  
CGF: 0.99984300

PREPARED BY:  
CITY OF CHARLOTTE  
ENGINEERING & PROPERTY MANAGEMENT DEPT.  
600 EAST FOURTH STREET  
CHARLOTTE, NC 28208  
704-336-2291

**CHARLOTTE**  
ENGINEERING & PROPERTY MANAGEMENT DEPARTMENT

REVISIONS	4510 ASTONBORO DR. STORM WATER MAINTENANCE IMPROVEMENT PROJECT	JOB NO. SWDES00395	FILE NO.
SCALE 1"=30'	OWNERS: JAMES J. KAKACEK SUSAN M. KAKACEK 11204 CHASTAIN PARC CHARLOTTE, MECKLENBURG CO., NC	SHEET 1	OF 1
DRAWN BY JPG	CHECKED BY GAI	SURVEY SUPVR. <i>DS</i>	

P:\acadproj\Surproj\SWATER\MAINT\ASTONBORO\4510\PLAT\4510 Astonboro Dr\_11204 CHASTAIN PLAT 1.dwg