

I, DAVID H. SNIDER, CERTIFY THAT THIS PLAT WAS PREPARED UNDER MY SUPERVISION AND THAT THE PLAT WAS PREPARED FOR THE PURPOSE OF ACQUISITION AND EASEMENTS ONLY, AND IS NOT INTENDED TO BE A BOUNDARY SURVEY OF PROPERTY SHOWN.

*David H. Snider* 11/29/05  
 DAVID H. SNIDER, NC P.L.S. L-2942 DATE



# DETAIL "A"

N.T.S.

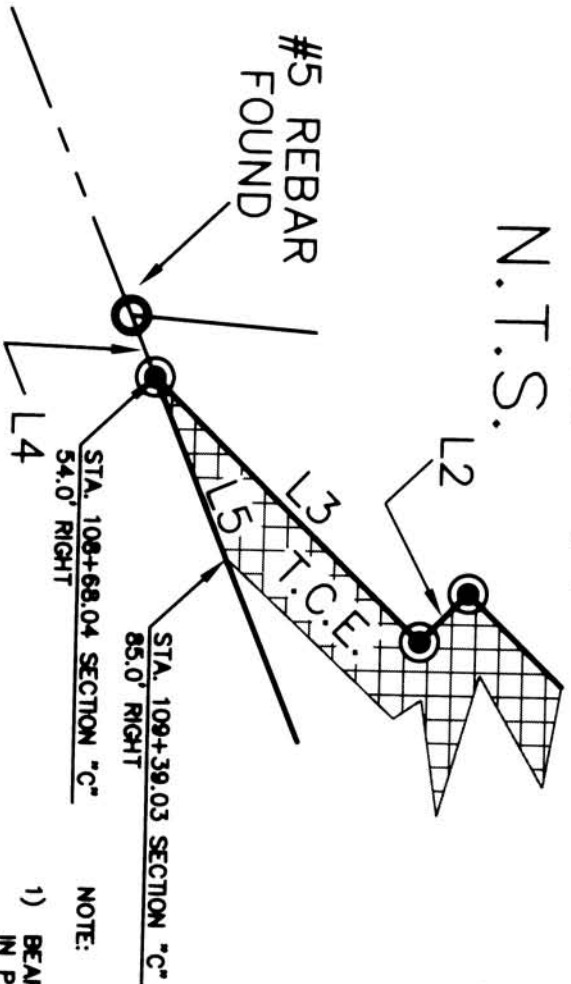

State of North Carolina  
 County of Mecklenburg

I, Review Officer of Mecklenburg County, certify that the map or plat to which this certification is affixed meets all statutory requirements for recording.

Review Officer \_\_\_\_\_ Date \_\_\_\_\_

# DETAIL "B"

N.T.S.

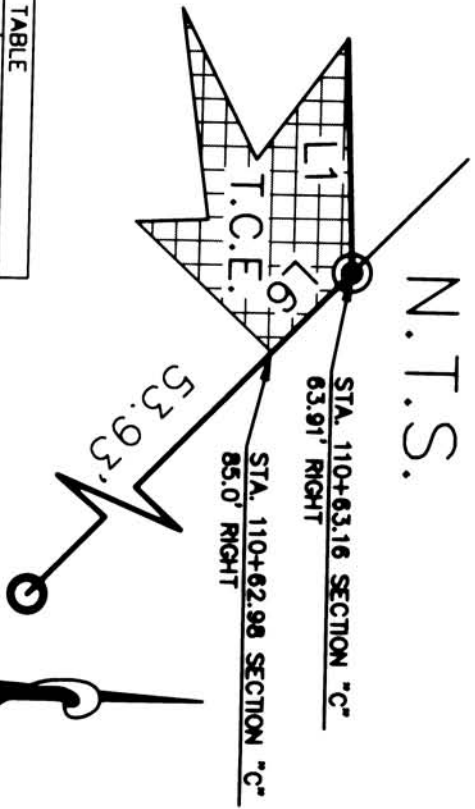

LINE	LENGTH	BEARING
L1	20.06	N87°43'10"E
L2	4.00	N46°09'49"W
L3	36.96	S43°50'11"W
L4	3.45	S67°25'35"W
L5	77.46	N67°25'35"E
L6	21.09	S45°40'48"E

- NOTE:
- 1) BEARINGS AND DISTANCES SHOWN IN PARENTHESES ARE BASED ON RECORDED MAP INFORMATION.
  - 2) TOTAL AREA 57,481 SQ.FT.
  - 3) TEMPORARY CONSTRUCTION EASEMENT (T.C.E.) 5,478 SQ.FT.
  - 4) FEE OUTSIDE EXISTING R/W 16,155 SQ.FT.
  - 5) FEE INSIDE EXISTING R/W 32,506 SQ.FT.
  - 6) AREA REMAINING 8,821 SQ.FT.

PREPARED BY:  
 CITY OF CHARLOTTE  
 ENGINEERING DEPARTMENT  
 800 EAST FOURTH STREET  
 CHARLOTTE, NC 28202  
 704-336-2291

CHARLOTTE ENGINEERING DEPARTMENT		JOB NO. 02-15-05
FRED D. ALEXANDER - SECTION C		FILE NO. 02-15-05
PROPERTY ACQUISITION OWNER: JAMES W. TORRENCE, JR. CHARLOTTE, MECKLENBURG CO., NC		SHEET 2 OF 2
DATE 02-15-05 DRAWN BY G.C.F. CHECKED BY SURVEY SUPER		DATE 02-15-05