

AREA TABLE	
TOTAL PARCEL AREA	14,261 SF
TOTAL TEMP CONSTRUCTION EASEMENT (TCE)	156 SF
TOTAL PARCEL AREA REMAINING	14,261 SF

DATUM DESCRIPTION:  
 THE LOCALIZED COORDINATE SYSTEM DEVELOPED FOR THIS PROJECT IS BASED ON STATE PLANE COORDINATES ESTABLISHED BY: NCGS MONUMENT RESEVOIR NAD 83(2011) STATE PLANE COORDINATES OF NORTING: 561,874.06 EASTING: 1,434,680.70 ELEVATION: 815.25. THE AVERAGE COMBINED GRID FACTOR USED ON THIS PROJECT (GROUND TO GRID) IS: 0.999838520. VERTICAL DATUM: NAVD 88. ALL LINEAR DIMENSIONS ARE LOCALIZED HORIZONTAL DISTANCES. DATE OF SURVEY: 10/2016

STATE OF NORTH CAROLINA  
 COUNTY OF MECKLENBURG  
 I, \_\_\_\_\_, REVIEW OFFICER OF MECKLENBURG COUNTY, CERTIFY THAT THE MAP OR PLAT TO WHICH THIS CERTIFICATION IS ATTACHED MEETS ALL STATUTORY REQUIREMENTS FOR RECORDING.

REVIEW OFFICER \_\_\_\_\_ DATE \_\_\_\_\_

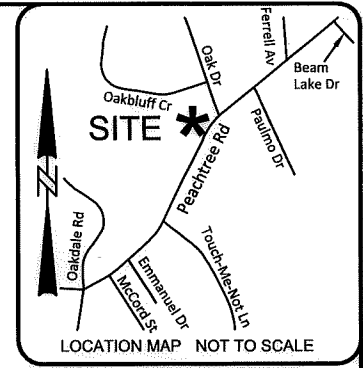

DEWBERRY TP #38  
 SET CAPPED REBAR  
 N: 567612.30  
 E: 1436812.35  
 ELEV: 807.23

CURVE	ARC LENGTH	RADIUS	CHORD BEARING	CHORD LENGTH
C1	37.14'	45.00'	N 09°06'49" E	36.09'
C2	68.66'	584.33'	S 37°43'52" W	68.62'
C3	88.29'	584.33'	S 30°02'12" W	88.20'

LOCALIZED GRID  
 COORDINATES  
 N: 567539.15  
 E: 1436720.69

NOTE: PROPERTY CORNERS SHOWN CIRCLED WERE LOCATED BY ACTUAL FIELD SURVEY. BEARINGS ARE BASED ON N.C. STATE GRID NORTH. THIS MAP WAS PREPARED FOR THE PURPOSE OF RIGHT-OF-WAY AND/OR EASEMENT ACQUISITION ONLY, AND IS NOT INTENDED TO BE A BOUNDARY SURVEY OF THE PROPERTY SHOWN. THIS MAP WAS PREPARED UNDER MY SUPERVISION.

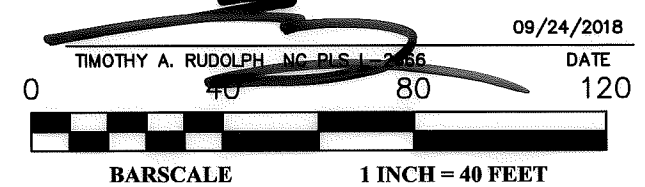

**LEGEND**

- TEMPORARY CONSTRUCTION ESMT (TCE) [Pattern]
- TEMPORARY CONST ESMT [Pattern]
- RIGHT OF WAY [Line]
- RIGHT OF WAY BY MAINTENANCE (MAINT.) [Line]
- EXISTING PROPERTY LINE [Line]
- ADJOINING PROPERTY LINE [Line]
- FIELD LOCATED PROPERTY IRON [Symbol]
- DEED/PLAT CALL [Symbol]

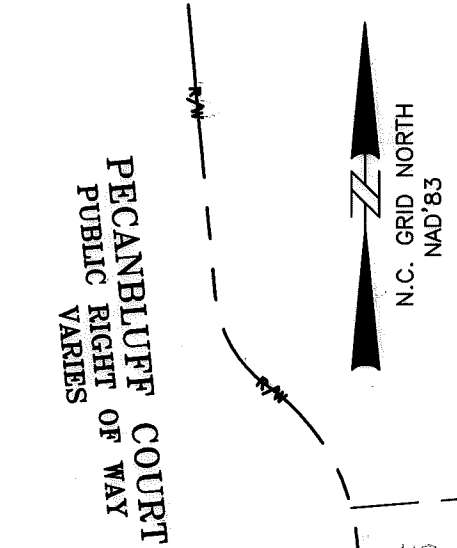

15  
 037-292-04  
 ALLEN G. WATSON, JR.  
 DEBORAH A. WATSON  
 DB 6957 PG 113  
 MB 23 PG 784  
 5410 PECANBLUFF CT

14  
 037-292-05  
 NOW OR FORMERLY  
 CHRISTOPHER LOUIS KILGANNON  
 DB 11882 PG 294  
 MB 23 PG 784  
 5402 PECANBLUFF CT

13  
 037-292-06  
 DAVID MICHAEL DIMUZIO  
 DB 17916 PG 950  
 MB 23 PG 784  
 5400 PECANBLUFF CT

LINE	BEARING	DISTANCE
L1	N 33°41'05" E	0.71'
L2	S 57°38'24" E	4.10'
L3	N 33°29'46" E	28.00'
L4	N 31°08'40" E	24.80'
L5	N 34°52'18" E	34.58'



DEWBERRY TP #37  
 SET CAPPED REBAR  
 N: 567239.92  
 E: 1436570.94  
 ELEV: 813.10

**Dewberry**  
 Engineers Inc.  
 9300 HARRIS CORNERS PARKWAY  
 SUITE 220  
 CHARLOTTE, NC 28269-3797  
 PHONE: (704) 509-9918  
 FAX: (704) 509-9937  
 LICENSE # F-0929

NO.	DATE	BY	REVISION
1	9/24/18	MD	CORRECTED OWNER NAME

**CHARLOTTE**  
 ENGINEERING & PROPERTY  
 MANAGEMENT

**Peachtree Hills**  
 14 Sidewalk Project  
 Project Number PMES171503  
 Easement Acquisition for Parcel 14  
 CHRISTOPHER LOUIS  
 KILGANNON  
 TAX ID NO. 037-292-05  
 DB 11882 PG 294 - MB 23 PG 784  
 5402 PECANBLUFF CT  
 CHARLOTTE, MECKLENBURG, NC

PMES171503 PROJECT NUMBER	50085827 / PARCEL 14 DEWBERRY PROJECT / FILE NAME
M. DENNIS PREPARED BY	03/30/2018 DATE
1"=40' SCALE	1 OF 1 SHEET

DB 33137-411