

CURVE	RADIUS	ARC LENGTH	CHORD LENGTH	CHORD BEARING
C1	533.50'	16.72'	16.72'	S 73°07'56" W

SPECIAL NOTE:
ALL TREES AND SHRUBS IN THE EASEMENT ARE SUBJECT TO REMOVAL EXCEPT AS NOTED.

STATE OF NORTH CAROLINA
COUNTY OF MECKLENBURG

I, _____, Review Officer of Mecklenburg County, certify that the map or plat to which this certification is attached meets all statutory requirements for recording.

Review Officer _____ Date _____

039-048-01
BEVERLY A. WEAVER
DB 06799 PG 429
306 N. CLOUDMAN ST

10' ALLEY

N72°19'54"E 100.17'

200.20' TOTAL

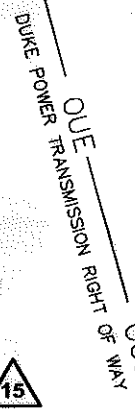

68' MAINTAINED RIGHT OF WAY PER DUKE POWER

039-048-08
SYSONG THEPPHASONE
DB 6163 PG 643
MB 332 PG 125
331 N. HOSKINS RD.

039-048-07
ERIC BYERS AND LINDA BYERS
DB 6167 PG 156
MB 332 PG 125
329 N. HOSKINS RD.

LINE	BEARING	DISTANCE
L1	N 17°47'33" W	7.14'
L2	N 17°47'33" W	7.36'
L3	N 17°47'33" W	20.51'
L4	N 72°46'40" E	24.29'
L5	S 67°05'39" E	24.40'
L6	N 73°21'52" E	57.21'
L7	S 36°03'23" E	14.89'
L8	S 17°36'40" E	12.02'
L9	N 72°02'48" E	4.65'
L10	S 17°44'14" E	26.17'
L11	S 17°44'14" E	0.13'
L12	S 17°44'14" E	6.53'
L13	S 17°44'14" E	4.10'
L14	S 17°44'14" E	7.12'
L15	N 72°14'03" E	7.53'
L16	N 74°31'02" E	75.79'
L17	N 72°48'59" E	85.60'
L18	N 68°52'23" E	14.40'

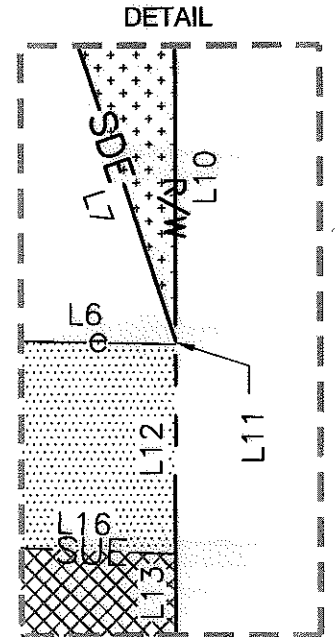

SCALE: 1"=6'



Note: Property corners shown circled were located by actual field survey. Bearings are based on N.C. State Grid North. This map was prepared for the purpose of right-of-way and/or easement acquisition only, and is not intended to be a boundary survey of the property shown. This map was prepared under my supervision.

JOHN C. GIBSON
L-4818

AREA TOTALS

Total Parcel Area	20,025 SF
Temporary Construction Easement Total	1,077 SF
Storm Drainage Easement Total(670 SF Overlaps SUE)	760 SF
Sidewalk Utility Easement Total	1,314 SF
Total Parcel Area Remaining	20,025 SF

THE LOCALIZED COORDINATE SYSTEM DEVELOPED FOR THIS PROJECT IS BASED ON THE NAD 83/01 STATE PLANE COORDINATES FOR THE NCGS MONUMENT "RESERVOIR" WITH A NORTHING OF 561874.06, EASTING OF 1434680.70. THE AVERAGE COMBINED FACTOR USED ON THIS PROJECT (GROUND TO GRID) IS .999833715. ALL LINEAR DISTANCES ARE LOCALIZED HORIZONTAL DISTANCES.

LEGEND

- Overhead Utility Easement.....OUE
- Sidewalk Utility Easement.....SUE
- Storm Drainage Easement.....SDE
- Temporary Construction Easement ... e
- Storm Drainage Easement.....
- Temporary Construction Easement ...
- Sidewalk Utility Easement.....
- SUE Overlaps SDE
- Right-of-Way.....R/W
- Existing Property Line
- Field Located Property Iron



Dewberry & Davis, Inc.
LICENSE # F-0679

6135 LAKEVIEW ROAD
SUITE 400
CHARLOTTE, NC 28269-2609
PHONE: (704) 509-9918
FAX: (704) 509-9937

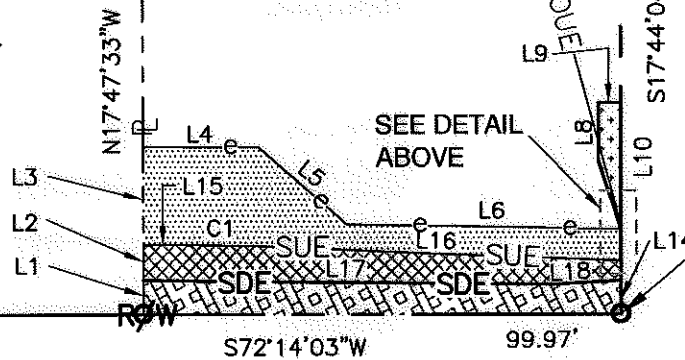
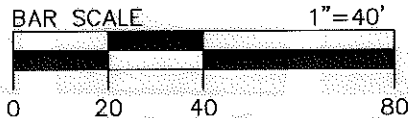

PROJECT BASELINE TIE
STA 113+09.54 L1
22.64' LT.
LOCALIZED GRID COORDINATES
N:557715.80
E:1439533.31

N. HOSKINS RD
PUBLIC R/W VARIES

NO.	DATE	BY	REVISION
1	07/19/2010	JAT	Add SUE/SDE overlap notching

 CHARLOTTE ENGINEERING & PROPERTY MANAGEMENT	Project Name North Hoskins Rd Sidewalk Project 512-08-023
	Property Owner Sysong Thepphasone Address 331 N. Hoskins Rd.
512-08-023 PROJECT NO.	1"=40' SCALE
JAT PREPARED BY	06/2010 DATE
PROJECT PATH 1 OF 1 SHEET	