

AREA TABLE	
TOTAL PARCEL AREA	18,616 SF
TOTAL TEMP CONSTRUCTION EASEMENT (TCE)	2,692 SF
TOTAL SIDEWALK/UTILITY EASEMENT (SUE)	1,046 SF
TOTAL PARCEL AREA REMAINING	18,616 SF

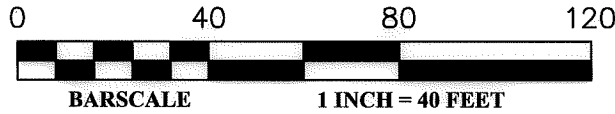

LINE	BEARING	DISTANCE
L1	S 49°10'21" E	76.16'
L2	N 41°17'07" W	22.52'
L3	S 43°24'05" E	99.10'
L4	S 43°28'29" E	99.81'

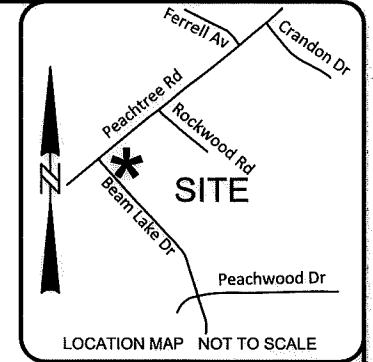
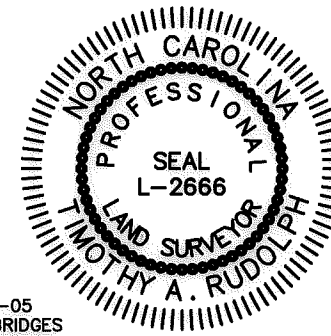

NOTE: PROPERTY CORNERS SHOWN CIRCLED WERE LOCATED BY ACTUAL FIELD SURVEY. BEARINGS ARE BASED ON N.C. STATE GRID NORTH. THIS MAP WAS PREPARED FOR THE PURPOSE OF RIGHT-OF-WAY AND/OR EASEMENT ACQUISITION ONLY, AND IS NOT INTENDED TO BE A BOUNDARY SURVEY OF THE PROPERTY SHOWN. THIS MAP WAS PREPARED UNDER MY SUPERVISION.

TIMOTHY A. RUDOLPH L-2666 03/30/2018 DATE

**LEGEND**

- SIDEWALK/UTILITY EASEMENT (SUE)
- SIDEWALK/UTILITY EASEMENT SUE
- TEMPORARY CONSTRUCTION ESMT (TCE)
- TEMPORARY CONST ESMT
- RIGHT OF WAY
- EXISTING PROPERTY LINE
- ADJOINING PROPERTY LINE
- FIELD LOCATED PROPERTY IRON
- DEED/PLAT CALL (N 03°54'33" E 83.75')

DEWBERRY TP #40  
SET CAPPED REBAR  
N 568363.83  
E 1437734.33  
ELEV: 820.60

N.C. GRID NORTH  
NAD'83

40  
039-241-09  
LOWELL D. BAILY  
and wf. EFFIE T. BAILY  
DB 3926 PG 725  
MB 6 PG 633  
1000 PEACHTREE RD

039-241-08  
ROBERT M. HARDISON  
DB 28736 PG 713  
MB 6 PG 633  
1006 PEACHTREE RD

039-241-05  
ROBERT E. BRIDGES  
BONNIE G. BRIDGES  
DB 2487 PG 482  
5509 ROCKWOOD RD

LOCALIZED GRID  
COORDINATES  
N: 568190.13  
E: 1437916.41

41  
039-241-10  
NOW OR FORMERLY  
WILLIAM R. INGLE  
and wife MILDRED B. INGLE  
DB 4323 PG 998  
MB 6 PG 633  
5514 BEAM LAKE DR

42  
039-241-11  
WILLIAM R. INGLE  
and wf. MILDRED B. INGLE  
DB 4574 PG 775  
MB 6 PG 633  
5506 BEAM LAKE DR

STATE OF NORTH CAROLINA  
COUNTY OF MECKLENBURG

I, \_\_\_\_\_ REVIEW OFFICER  
OF MECKLENBURG COUNTY, CERTIFY THAT  
THE MAP OR PLAT TO WHICH THIS  
CERTIFICATION IS ATTACHED MEETS ALL  
STATUTORY REQUIREMENTS FOR RECORDING.

REVIEW OFFICER \_\_\_\_\_ DATE \_\_\_\_\_



Dewberry  
Engineers Inc.  
LICENSE # F-0929

9300 HARRIS CORNERS PARKWAY  
SUITE 220  
CHARLOTTE, NC 28269-3797  
PHONE: (704) 509-9918  
FAX: (704) 509-9937

DEWBERRY TP #55  
SET CAPPED REBAR  
N 568056.28  
E 1437993.24  
ELEV: 808.15

DATUM DESCRIPTION:  
THE LOCALIZED COORDINATE SYSTEM DEVELOPED  
FOR THIS PROJECT IS BASED ON STATE PLANE  
COORDINATES ESTABLISHED BY: NCGS MONUMENT  
RESEVOIR NAD 83(2011) STATE PLANE COORDINATES  
OF NORTHING: 561,874.06 EASTING: 1,434,680.70  
ELEVATION: 815.25. THE AVERAGE COMBINED GRID  
FACTOR USED ON THIS PROJECT (GROUND TO GRID)  
IS: 0.999838520. VERTICAL DATUM: NAVD 88. ALL  
LINEAR DIMENSIONS ARE LOCALIZED HORIZONTAL  
DISTANCES. DATE OF SURVEY: 10/2016

NO.	DATE	BY	REVISION

**CHARLOTTE**  
ENGINEERING & PROPERTY  
MANAGEMENT

PMES171503  
PROJECT NUMBER

C. COLSON  
PREPARED BY

03/30/2018  
DATE

**Peachtree Hills**  
**41 Sidewalk Project**  
Project Number PMES171503

Easement Acquisition for Parcel 41  
**WILLIAM R. INGLE**  
and wife **MILDRED B. INGLE**  
TAX ID NO. 039-241-10  
DB 4323 PG 998-MB 6 PG 633  
5514 BEAM LAKE DR  
CHARLOTTE, MECKLENBURG, NC

50085827 / PARCEL 41  
DEWBERRY PROJECT / FILE NAME

1"=40'  
SCALE

1 OF 1  
SHEET

DB 32947-507