

I, DAVID H. SNIDER, CERTIFY THAT THIS PLAT WAS PREPARED UNDER MY SUPERVISION AND THAT THE PLAT WAS PREPARED FOR THE PURPOSE OF ACQUISITION AND EASEMENT'S ONLY, AND IS NOT INTENDED TO BE A BOUNDARY SURVEY OF PROPERTY SHOWN.

*David H. Snider*  
 DAVID H. SNIDER, NC P.L.S. L-2942 DATE 11/22/14

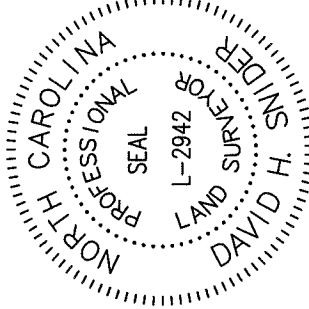

NOTE:

- 1) BEARINGS AND DISTANCE SHOWN IN PARENTHESIS ARE BASED ON RECORDED INFORMATION.
- 2) COMPUTED PROJECT DISTANCE - \* 53,678 SQ.FT.
- 3) TOTAL AREA 1,432 SQ.FT.
- 4) TEMP. CONSTRUCTION EASEMENT 1,297 SQ.FT.
- 5) SIDEWALK/UTILITY EASEMENT 21 SQ.FT.
- 6) UTILITY EASEMENT 22 SQ.FT.
- 7) FEE SIMPLE INSIDE EXISTING R/W 479 SQ.FT.
- 8) FEE SIMPLE OUTSIDE EXISTING R/W 53,177 SQ.FT.
- 9) TOTAL AREA REMAINING
- 10) SEE PAGE TWO FOR DETAIL "A", "B", LINE TABLE AND CURVE TABLE.

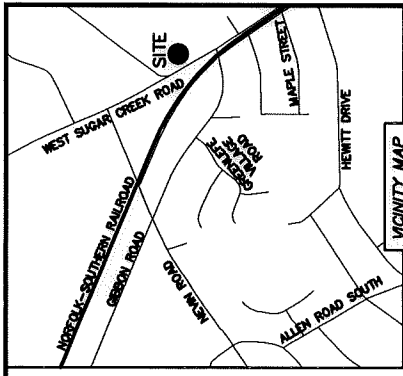

VICINITY MAP  
 "Not to scale"

04734149  
 VALAREE D. GRIER  
 DB 11311/PG 918  
 6005 FOREST POND DRIVE

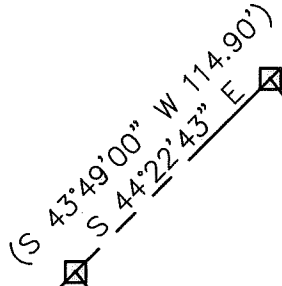

(29)  
 04704111  
 GARY WALDON PUCKETT  
 DB 5046/PG 5  
 2740 WEST SUGAR CREEK ROAD

(30)  
 04704103  
 GARY WALDON PUCKETT  
 DB 6519/PG 240  
 2734 WEST SUGAR CREEK ROAD

04704110  
 LEONARD-DERITA PROPERTIES, LLC.  
 DB 15576/PG 505  
 WEST SUGAR CREEK

DETAIL A:  
 (SEE PAGE TWO)

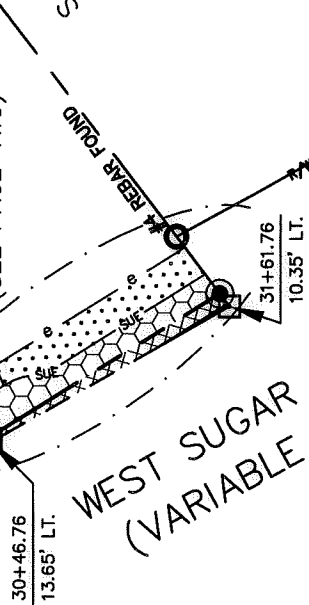

WEST SUGAR CREEK ROAD  
 (VARIABLE PUBLIC R/W)

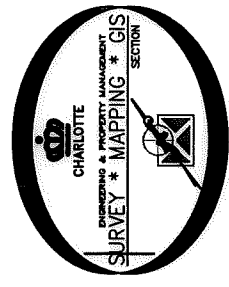

STATE OF NORTH CAROLINA  
 COUNTY OF MECKLENBURG

REVIEW OFFICER \_\_\_\_\_ DATE \_\_\_\_\_  
 I, \_\_\_\_\_ REVIEW OFFICER OF MECKLENBURG COUNTY, CERTIFY THAT THE MAP OR PLAT TO WHICH THIS CERTIFICATION IS AFFIXED MEETS ALL STATUTORY REQUIREMENTS FOR RECORDING.

LEGEND

- REBAR OR IRON PIN FOUND
- #5 REBAR SET OR MAG. NAIL
- COMPUTED POINT
- PROPERTY LINES
- EXISTING RIGHT-OF-WAY
- EXISTING R/W BY MAINTENANCE
- NEW RIGHT-OF-WAY
- FEE SIMPLE INSIDE EXIST R/W
- FEE SIMPLE OUTSIDE EXIST R/W
- TEMP. CONSTRUCTION EASEMENT
- SIDEWALK/UTILITY EASEMENT
- UTILITY EASEMENT

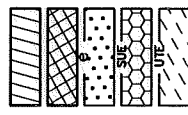

PREPARED BY:  
 CITY OF CHARLOTTE  
 ENGINEERING & PROPERTY MANAGEMENT DEPARTMENT  
 600 EAST FOURTH STREET  
 CHARLOTTE, NC 28202  
 704-336-2291

		CHARLOTTE ENGINEERING & PROPERTY MANAGEMENT DEPARTMENT	
		NEVIN RD-GIBBON RD SIDEWALK PROJECT	JOB NO. 512-09-056 FILE NO. 047-041-03
REVISIONS	SCALE 1"=60' DRAWN BY LG DATE	PROPERTY ACQUISITION OWNER: GARY WALDON PUCKETT CHARLOTTE, MECKLENBURG CO., NC	SHEET 1 OF 2
K:\AUTOCAD\EN_SU-LD4\209056\DWG\NEVINRD-GIBBONSDRAWPLATS-CSD2012.DWG		CHECKED BY DHS SURVEY SUPVR.	

DB 30496-533

I, DAVID H. SNIDER, CERTIFY THAT THIS PLAT WAS PREPARED UNDER MY SUPERVISION AND THAT THE PLAT WAS PREPARED FOR THE PURPOSE OF ACQUISITION AND EASEMENTS ONLY, AND IS NOT INTENDED TO BE A BOUNDARY SURVEY OF PROPERTY SHOWN.

*David H. Snider*  
 DAVID H. SNIDER, NC P.L.S. L-2942 DATE

STATE OF NORTH CAROLINA  
 COUNTY OF MECKLENBURG

I, \_\_\_\_\_ REVIEW OFFICER OF MECKLENBURG COUNTY, CERTIFY THAT THE MAP OR PLAT TO WHICH THIS CERTIFICATION IS AFFIXED MEETS ALL STATUTORY REQUIREMENTS FOR RECORDING.

REVIEW OFFICER \_\_\_\_\_ DATE \_\_\_\_\_

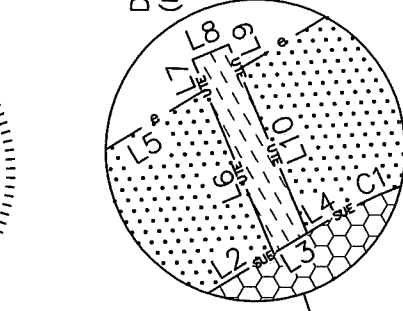
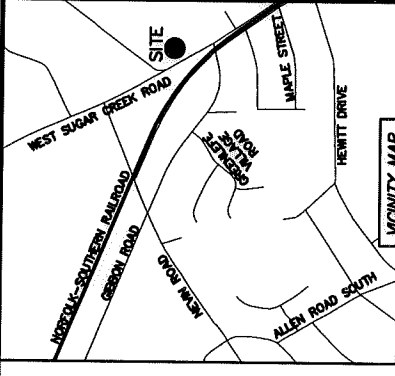
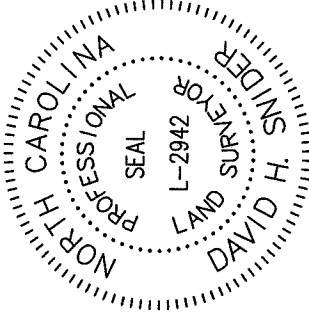

DETAIL B:  
 (NOT TO SCALE)

SEE DETAIL B:

(30)  
 04704103  
 GARY WALDON PUCKETT  
 DB 6519/PG 240  
 2734 WEST SUGAR CREEK ROAD

WEST SUGAR CREEK ROAD  
 (VARIABLE PUBLIC R/W)

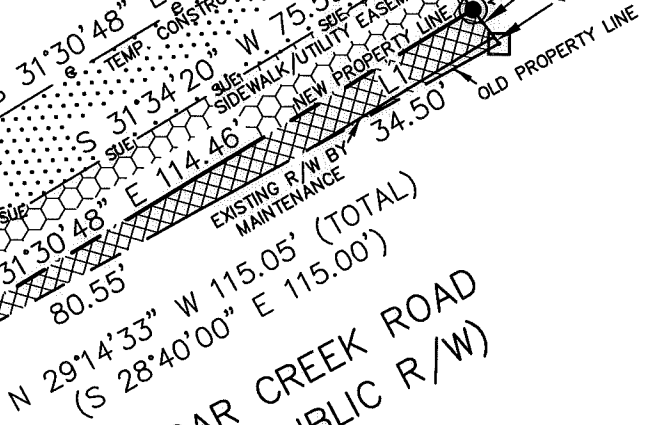

DETAIL A:

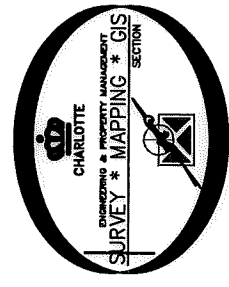

CURVE TABLE		
CURVE	RADIUS & ARC	CHORD
C1	R=27.00 L=12.98'	S 17°44'17" E 12.86'
C2	R=17.00 L=8.19'	S 17°46'03" E 8.11'

LEGEND

- REBAR OR IRON PIN FOUND
- #5 REBAR SET OR MAG. NAIL
- COMPUTED POINT
- PROPERTY LINES
- EXISTING RIGHT-OF-WAY
- NEW RIGHT-OF-WAY
- FEE SIMPLE INSIDE EXIST R/W
- FEE SIMPLE OUTSIDE EXIST R/W
- TEMP. CONSTRUCTION EASEMENT
- SIDEWALK/UTILITY EASEMENT
- UTILITY EASEMENT
- PREPARED BY:
- CITY OF CHARLOTTE
- ENGINEERING & PROPERTY MANAGEMENT DEPARTMENT
- 600 EAST FOURTH STREET
- CHARLOTTE, NC 28202
- 704-336-2291

LINE TABLE		
LINE	LENGTH	BEARING
L1	34.33'	S 31°25'00" E
L2	16.53'	S 31°30'48" E
L3	2.02'	S 31°30'48" E
L4	0.50'	S 31°30'48" E
L5	18.83'	S 31°30'48" E
L6	9.09'	N 66°41'38" E
L7	1.66'	N 66°41'38" E
L8	2.00'	S 23°18'22" E
L9	1.37'	S 66°41'38" W
L10	9.09'	S 66°41'38" W

ENGINEERING & PROPERTY MANAGEMENT DEPARTMENT  
 CHARLOTTE

REVISIONS

SCALE 1"=30'

DRAWN BY LG

DATE

JOB NO. 512-09-056

FILE NO. 047-041-03

SHEET 2 OF 2

PROPERTY ACQUISITION

OWNER: GARY WALDON PUCKETT

CHARLOTTE, MECKLENBURG CO., NC

CHECKED BY DHS SURVEY SUPR.

K:\AUTOCAD\EN\_SU-LD4\209056\DWG\NEVINROAD-GIBBONSROADPLATS-CSD2012.DWG

DB 30496-533