

NORTH TRYON ST. (U.S. HWY. 29 & N.C.49)  
(PUBLIC R/W VARIES)

ELBERT ASSOC.  
TAX CODE: 049-181-04  
DB 5909 PG 840  
DB 4567 PG 224  
DB 4796 PG 707  
DB 4865 PG 230  
LESS R/W DB 1503 PG 185  
7226 N TRYON ST



I, DAVID H. SNIDER, CERTIFY THAT THIS PLAT WAS PREPARED UNDER MY SUPERVISION AND THAT THE PLAT WAS PREPARED FOR THE PURPOSE OF ACQUISITION AND EASEMENTS ONLY, AND IS NOT INTENDED TO BE A BOUNDARY SURVEY OF PROPERTY SHOWN.  
*David H. Snider* 12/02/08  
DAVID H. SNIDER, NC P.L.S. L-2942 DATE

JOHN B. YOUNG  
TAX CODE: 049-141-19  
DB 5926 PG 782  
7140 N. TRYON ST.  
S60°48'07"E (S60°47'05"E) (80.55')  
S60°46'13"E (S60°47'05"E) 300.00'  
N37°56'55"E 299.85'  
N38°08'45"E (N38°08'45"E) (104.50')

ROCKY NAD83  
N 565174.49  
E 1475764.55  
GRID FACTOR = 0.9998410

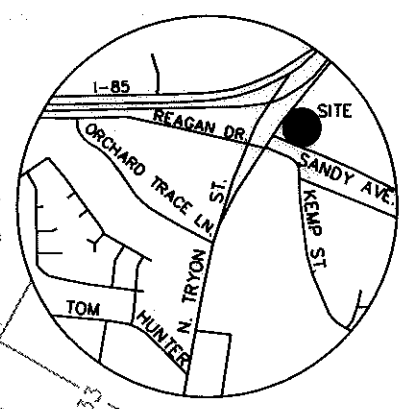

N38°27'05"E 706.82'  
(N38°08'45"E 464.64' total)

SEE SHEET 2 OF 2 FOR DETAIL "B"

JOHN B. YOUNG  
TAX CODE: 049-141-20  
DB 5926 PG 853  
LESS DB 9966 PG 454

NC GRID, NAD 1983  
N 563131.99  
E 1475796.35

SEE SHEET 2 OF 2 FOR DETAIL "A"

S25°14'48"W (S24°41'00"W) (75.00')  
N67°06'00"W 487.50' total  
N66°49'47"W

SANDY AVE. (R/W VARIES)

N75°31'57"W (N75°41'20"W 695.38')

N70°26'41"W (N70°33'25"W 328.51')

S48°38'44"W (S47°31'47"W 466.15')

PREPARED BY:  
CITY OF CHARLOTTE  
ENGINEERING DEPARTMENT  
600 EAST FOURTH STREET  
CHARLOTTE, NC 28202  
704-336-2291

		CHARLOTTE ENGINEERING & PROPERTY MANAGEMENT	
REVISIONS		<b>NC. 49 / US 29 INTERCHANGE RECONSTRUCTION</b>	JOB NO. 512-99-009
3. (11-08-08) REVISED			FILE NO. LAN #289009
2. (10-01-03) REVISED TOE			PLAT-42.dwg
1. (10-01-03) ADDED UE		OWNER: JOHN B. YOUNG TAX CODE: 049-141-20 CHARLOTTE, MECKLENBURG CO., NC	SHEET 1
SCALE 0 1" = 200'		DRAWN BY G.F.	OF 2
DATE		CHECKED BY	SURVEY SUPV. <i>DHS</i>

Sta. "Y2"  
119+80.18  
113.76' RT.

# DETAIL "A" N.T.S.

I, DAVID H. SNIDER, CERTIFY THAT THIS PLAT WAS PREPARED UNDER MY SUPERVISION AND THAT THE PLAT WAS PREPARED FOR THE PURPOSE OF ACQUISITION AND EASEMENTS ONLY, AND IS NOT INTENDED TO BE A BOUNDARY SURVEY OF PROPERTY SHOWN.

*David H. Snider 12/02/08*  
DAVID H. SNIDER, NC P.L.S. L-2942 DATE

LINE TABLE		
LINE	LENGTH	BEARING
L1	105.87	N58°09'40"W
L2	73.75	N56°23'32"W
L3	10.12	N30°54'47"E
L4	30.00	N59°05'13"W
L5	9.62	S30°54'47"W
L6	57.77	N66°43'43"W
L7	100.08	N72°05'23"W
L8	18.61	S81°56'58"W
L9	91.20	S60°36'44"E
L10	101.87	S66°14'25"E
L11	4.96	S25°14'48"W
L12	12.15	S25°14'48"W

OLD PROPERTY LINE  
NEW PROPERTY LINE

## LEGEND

- NCGS CONTROL MONUMENT
- IRON PIN FOUND
- IRON PIN SET #6 rebar & cap
- FEE SIMPLE OUTSIDE R/W
- FEE SIMPLE INSIDE R/W
- TEMPORARY CONSTRUCTION EASEMENT
- STORM DRAINAGE EASEMENT
- LINES SURVEYED
- LINES NOT SURVEYED

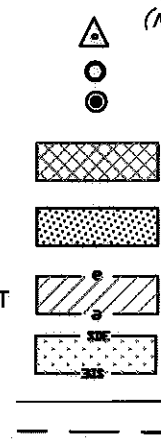

State of North Carolina  
County of Mecklenburg

I, \_\_\_\_\_, Review Officer of Mecklenburg County, certify that the map or plat to which this certification is affixed meets all statutory requirements for recording.

Review Officer \_\_\_\_\_ Date \_\_\_\_\_



Sta. "Y7"  
15+14.33  
22.05' LT.

TEMPORARY CONSTRUCTION EASEMENT

ACQUISITION BY OR 24892 PL 920

### NOTE:

- 1) BEARINGS AND DISTANCES SHOWN IN PARENTHESES ARE BASED ON RECORDED MAP INFORMATION.
- 2) TOTAL AREA 1,253,227 SQ.FT.
- 3) FEE SIMPLE OUTSIDE R/W 3,252 SQ.FT.
- 4) FEE SIMPLE INSIDE R/W 5,797 SQ.FT.
- 5) TEMPORARY CONSTRUCTION EASEMENT 1,897 SQ.FT.
- 6) STORM DRAINAGE EASEMENT 6,936 SQ.FT.
- 7) AREA REMAINING 1,244,178 SQ.FT.

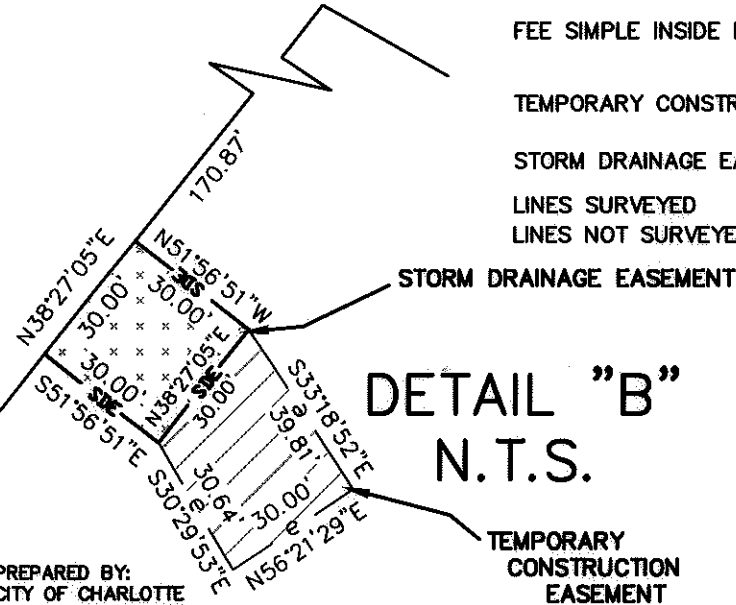

PREPARED BY:  
CITY OF CHARLOTTE  
ENGINEERING DEPARTMENT  
600 EAST FOURTH STREET  
CHARLOTTE, NC 28202  
704-336-2291



REVISIONS		NC. 49 / US 29 INTERCHANGE RECONSTRUCTION	JOB NO. 512-99-009
3.	(11-05-08) REVISED		
2.	(10-01-03) REVISED TCE	SHEET 2	
1.	(10-01-03) ADDED LIE		OF 2
SCALE 0' N.T.S. 0'			
DRAWN BY G.F.		CHECKED BY	SURVEY SUPVR. <i>JLL</i>
DATE			