

161

NAD 83/2001
COORDINATES
N 558,562.07
E 1,419,410.59

DAPHNE M. BLOUNT
TAX CODE: 055-159-50
DB 6425 PG 414

LINE	LENGTH	BEARING
L1	44.72	S77°28'27"E
L2	16.66	S32°28'27"E
L3	44.31	S77°28'27"E
L4	39.69	N51°54'58"E
L5	60.11	N51°54'58"E
L6	5.00	S38°05'02"E
L7	44.17	S77°28'27"E
L8	16.66	S32°28'27"E
L9	48.75	S77°28'27"E
L10	159.03	N51°54'58"E
L11	102.16	N51°54'58"E
L12	7.17	N57°31'33"E
L13	44.79	S77°28'27"E
L14	2.42	N57°31'33"E
L15	38.56	S77°28'27"E
L16	8.84	S67°41'02"E
L17	0.69	N22°54'42"E

LINDA K. BLAKE
CATHERINE H. BLAKE
TAX CODE: 055-159-51
DB 17336 PG 988
(S28°19'25"W 115.00' total)
94.07'

- NOTE:
- 1) BEARINGS AND DISTANCES SHOWN IN PARENTHESES ARE BASED ON RECORDED MAP INFORMATION.
 - 2) COMPUTED PROJECT DISTANCE _____*
 - 3) TCE OVERLAPS EXISTING DRAINAGE & UTILITY EASEMENTS PER MB 14 PG 565 156 SQ.FT
 - 4) SDE OVERLAPS EXISTING DRAINAGE & UTILITY EASEMENTS PER MB 14 PG 565 1,498 SQ.FT
 - 5) TOTAL AREA 26,876 SQ.FT.
 - 6) TEMP. CONSTRUCTION EASEMENT 1,275 SQ.FT.
 - 7) STORM DRAINAGE EASEMENT 3,206 SQ.FT.
 - 8) AREA REMAINING 26,876 SQ.FT.

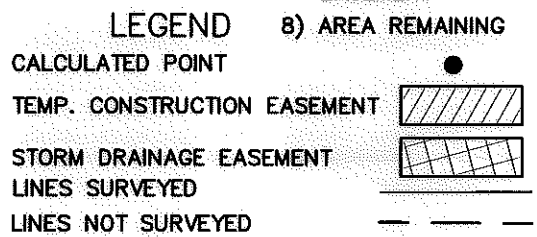

SHACOBI D. MCCORKLE
TAX CODE: 055-155-38
DB 15608 PG 626
6738 WILD TURKEY LANE

I, DAVID H. SNIDER, CERTIFY THAT THIS PLAT WAS PREPARED UNDER MY SUPERVISION AND THAT THE PLAT WAS PREPARED FOR THE PURPOSE OF EASEMENTS ONLY, AND IS NOT INTENDED TO BE A BOUNDARY SURVEY OF PROPERTY SHOWN.

David H. Snider 2/13/11
DAVID H. SNIDER, NC P.L.S. L-2942 DATE



SHANE E. HELMS
TAX CODE: 055-155-39
DB 19313 PG 283
6742 WILD TURKEY LANE

WILD TURKEY LANE
50' RADIUS

L=45.00' total
R=50.00'
S11°57'29"E
CH=43.50

L=7.53'
R=50.00'
S33°25'45"E
CH=7.52

State of North Carolina
County of Mecklenburg

I, _____, Review Officer of Mecklenburg County, certify that the map or plat to which this certification is affixed meets all statutory requirements for recording.

Review Officer _____ Date _____

PAUL W. FULLER
KATHRYN A. FULLER
TAX CODE: 055-155-40
DB 5562 PG 706
6735 WILD TURKEY LANE

127
RICHARD V. BARBER
ANITA N. BARBER
TAX CODE: 055-159-53
DB 7128 PG 810

PREPARED BY:
CITY OF CHARLOTTE
ENGINEERING & PROPERTY MANAGEMENT
600 EAST FOURTH STREET
CHARLOTTE, NC 28202
704-336-2291

CARL RICHARD SWITZER
KAY TEMPLE SWITZER
TAX CODE: 055-155-47
DB 17130 PG 339

ANDREA M. CURRENCE
TAX CODE: 055-155-46
DB 8137 PG 433

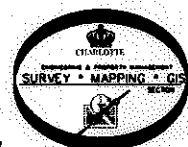

		JOB NO. 512-08-052	
REVISIONS		FILE NO. LAN #208052	
PAWTUCKETT NIP		OWNER: SHANE E. HELMS TAX CODE: 055-155-39 CHARLOTTE, MECKLENBURG CO., NC	
SCALE 1" = 30'		SHEET 1	
DRAWN BY G.F.		OF 1	
DATE		CHECKED BY SURVEY SUPVR. <i>DSU</i>	
K:\AUTOCAD\en_su-1d4\lan.208052 PHASE 2\PLAT MAPS and THERE INFORMATION\Plat-125			

ACQUISITION BY DB 26882 PG 690