

I, W. ANDREW EADES, CERTIFY THAT THIS PLAT WAS PREPARED UNDER MY SUPERVISION AND THAT THE PLAT WAS PREPARED FOR THE PURPOSE OF ACQUISITION AND EASEMENTS ONLY, AND IS NOT INTENDED TO BE A BOUNDARY SURVEY OF PROPERTY SHOWN.

W. Andrew Eades N.C.P.L.S. L-3413 DATE 10-11-05

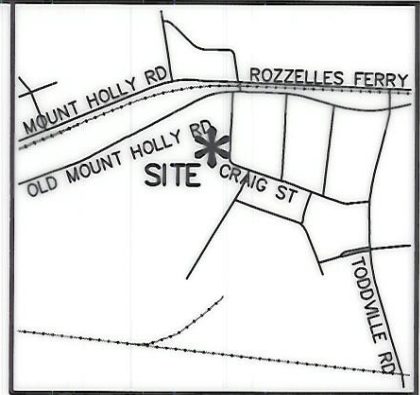

VICINITY MAP (NOT TO SCALE)

State of North Carolina
County of Mecklenburg

I, _____, Review Officer of Mecklenburg County, certify that the map or plat to which this certification is affixed meets all statutory requirements for recording.

Review Officer _____ Date _____

ACQUISITION BY CITY
RECORDED IN DEED BOOK

20179 PG 750
DATE _____

LEGEND

- IRON PIN FOUND
- STORM DRAINAGE EASEMENT

1" = 40'

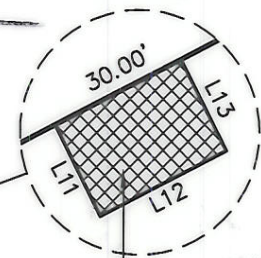

STORM DRAINAGE EASEMENT

LINE TABLE		
LINE	LENGTH	BEARING
(L1)	153.68	S19°01'20"E
(L2)	134.08	S15°14'41"E
(L3)	179.91	S32°40'15"E
(L4)	181.00	S57°19'45"W
(L5)	230.00	N32°40'15"W
(L6)	181.00	N57°19'45"E
(L7)	85.80	N15°14'41"W
(L8)	150.90	N19°01'20"W
(L9)	187.05	N87°11'26"W
(L10)	27.62	N87°11'26"W
L11	21.24	N27°02'37"W
L12	30.00	S62°57'23"W
L13	21.37	S27°02'37"E



25
057-151-10
AL B. MORVAN
PB 27 PG 96
DB 9252 PG 900
6801 OLD MT HOLLY RD

NOTE:

- 1) BEARINGS AND DISTANCES SHOWN IN PARENTHESES ARE BASED ON RECORDED MAP INFORMATION.
- 2) STORM DRAINAGE EASEMENT 639 SQ.FT.

PREPARED BY:
MFKIM & CREED

ENGINEERS, PLANNERS, SURVEYORS
2300 SARDIS ROAD NORTH, SUITE A
CHARLOTTE, NORTH CAROLINA 28227
PHONE (704) 841-2588
FAX (704) 841-2567

NC GRID NAD83

CHARLOTTE ENGINEERING & PROPERTY MANAGEMENT		
REVISIONS	FRED D. ALEXANDER BLVD., SECTION B	JOB NO. 512-01-004
	PROPERTY ACQUISITION OWNER: AL B. MORVAN CHARLOTTE, MECKLENBURG CO., NC	FILE NO.
SCALE 1" = 200'		SHEET 1
DRAWN BY: WRH		OF 1
DATE 11/04/04	CHECKED BY WAE	SURVEY SUPVR.