

CURVE TABLE						
CURVE	LENGTH	TANGENT	RADIUS	BEARING	CHORD	DELTA
C1	146.55	73.40	1005.00	N53°05'25"E	146.42	8°21'17"
C2	172.08	86.30	900.29	S60°34'25"W	171.82	10°57'05"

LINE TABLE		
LINE	LENGTH	BEARING
L1	15.00	N12°41'56"E
L2	106.00	S77°18'04"E
L3	15.00	S12°41'56"W
L4	106.00	N77°18'04"W

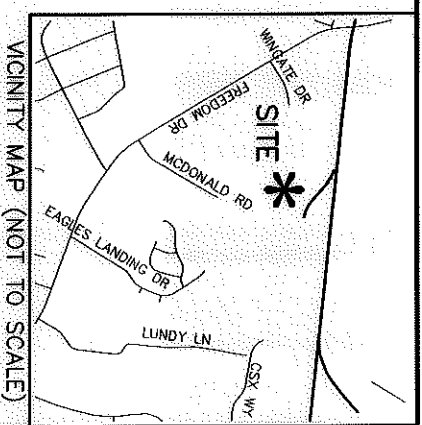

FOR EXHIBIT PURPOSES ONLY

057-212-04
CITY OF CHARLOTTE
DB 11630 PG 340
7033 OLD MT HOLLY RD

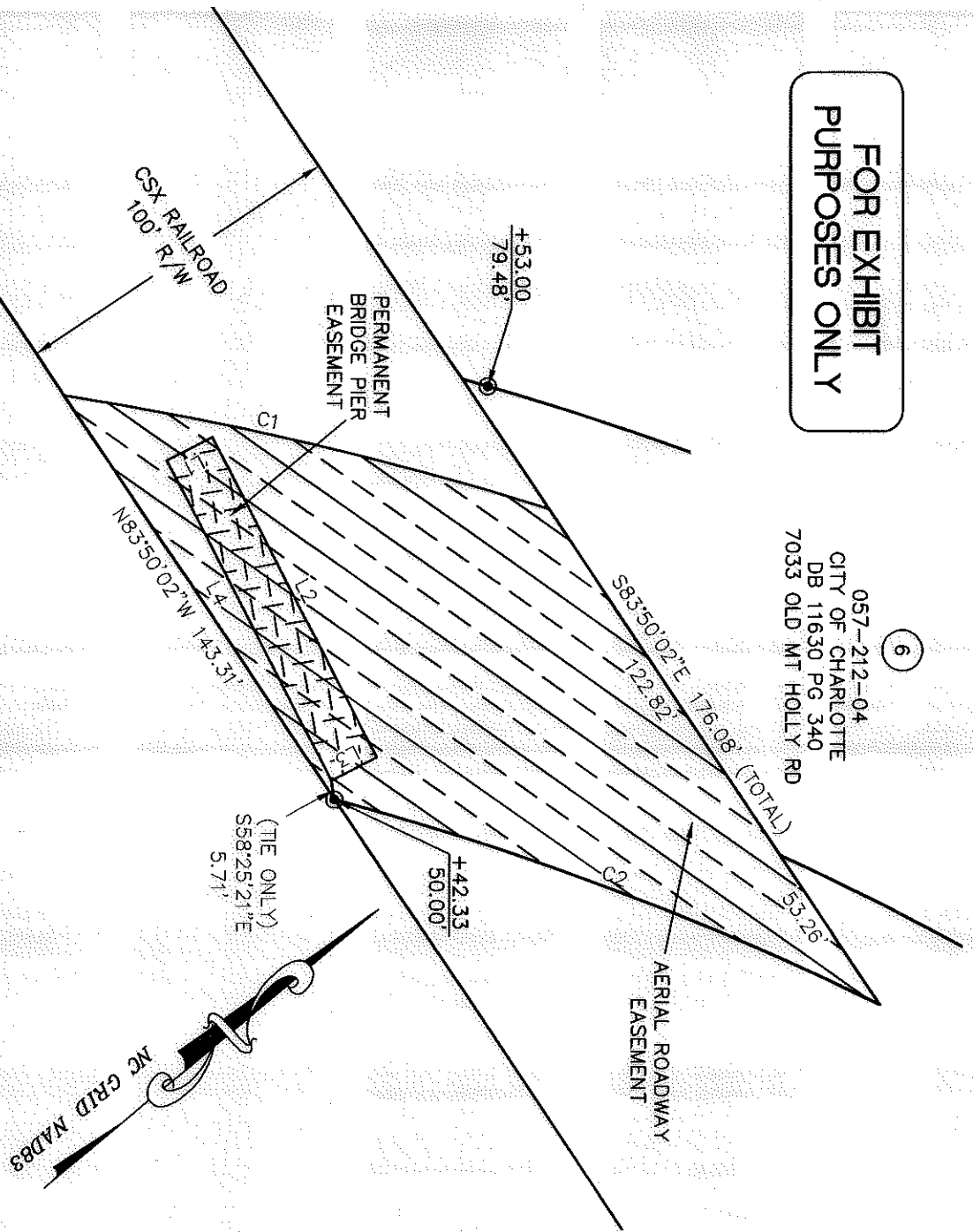

4

NOTE:

- 1) BEARINGS AND DISTANCES SHOWN IN PARENTHESES ARE BASED ON RECORDED MAP INFORMATION.
- 2) AERIAL ROADWAY EASEMENT 15,759 SQ.FT.
- 3) PERMANENT BRIDGE PIER EASEMENT 1,590 SQ.FT.

- LEGEND**
- IRON PIN FOUND
 - #5 REBAR SET
 - ▨ AERIAL ROADWAY EASEMENT
 - ▤ PERMANENT BRIDGE PIER EASEMENT

PREPARED BY:
MCKIM & CREED
ENGINEERS, PLANNERS, SURVEYORS
8020 TOWER POINT DRIVE
CHARLOTTE, NORTH CAROLINA 28227
PHONE (704) 841-2588
FAX (704) 841-2567

		CHARLOTTE	
		ENGINEERING & PROPERTY MANAGEMENT	
REVISIONS		FRED D. ALEXANDER BLVD., SECTION B	
		EXHIBIT OF CSX RAILROAD	
DATE 03/31/09	DRAWN BY: WRH	CHECKED BY: JMM	SURVEY SUPR.
JOB NO. 512-01-004	FILE NO.	SHEET 1 OF 1	