

DB 26229 PG 64

I, DAVID A. WEIRICH, CERTIFY THAT THIS PLAT WAS PREPARED UNDER MY SUPERVISION AND THAT THE PLAT WAS PREPARED FOR THE PURPOSE OF RIGHT OF WAY OR EASEMENT ACQUISITION ONLY, AND IS NOT INTENDED TO BE A BOUNDARY SURVEY OF THE PROPERTY SHOWN.

5/6/10
DATE
David A. Weirich, PLS
L-3846
1 of 2

- LEGEND**
- ⊕ - CENTERLINE
 - - PROPERTY LINE
 - R/W - RIGHT-OF-WAY
 - EIP - EXISTING IRON PIPE
 - - - PROPOSED NEW RIGHT-OF-WAY LINE
 - EP - EDGE OF PAVEMENT
 - (T) - TOTAL
 - e - TEMPORARY CONSTRUCTION EASEMENT LINE
 - UE - UTILITY EASEMENT
 - [Hatched] - AREA TO BE ACQUIRED OUTSIDE EXISTING R/W
 - [Diagonal] - AREA TO BE ACQUIRED INSIDE EXISTING R/W
 - [Dotted] - TEMPORARY CONSTRUCTION EASEMENT (T.C.E.)
 - [Cross-hatched] - UTILITY EASEMENT

AREA TABLE	
TOTAL AREA (AS PER DEED)	55,047 SQ. FT.
AREA TO BE ACQUIRED INSIDE EXISTING R/W	1,172 SQ. FT.
AREA TO BE ACQUIRED OUTSIDE EXISTING R/W	2,609 SQ. FT.
TEMPORARY CONSTRUCTION EASEMENT	869 SQ. FT.
UTILITY EASEMENT	439 SQ. FT.
REMAINING AREA	51,266 SQ. FT.

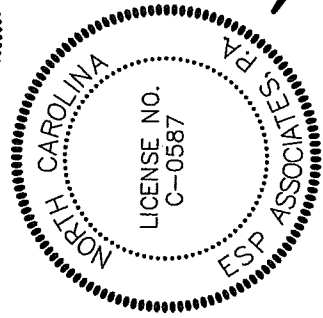
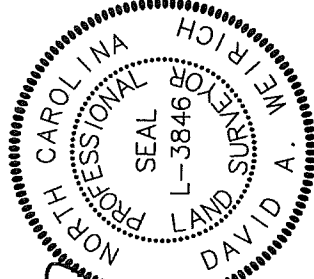

State of North Carolina
County of Mecklenburg

I, _____, Review Officer of Mecklenburg County, certify that the map or plat to which this certification is affixed meets all statutory requirements for recording.

Date _____ Review Officer _____

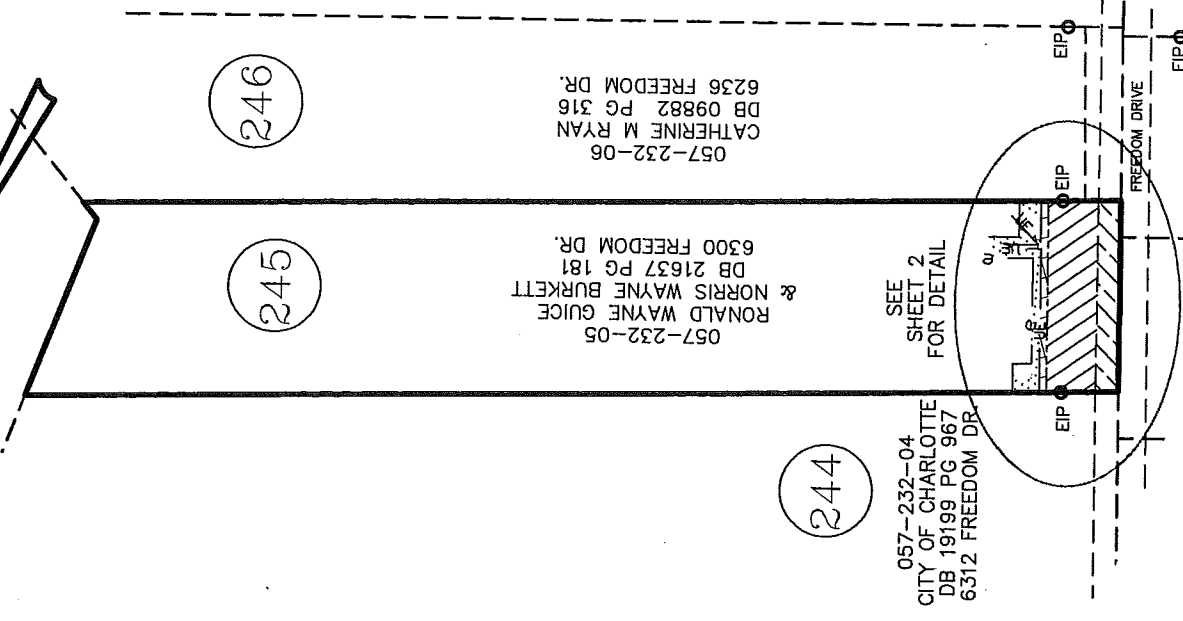
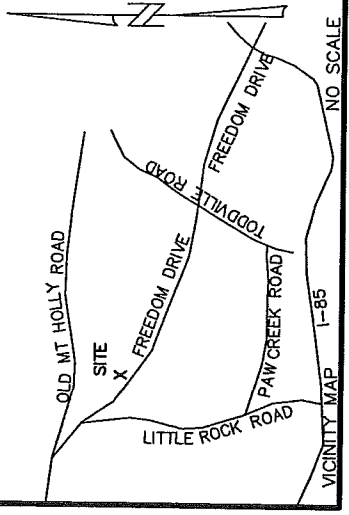
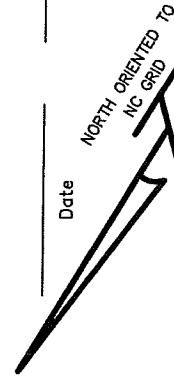

057-232-04
CITY OF CHARLOTTE
DB 19199 PG 967
6312 FREEDOM DR

057-232-05
RONALD WAYNE GUICE
&
NORRIS WAYNE BURKETT
DB 21637 PG 181
6300 FREEDOM DR.

057-232-06
CATHERINE M RYAN
DB 09882 PG 316
6236 FREEDOM DR.

SEE SHEET 2 FOR DETAIL

NOTE
This map was prepared for the purpose of right-of-way or easement acquisition only, and is not intended to be a boundary survey of the property shown. Boundary information taken from deed. (DB 21637 PG 181)

THIS DRAWING AND/OR THE DESIGN SHOWN ARE THE PROPERTY OF ESP ASSOCIATES, P.A. THE REPRODUCTION, ALTERATION, COPYING OR OTHER USE OF THIS DRAWING WITHOUT THEIR WRITTEN CONSENT IS PROHIBITED AND ANY INFRINGEMENT WILL BE SUBJECT TO LEGAL ACTION.
ESP ASSOCIATES, P.A.



ESP Associates, P.A.
P.O. Box 7030 3475 Lakemont Blvd.
Charlotte, NC 28241 Fort Mill, SC 29708
704-553-4949 (NC)
803-802-2440 (SC)
www.espassociates.com

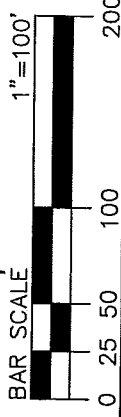

CHARLOTTE
ENGINEERING DEPARTMENT

FREEDOM DRIVE INTERSECTION PROJECT

PROPERTY ACQUISITION
OWNER: RONALD W. GUICE
& NORRIS W. BURKETT
CHARLOTTE, MECKLENBURG CO., NC

512-99-007 Job No.	PB06-245 File No.
PLAN Scales 1" = 100'	Her. NA Vert. NA
As Built	Date
ESP Surveyed By	LKJ Drawn By
	Designed By
	Project-Engr.
	DAW Approved By
	Date
	Sheet of
	1
	2

No.	Date	By	Revision
3	5-6-10	LKJ	REVISE EASEMENT
2	4-14-10	LKJ	FIX DETAIL
1	4-9-10	LKJ	CLIENT COMMENT