

BROWNS AVENUE  
(60' PUBLIC R/W)  
(N 22°09'30" E 100.00')  
(N 21°59'16" E 99.88')

LINE	DIRECTION	LENGTH
L1	S 45°48'12" W	26.45'
L2	S 24°40'27" W	21.07'
L3	S 19°08'32" W	27.71'
L4	S 34°44'38" E	20.79'
L5	N 58°22'17" W	25.64'
L6	N 25°22'42" W	44.44'
L7	N 38°19'03" W	11.18'

05902302  
CAMP PROPERTIES LLC  
DB 13796/PG 370  
1713 BROWNS AVENUE

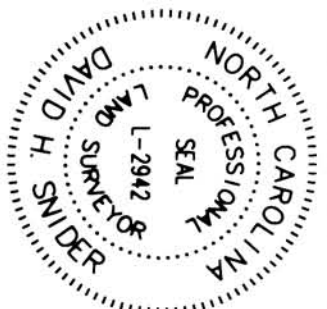

I, DAVID H. SNIDER, CERTIFY THAT THIS PLAT WAS PREPARED UNDER MY SUPERVISION AND THAT THE PLAT WAS PREPARED FOR THE PURPOSE OF ACQUISITION AND EASEMENTS ONLY, AND IS NOT INTENDED TO BE A BOUNDARY SURVEY OF PROPERTY SHOWN.  
*David H. Snider*  
DAVID H. SNIDER, NC P.L.S. L-2942 DATE

05902305  
JAYNE INFANZON  
DB 16060/PG 940  
4712 TUCKASEEGE ROAD

⑤

VICINITY MAP NTS

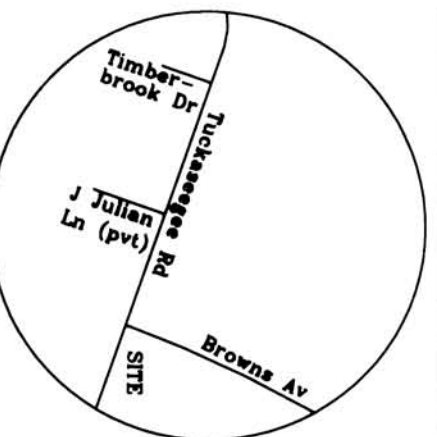

LEGEND  
IRON PIN FOUND  
DETENTION EASEMENT

STATE OF NORTH CAROLINA  
COUNTY OF MECKLENBURG

REVIEW OFFICER OF MECKLENBURG COUNTY, CERTIFY THAT THE MAP OR PLAT TO WHICH THIS CERTIFICATION IS AFFIXED MEETS ALL STATUTORY REQUIREMENTS FOR RECORDING.

REVIEW OFFICER DATE

05902322  
JAYNE INFANZON  
DB 14292/PG 979  
TUCKASEEGE ROAD

④

- NOTES:  
1) BEARINGS AND DISTANCES SHOWN IN PARENTHESES ARE BASED ON RECORDED MAP INFORMATION  
2) TOTAL AREA 0.591 ACRES  
3) DETENTION EASEMENT 0.103 ACRES  
4) AREA REMAINING 0.591 ACRES

CHARLOTTE

ENGINEERING DEPARTMENT

EDGEWOOD

STORM WATER PROJECT

EASEMENT ACQUISITION

OWNER: OPHELIA MAE JOHNSON

CHARLOTTE, MECKLENBURG COUNTY, NC

CHECKED BY: DHS  
DATE: 04-05-2008

REVISIONS	JOB NO.	396609
STORM WATER	FILE NO.	059-023-03
SCALE 1" = 30'	SHEET	1
DRAWN BY: LG	OF	1
DATE: 04-05-2008		
PROJECT LOCATION: K. VAULT ROAD (FR. S)-104		

05902319  
BUTTON PARTNERS  
DB 6563/PG 592  
1727 BROWNS AVENUE



PREPARED BY:  
CITY OF CHARLOTTE  
ENGINEERING & PROPERTY MANAGEMENT  
600 EAST FOURTH STREET  
CHARLOTTE, NC 28202  
TEL: 704-336-2291

05902303  
OPHELIA MAE JOHNSON  
DB 6461/PG 26  
1723 BROWNS AVENUE

③

(S 67°50'10" E 228.00')  
(S 68°06'37" E 228.18')

(N 67°49'50" W 287.38' - TOTAL)  
1' PIPE  
29.32'

N 68°03'58" W 1108.12'  
N 68°07'09" W 150.00'  
N 68°07'09" W 150.00'

05902318  
JERRY H. PETTUS SR.  
DB 4895/PG 80  
4746 TUCKASEEGE ROAD

②

Easement DB 21055-809