

I, JACKIE W. BRIM, CERTIFY THAT THIS PLAT WAS PREPARED UNDER MY SUPERVISION AND THAT THE PLAT WAS PREPARED FOR THE PURPOSE OF ACQUISITION AND EASEMENTS ONLY, AND IS NOT INTENDED TO BE A BOUNDARY SURVEY OF PROPERTY SHOWN.

Jackie W. Brim 11-3-2016
 JACKIE W. BRIM, NC P.L.S. L-4348 DATE

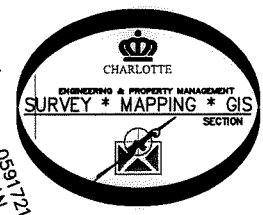
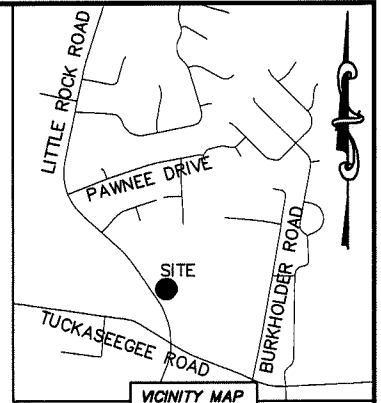
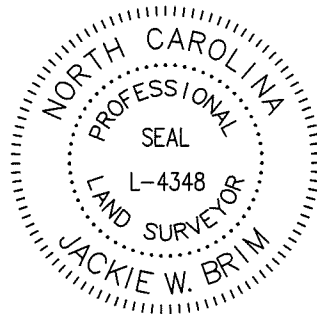

MAG. NAIL
 NC GRID NAD 83 (2011)
 N: 553,778.78 FEET
 E: 1,420,651.51 FEET
 CGF: 0.9998415

05918305
 MARSHA H. SMITH
 DB 21378/PG 229
 2111 LINALDA COURT

05918317
 JENNIFER V. BELIS
 DB 24895/PG 550
 2126 ARAPAHO DRIVE

05918410
 ROGER L. MARKS AND
 WIFE CATHY L. MARKS
 DB 11204/PG 659
 2121 ARAPAHO DRIVE

05918306
 GERALD J. BEARDEN AND
 WIFE SARAH B. BEARDEN
 DB 4079/PG 436
 2121 LINALDA COURT

05917202
 NAI TINA TOUPRONG HOLE
 DB 18895/PG 311
 2133 LITTLE ROCK ROAD

05917203
 LINDA SCOTT
 DB 29565/PG 324
 2211 LITTLE ROCK ROAD

N 89°57'25" E 631.17'
 (S 89°29'30" E)

05917216
 JONATHAN DEESE
 DB 13341/PG 697
 BURKHOLDER ROAD

05917226
 TIMOTHY W. ALVIS AND
 WIFE DALE N. ALVIS
 DB 8046/PG 896
 BURKHOLDER ROAD

NOTE:

- 1) BEARINGS AND DISTANCE SHOWN IN PARENTHESIS ARE BASED ON RECORDED INFORMATION.
- 2) COMPUTED PROJECT DISTANCE - *
- 3) TOTAL AREA 806,580± SQ.FT.
- 4) TEMP. CONSTRUCTION EASEMENT 5,665 SQ.FT.
- 5) SIDEWALK/UTILITY EASEMENT 2,343 SQ.FT.
- 6) UTILITY EASEMENT 25 SQ.FT.
- 7) FEE SIMPLE OUTSIDE EXISTING R/W 1,528 SQ.FT.
- 8) TOTAL AREA REMAINING 805,052± SQ.FT.
- 9) SEE PAGE TWO FOR DETAIL "A", LINE TABLE AND CURVE TABLE.

05917201
 MULBERRY BAPTIST CHURCH
 DB 10551/PG 91
 LITTLE ROCK ROAD

05917215
 MULBERRY BAPTIST CHURCH
 DB 10551/PG 91
 BURKHOLDER ROAD

05917214
 MULBERRY BAPTIST CHURCH
 DB 10551/PG 91
 6450 TUCKASEEGEE ROAD

05917210
 BRICKYARD GROUP, LLC.
 DB 26252/PG 495
 6600 TUCKASEEGEE ROAD

05917211
 MULBERRY BAPTIST CHURCH
 DB 10551/PG 91
 6524 TUCKASEEGEE ROAD

05917212
 ANABELI OLIVERA ROMERO AND
 JOHANN CANTO ROMERO
 DB 1010/PG 620
 6816 TUCKASEEGEE ROAD

05917213
 SANTOS MACHADO PAZ
 DB 30662/PG 206
 6512 TUCKASEEGEE ROAD

(VARIABLE PUBLIC R/W)
 LITTLE ROCK ROAD

DETAIL A:
 (SEE PAGE TWO)

N 88°06'05" W
 (S 88°06'47" E 526.98')

05917204
 2405 LITTLE ROCK, LLC.
 DB 30492/PG 153
 2331 AND 2405 LITTLE ROCK ROAD

STATE OF NORTH CAROLINA
 COUNTY OF MECKLENBURG

I, REVIEW OFFICER OF MECKLENBURG COUNTY, CERTIFY THAT THE MAP OR PLAT TO WHICH THIS CERTIFICATION IS AFFIXED MEETS ALL STATUTORY REQUIREMENTS FOR RECORDING.

REVIEW OFFICER DATE

LEGEND

- REBAR OR IRON PIN FOUND ○
- #5 REBAR SET OR PK NAIL ●
- COMPUTED POINT □
- PROPERTY LINES ———
- EXISTING RIGHT-OF-WAY ——— R/W
- NEW RIGHT-OF-WAY ———
- FEE SIMPLE OUTSIDE EXISTING R/W [Hatched pattern]
- TEMP. CONSTRUCTION EASEMENT [Dotted pattern]
- SIDEWALK/UTILITY EASEMENT [Grid pattern]
- UTILITY EASEMENT [Diagonal line pattern]

PREPARED BY:
 CITY OF CHARLOTTE
 ENGINEERING & PROPERTY MANAGEMENT DEPARTMENT
 600 EAST FOURTH STREET
 CHARLOTTE, NC 28202
 704-336-2291

CHARLOTTE ENGINEERING & PROPERTY MANAGEMENT DEPARTMENT		
REVISIONS	LITTLE ROCK ROAD SIDEWALK PROJECT	JOB NO. PM51215018
SCALE 1" = 200' 	PROPERTY OF MULBERRY BAPTIST CHURCH CHARLOTTE, MECKLENBURG CO., NC	FILE NO. 059-172-01
DRAWN BY LG	CHECKED BY JWB SURVEY SUPVR.	SHEET 1 OF 2
DATE		

K: \AutoCad\En_su-LD4\215018\dwg\LITTLEROCKROADSIDEWALKPLAST.DWG

DB 31587-944

I, JACKIE W. BRIM, CERTIFY THAT THIS PLAT WAS PREPARED UNDER MY SUPERVISION AND THAT THE PLAT WAS PREPARED FOR THE PURPOSE OF ACQUISITION AND EASEMENTS ONLY, AND IS NOT INTENDED TO BE A BOUNDARY SURVEY OF PROPERTY SHOWN.

Jackie W. Brim 11-3-2016
 JACKIE W. BRIM, NC P.L.S. L-4348 DATE

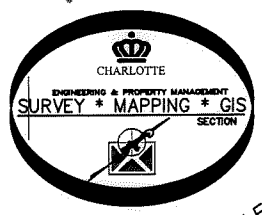
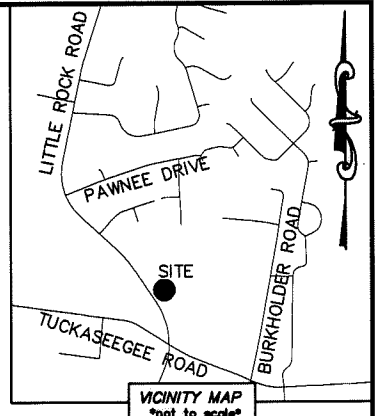
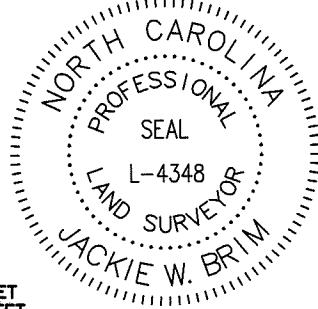

1" PIPE FOUND
 N: 550,862.98 FEET
 E: 1,421,658.18 FEET

CURVE TABLE		
CURVE	RADIUS & ARC	CHORD
C1	R=21.00 L=19.14'	S 59°53'10" E 18.49'
C2	R=19.00 L=17.32'	S 59°53'10" E 16.73'
C3	R=962.50 L=37.30'	S 32°39'40" E 37.30'
C4	R=12.00 L=4.08'	S 43°30'10" E 4.06'
C5	R=28.00 L=19.02'	S 33°46'20" E 18.66'
C6	R=12.00 L=4.08'	S 24°02'30" E 4.06'
C7	R=12.00 L=10.94'	S 59°53'10" E 10.56'
C8	R=28.00 L=25.52'	S 59°53'10" E 24.65'
C9	R=971.50 L=38.47'	S 32°38'20" E 38.46'

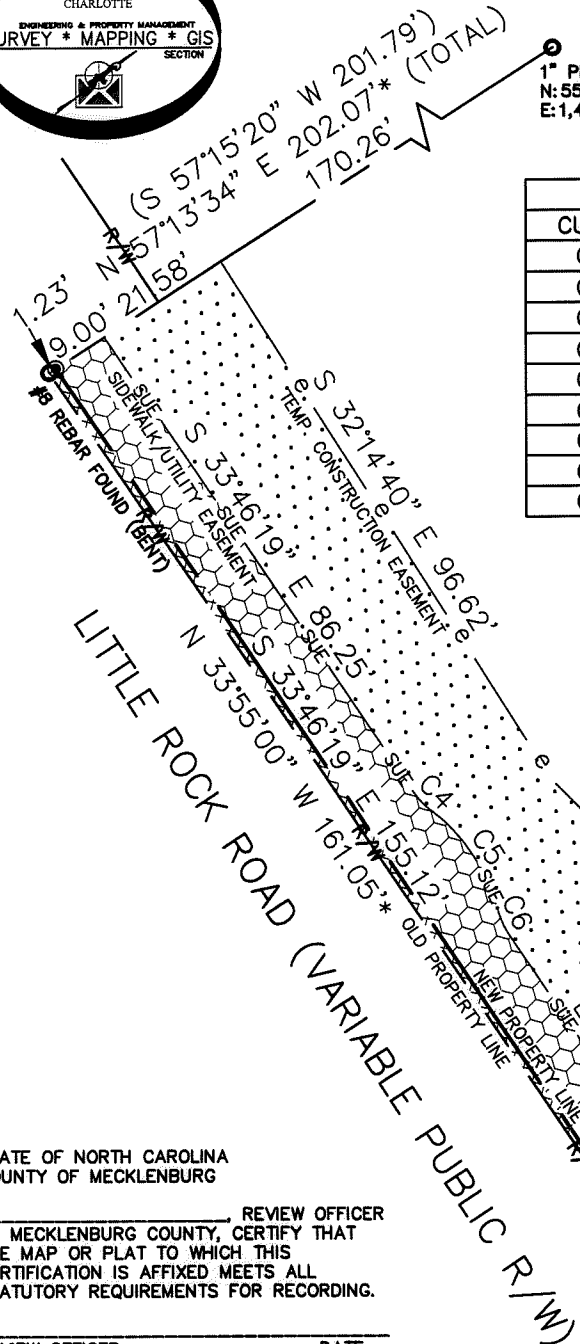

④
 05917201
 MULBERRY BAPTIST CHURCH
 DB 10551/PG 91
 LITTLE ROCK ROAD

DETAIL A:
 (SCALE: 1"=30')

STATE OF NORTH CAROLINA
 COUNTY OF MECKLENBURG

I, _____ REVIEW OFFICER
 OF MECKLENBURG COUNTY, CERTIFY THAT
 THE MAP OR PLAT TO WHICH THIS
 CERTIFICATION IS AFFIXED MEETS ALL
 STATUTORY REQUIREMENTS FOR RECORDING.

REVIEW OFFICER _____ DATE _____

LINE TABLE		
LINE	LENGTH	BEARING
(L1)	(154.13')	(S 34°08'59" E)
L2	154.14'	N 34°16'00" W
(L3)	(91.97')	(S 56°59'33" W)
L4	92.40*	N 56°23'12" E
(L5)	(384.69')	(S 33°41'50" E)
L6	-----	N 34°15'15" W
L7	238.38*	N 37°36'50" E
(L8)	(114.58')	(N 77°51'00" W)
L9	-----	N 77°25'25" W
(L10)	(125.55')	(N 68°37'00" W)
L11	-----	N 68°11'06" W
L12	27.05'	S 33°46'19" E
L13	37.81'	S 33°46'19" E
L14	2.00'	S 33°46'19" E
L15	2.25'	S 33°46'19" E
L16	12.58'	N 59°00'46" E
L17	2.00'	S 30°59'14" E
L18	12.48'	S 59°00'46" W
L19	27.05'	S 33°46'19" E

PREPARED BY:
 CITY OF CHARLOTTE
 ENGINEERING & PROPERTY MANAGEMENT DEPARTMENT
 600 EAST FOURTH STREET
 CHARLOTTE, NC 28202
 704-336-2291

CHARLOTTE ENGINEERING & PROPERTY MANAGEMENT DEPARTMENT		
REVISIONS SCALE 1"=30' DRAWN BY LG DATE	LITTLE ROCK ROAD SIDEWALK PROJECT PROPERTY OF MULBERRY BAPTIST CHURCH CHARLOTTE, MECKLENBURG CO., NC	JOB NO. PM51215018 FILE NO. 059-172-01 SHEET 2 OF 2
K:\AutoCad\En_su-LD4\215018\dwg\LITTLE ROCK ROADSIDEWALKPLAST.DWG		

DB 31587-944