

AREA TOTALS

Total Parcel Area	18,580 SF
Total Proposed Esmt. Area	1,809 SF
Temporary Construction Easement Total	1,203 SF
Sidewalk Utility Easement Total	406 SF
Total Parcel Area Remaining	18,580 SF

THE LOCALIZED COORDINATE SYSTEM DEVELOPED FOR THIS PROJECT IS BASED ON THE NAD 83/2001 STATE PLANE COORDINATES FOR THE NCGS MONUMENT "RESERVOIR" WITH A NORTHING OF 561,874.06, EASTING OF 1,434,680.70. THE AVERAGE COMBINED FACTOR USED ON THIS PROJECT (GROUND TO GRID) IS 0.99983851. ALL LINEAR DISTANCES ARE LOCALIZED HORIZONTAL DISTANCES.

LINE	BEARING	DISTANCE
L1	N 14°31'17" E	11.50'
L2	N 14°31'17" E	5.87'
L3	S 14°31'17" W	5.73'
L4	S 14°31'17" W	33.51'
L5	N 76°42'00" W	13.35'
L6	N 08°56'56" W	23.77'
L7	N 76°42'00" W	47.19'
L8	S 76°42'00" E	70.02'

LOCALIZED GRID COORDINATES
 N: 549320.87
 E: 1436373.63

PROJECT BASELINE TIE
 STA: 12+46.18
 18.63 RT.

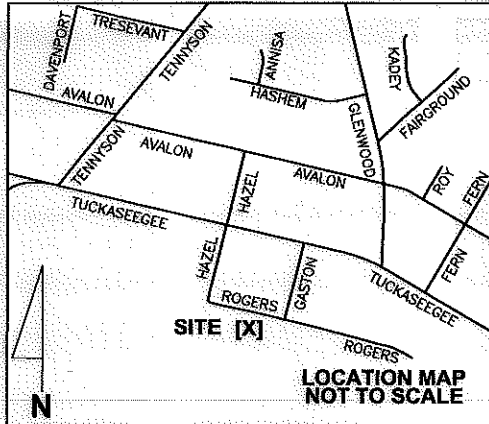

STATE OF NORTH CAROLINA
 COUNTY OF MECKLENBURG

I, _____, Review Officer of Mecklenburg County, certify that the map or plat to which this certification is attached meets all statutory requirements for recording.

Review Officer _____ Date _____

19
 065-02-355
 ANDERSON BENNETT
 AND MATTIE D BENNETT
 MB 967 PG 595
 DB 7642 PG 635
 3717 ROGERS ST

(N 13°50' E 244.80')
N 14°31'17" E 245.02' (TOTAL)

225.65'

29
 065-02-354
 BOBBY T CLARK
 AND BETTY D CLARK
 MB 967 PG 595
 DB 03954 PG 941
 3711 ROGERS ST

246.34'
S 14°31'17" W 285.57' (TOTAL)
 (S 13°50' W 285.57')

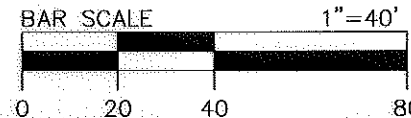

31
 065-02-367
 CITIFINANCIAL MORTGAGE CO INC
 MB 332 PG 335
 DB 20183 PG 42
 3709 ROGERS ST

ELLISON, KIMBROUGH WOOD-CHARLOTTE PROPERTIES
 065-02-365
 DB 06070 PG 236
 3016 FREEDOM DR
 N 76°13'17" W 80.85'
 N 46°13'17" W 11.94'

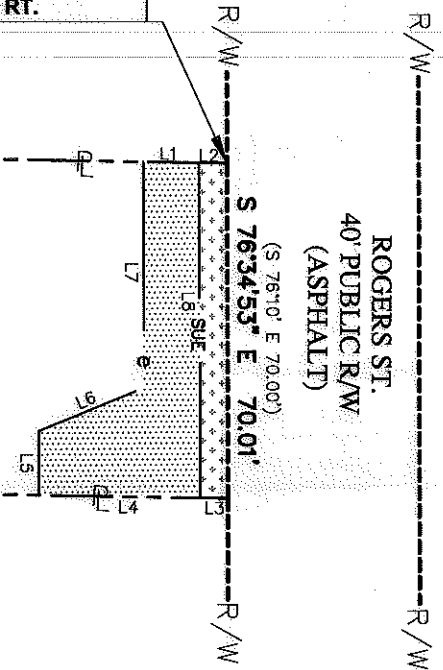

SPECIAL NOTE:
 ALL TREES AND SHRUBS IN THE EASEMENT ARE SUBJECT TO REMOVAL EXCEPT AS NOTED.

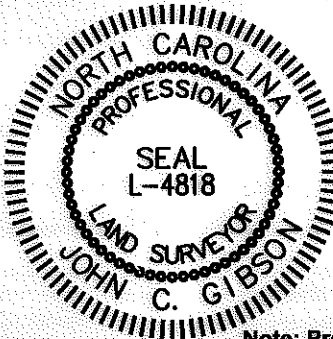

Note: Property corners shown circled were located by actual field survey. Bearings are based on N.C. State Grid North. This map was prepared for the purpose of right-of-way and/or easement acquisition only, and is not intended to be a boundary survey of the property shown. This map was prepared under my supervision.

John C. Gibson
 JOHN C. GIBSON
 L-4818

NOTE:
 1) BEARINGS AND DISTANCES SHOWN IN PARENTHESES ARE BASED ON RECORDED MAP INFORMATION.



Dewberry & Davis, Inc.
 LICENSE # F-0679

6135 LAKEVIEW ROAD
 SUITE 400
 CHARLOTTE, NC 28269-2609
 PHONE: (704) 509-9918
 FAX: (704) 509-9937

LEGEND

- Sidewalk Utility Easement..... — SUE —
- Temporary Construction Easement ... — e —
- Sidewalk Utility Easement..... [Pattern]
- Temporary Construction Easement ... [Pattern]
- Right-of-Way..... ——— R/W
- Existing Property Line - - - - -
- Field Located Property Iron [Symbol]

NO	DATE	BY	REVISION
1	11/08/11	JBP	Easement line change

 CHARLOTTE ENGINEERING & PROPERTY MANAGEMENT	Project Name Enderly Park NIP 512-07-034
	Property Owner BOBBY T CLARK AND BETTY D CLARK Address 3711 ROGERS ST
PROJECT NO. 512-07-034 PREPARED BY RM	SCALE 1"=40' DATE 06/2011
PATH 1 OF 1 SHEET	