

I, JAMES E. CRADDOCK, CERTIFY THAT THIS MAP WAS DRAWN UNDER MY SUPERVISION FROM AN ACTUAL SURVEY MADE UNDER MY SUPERVISION (DEED DESCRIPTIONS RECORDED IN REFERENCES AS SHOWN HEREON); THAT THE BOUNDARIES NOT SURVEYED ARE CLEARLY INDICATED AS DRAWN FROM INFORMATION AS SHOWN HEREON; THAT THE POSITIONAL ACCURACY DOES NOT EXCEED 0.10' AT THE 95% CONFIDENCE LEVEL; THIS MAP WAS PREPARED IN ACCORDANCE WITH G. S. 47-30(m) AS AMENDED; AND THAT THE SURVEY IS OF ANOTHER CATEGORY, SUCH AS THE RECOMBINATION OF EXISTING PARCELS; A COURT-ORDERED SURVEY, OR OTHER EXEMPTION OR EXCEPTION TO THE DEFINITION OF SUBDIVISION.

JAMES E. CRADDOCK, PLS LICENSE NO. L-3039 4 JUNE 2018

6 June 2018

TRAVERSE NAIL #15

N: 547,525.51'

E: 1,433,605.28'

C.G.F.: 0.9998400928

N.C. GRID ~ NAD 83(2011)

EPOCH 2010.00

VICINITY MAP
NOT TO SCALE

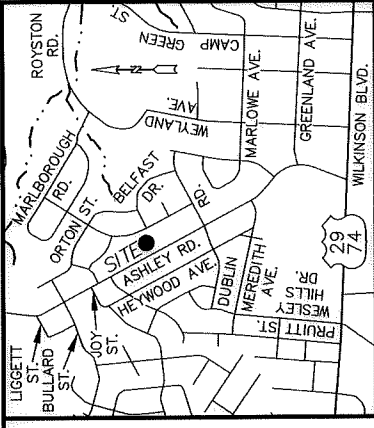

067-127-35
[NOW OR FORMERLY]
ARIAM ANDEMICHAE and
SAMSON ANDEMICHAE
MB. 6, PG. 611; LOT 33
DB. 20083, PG. 45
2230 DICKENS AVENUE

18

067-127-10
[NOW OR FORMERLY]
THE OLD WELL GROUP, LLC
MB. 6, PG. 611; LOT 13
DB. 29901, PG. 70
2315 ASHLEY ROAD

17

067-127-11
[NOW OR FORMERLY]
BRENDA J. HARRIS
MB. 6, PG. 611; LOT 12
DB. 9316, PG. 537
2321 ASHLEY ROAD

NC GRID NAD 83(2011)
EPOCH 2010.00

067-127-34
[NOW OR FORMERLY]
LESTER M. CHINNIS JR.
and
LETHA PEARL
MB. 1487, PG. 397; LOT 34
DB. 9657, PG. 458
2236 DICKENS AVENUE

16

067-127-12
[NOW OR FORMERLY]
JAMES W. BANKS
MB. 1487, PG. 397; LOT 11
DB. 11209, PG. 500
2327 ASHLEY ROAD

ASHLEY ROAD
60' PUBLIC RIGHT-OF-WAY

STATE OF NORTH CAROLINA
COUNTY OF MECKLENBURG

REVIEW OFFICER OF MECKLENBURG COUNTY, CERTIFY THAT THE MAP OR PLAT TO WHICH THIS CERTIFICATION IS AFFIXED MEETS ALL STATUTORY REQUIREMENTS FOR RECORDING.

REVIEW OFFICER _____ DATE _____

- NOTES
1. BEARINGS AND DISTANCES SHOWN IN PARENTHESIS ARE BASED ON RECORD INFORMATION.
 2. TOTAL AREA: 10,500 SQ. FT.
 3. TEMPORARY CONSTRUCTION EASEMENT: 363 SQ. FT.
 4. AREA REMAINING: 10,500 SQ. FT.

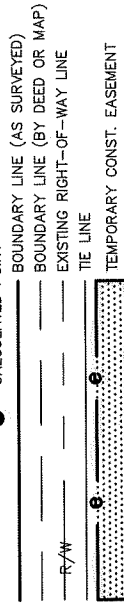

PREPARED BY:

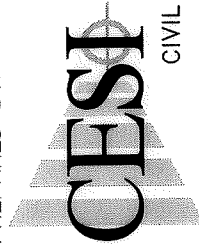

CIVIL - GEOTECHNICAL - SURVEYING
N.C. FIRM LICENSE NO. C-0263
45 SPRING STREET SW CONCORD (704) 786-5404
CONCORD, NC 28025 FAX (704) 786-7454
JOB NO. 170106.000
ACAD FILE: Ashley Rd-Parcel 17.DWG



CHARLOTTE

ENGINEERING & PROPERTY MANAGEMENT DEPARTMENT

REVISIONS	JOB NO. PMES171516	
	ASHLEY ROAD SIDEWALK IMPROVEMENT PROJECT	
OWNER: BRENDA J. HARRIS 2321 ASHLEY ROAD CHARLOTTE, MECKLENBURG CO., NC		FILE NO. 067-127-11
DRAWN BY NOM		SHEET 1
SURVEYED BY: JEC		OF 1
CHECKED BY SURVEY SUPVR. JEC		
DATE: 06-04-2018		

DB 32890-18