

I, JAMES E. DAVIS, CERTIFY THAT THIS PLAT WAS PREPARED UNDER MY SUPERVISION AND THAT THE PLAT WAS PREPARED FOR THE PURPOSE OF ACQUISITION AND EASEMENTS ONLY, AND IS NOT INTENDED TO BE A BOUNDARY SURVEY OF PROPERTY SHOWN.

James E. Davis
JAMES E. DAVIS, NC P.L.S. L-3747 DATE _____

State of North Carolina
 County of Mecklenburg

I, _____, Review Officer of Mecklenburg County, certify that the map or plat to which this certification is affixed meets all statutory requirements for recording.

Review Officer _____ Date _____

- NOTE:**
- HORIZONTAL DATUM FOR PROJECT IS NC GRID NAD83(2011) AND VERTICAL DATUM IS NAVD88 FROM GPS OBSERVATIONS COMPLETED ON APRIL 04, 2017 UTILIZING THE NC VRS NETWORK. NCGS POINT "NC77" WAS UTILIZED AS THE NETWORK BASE AND NGS GEOID 12B WAS THE GEOID MODEL. THE LOCALIZATION POINT FOR THE PROJECT WAS MERRICK #205 HAVING NC GRID COORDINATES OF N=549229.675 FEET, E=1443216.005 FEET, ELEVATION=695.98 FEET AND A COMBINED FACTOR OF 0.999844756.
 - ALL DISTANCES SHOWN ARE HORIZONTAL GROUND DISTANCES.
 - AREAS DETERMINED BY COORDINATE COMPUTATIONS.
 - TRAVERSE ADJUSTED BY LEAST SQUARE ADJUSTMENT METHOD.

Parcel Line Table

Line #	Length	Direction
L1	140.16	S32° 32' 57"W
L2	51.47	N57° 27' 47"W
L3	8.89	N57° 27' 47"W
L4	2.95	N32° 44' 19"E
L5	97.26	N32° 44' 19"E
L6	48.00	N66° 08' 36"E
L7	33.47	S57° 24' 24"E
L8	7.61	S34° 20' 33"E
L9	1.88	S58° 29' 39"E

LEGEND

- COMPUTED POINT
- IRON PIN FOUND
- PROPERTY LINE
- TEMP. CONSTRUCTION EASEMENT

- AREAS:**
- TOTAL AREA 7,901 SQ. FT.
 - TEMP. CONSTRUCTION EASEMENT 16 SQ. FT.
 - AREA REMAINING 7,901 SQ. FT.

PREPARED BY:
MERRICK & COMPANY
 1001 MOREHEAD SQUARE DR.
 SUITE 530
 CHARLOTTE, NC 28203
 704-528-6500



DB 32890-49
DB 3B192-630

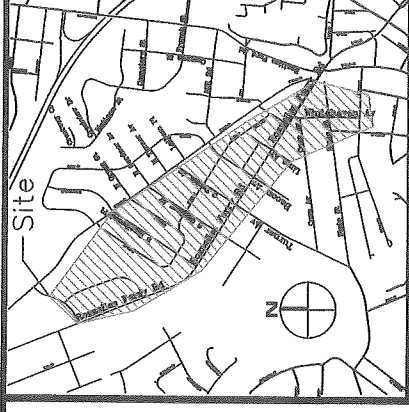

VICINITY MAP (NOT TO SCALE)

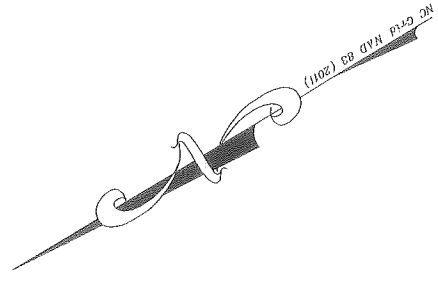

069-028-20
 GLENN MICHAEL AARON
 2433 ROSLYN AV
 DB 06839 PG 396
 PB 5 PG 287

NC GRID
 N: 549822.1015
 E: 1442681.8190

069-028-05
 CARNELL & CLARA THOMPSON
 2420 ROZZELLES FERRY RD
 DB 3573 PG 588
 PB 5 PG 287

069-028-04
 NOW OR FORMERLY
 COLLIE BOYD JR (WIDOWER)
 2424 ROZZELLES FERRY RD
 DB 6674 PG 385
 PB 5 PG 287

069-028-03
 HEATHER J HAGAN
 2434 ROZZELLES FERRY RD
 DB 32474 PG 422
 PB 5 PG 287

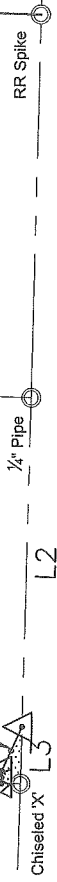

ROZZELLES FERRY RD. - 60' R/W
 (MB: 332 PG: 3)



CHARLOTTE

ENGINEERING & PROPERTY MANAGEMENT

**ROZZELLES FERRY ROAD
 PEDSCAPE MEDIAN
 IMPROVEMENT**

PROPERTY ACQUISITION
 OWNER: COLLIE BOYD JR (WIDOWER)
 CHARLOTTE, MECKLENBURG CO., NC

REVISIONS

SCALE
 1" = 30'

DRAWN BY: RRH

DATE: 04/17/2018

JOB NO.
 51216021

FILE NO.
 -

SHEET
 1

OF
 1

CHECKED BY: SURVEY SUPERVISOR