

I, JACKIE W. BRIM, CERTIFY THAT THIS PLAT WAS PREPARED UNDER MY SUPERVISION AND THAT THE PLAT WAS PREPARED FOR THE PURPOSE OF EASEMENTS ONLY, AND IS NOT INTENDED TO BE A BOUNDARY SURVEY OF PROPERTY SHOWN.

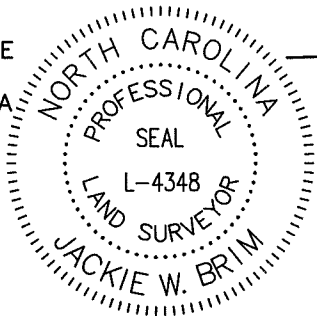

071-011-17
GEORGE TISSIERE
DB 24422-159
1700 HEATHCLIFF ST

Jackie W. Brim 5-9-2016
JACKIE W. BRIM, NC P.L.S. L-4348 DATE

Line Table		
Line #	Length	Direction
L1	1.19	S65°39'21"W
L2	4.52	S65°39'21"W
L3	1.33	S34°57'53"W
L4	8.22	S34°57'53"W
L5	19.87	S52°14'23"E
L6	4.29	N48°11'56"E
L7	9.04	S41°51'25"E
L8	4.85	S53°39'51"E
L9	27.57	S46°58'09"E
L10	11.64	S50°37'43"E
L11	15.39	S61°57'16"E

WESTBROOK DR.
(PUBLIC RIGHT-OF-WAY VARIES)
1" PIPE
(TIE)
N1°39'55"W 62.80'

W. 4TH ST. EXT
(PUBLIC RIGHT-OF-WAY VARIES)

LEGEND

- PK NAIL
- IRON PIN FOUND
- CALCULATED POINT
- LINES SURVEYED
- LINES NOT SURVEYED
- RIGHT-OF-WAY
- TEMP. CONSTRUCTION EASEMENT
- SIDEWALK UTILITY EASEMENT

071-011-18
MICHAEL H. LEMMOND AND
BRENDA P. LEMMOND
DB 22400-160
1614 W 4TH ST EXT

Curve Table				
Curve #	Length	Radius	CHORD BEARING	CHORD
C1	91.82	1537.41	S50°57'39"E	91.80
C2	91.18	1946.66	S51°07'29"E	91.18

STATE OF NORTH CAROLINA
COUNTY OF MECKLENBURG

I, _____, REVIEW OFFICER OF MECKLENBURG COUNTY, CERTIFY THAT THE MAP OR PLAT TO WHICH THIS CERTIFICATION IS AFFIXED MEETS ALL STATUTORY REQUIREMENTS FOR RECORDING.

071-011-23
NEIGHBORING
CONCEPTS LIC
U/F 583-1
322 WALNUT AV

REVIEW OFFICER _____ DATE _____

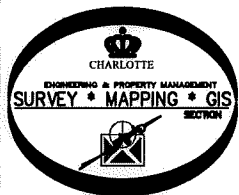

PREPARED BY:
CITY OF CHARLOTTE
ENGINEERING & PROPERTY
MANAGEMENT DEPARTMENT
600 EAST FOURTH STREET
CHARLOTTE, NC 28202
704-336-2291

NOTE:

1) BEARINGS AND DISTANCES SHOWN IN PARENTHESES ARE BASED ON RECORDED MAP INFORMATION.

- 2) TOTAL AREA 7,309 SQ. FT.
- 3) TEMP CONSTRUCTION EASEMENT 588 SQ. FT.
- 4) SIDEWALK UTILITY EASEMENT 119 SQ. FT.
- 5) AREA REMAINING 7,309 SQ. FT.

COMBINED GRID
FACTOR=0.999837708
N: 546049.14
E: 1443848.34

CITY TP-42
N: 544997.40
E: 1445636.30

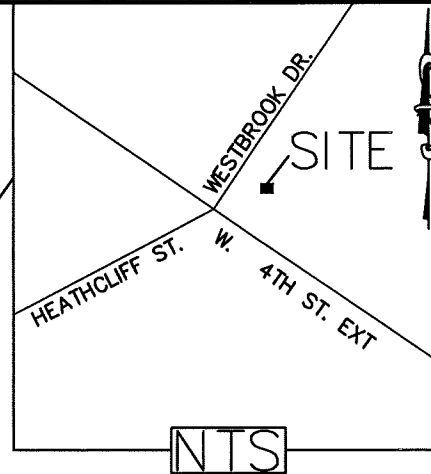

		CHARLOTTE ENGINEERING & PROPERTY MANAGEMENT DEPARTMENT	
REVISIONS		<h1>W 4th St Extension</h1>	
JOB # 5/4/2016			
SCALE 1"=20"		PROPERTY OF MICHAEL H. LEMMOND AND BRENDA P. LEMMOND CHARLOTTE, MECKLENBURG CO., NC	
DRAWN BY P.S.			
DATE		CHECKED BY JB SURVEY SUPVR.	
K:\AutoCad\En_su-LD4\208018 Johnson & Wales-4th-Trade at\New 4th E-2015\PLATS\#1 071-011-18.dwg		JOB NO. 512-15-043 215043 SHEET 1 OF 1	