

I, JACKIE W. BRIM, CERTIFY THAT THIS PLAT WAS PREPARED UNDER MY SUPERVISION AND THAT THE PLAT WAS PREPARED FOR THE PURPOSE OF EASEMENTS ONLY, AND IS NOT INTENDED TO BE A BOUNDARY SURVEY OF PROPERTY SHOWN.

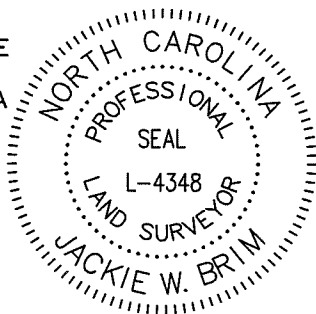

Jackie W. Brim 5-9-2016
 JACKIE W. BRIM, NC P.L.S. L-4348 DATE

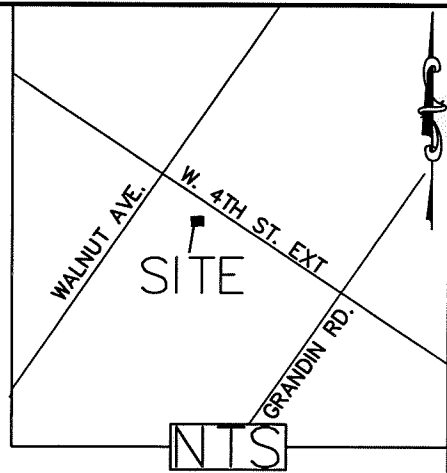

071-013-11
 MELANIE MGRAHAM
 MB 332 PG 254
 DB 19524 PG 26
 405 Walnut Av.

071-013-10
 MARY ELIZABETH R. GAMBLE
 AND JEC INV PARTNERSHIP
 DB 4596-037
 301 WALNUT AV

071-013-09
 ROBERT BROWN Jr.
 DB 26365 pg 246
 1517 W 4TH ST EXT

W. 4TH ST. EXT.
 (PUBLIC RIGHT-OF-WAY VARIES)

Line Table		
Line #	Length	Direction
L1	6.15	N35°19'33"E
L2	1.51	N35°19'33"E
L3	3.03	N35°07'53"E
L4	5.00	N35°07'53"E
L5	50.43	S54°35'47"E
L6	2.00	S54°52'07"E
L7	42.20	S54°57'18"E

LEGEND

- PK NAIL
- IRON PIN FOUND
- CALCULATED POINT
- LINES SURVEYED
- LINES NOT SURVEYED
- RIGHT-OF-WAY
- TEMP. CONSTRUCTION EASEMENT
- SIDEWALK UTILITY EASEMENT

071-013-12
 JOHN T. JORDAN
 MB 332 PG 254
 DB 4317 PG 68
 409 Walnut Av

071-013-06
 NEVADA WILSON GRAHAM
 AND NATHANIEL GRAHAM
 DB 9277-755
 304 GRANDIN RD

CITY TP-42
 N: 544997.40
 E: 1445636.30

Curve Table				
Curve #	Length	Radius	CHORD BEARING	CHORD
C2	1.18	2.00	N38°01'09"W	1.17
C1	5.25	12.00	S42°33'15"E	5.21

- NOTE:
- 1) BEARINGS AND DISTANCES SHOWN IN PARENTHESSES ARE BASED ON RECORDED MAP INFORMATION.
 - 2) TOTAL AREA 3,860 SQ. FT.
 - 3) TEMP CONSTRUCTION EASEMENT 309 SQ. FT.
 - 4) SIDEWALK UTILITY EASEMENT 86 SQ. FT.
 - 5) AREA REMAINING 3,860 SQ. FT.

STATE OF NORTH CAROLINA
 COUNTY OF MECKLENBURG

I, _____, REVIEW OFFICER OF MECKLENBURG COUNTY, CERTIFY THAT THE MAP OR PLAT TO WHICH THIS CERTIFICATION IS AFFIXED MEETS ALL STATUTORY REQUIREMENTS FOR RECORDING.

REVIEW OFFICER _____ DATE _____

PREPARED BY:
 CITY OF CHARLOTTE
 ENGINEERING & PROPERTY
 MANAGEMENT DEPARTMENT
 600 EAST FOURTH STREET
 CHARLOTTE, NC 28202
 704-336-2291

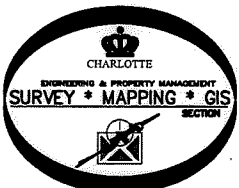

		CHARLOTTE ENGINEERING & PROPERTY MANAGEMENT DEPARTMENT	
REVISIONS		<h1>W 4th St Extension</h1>	
JOB # & OWNERSHIP 5/4/16			
SCALE 1"=20"		PROPERTY OF ROBERT BROWN Jr. CHARLOTTE, MECKLENBURG CO., NC	
DRAWN BY P.S.			
DATE		CHECKED BY JB SURVEY SUPVR.	
OF 1			