

071-014-08
ROBERT J DAVIS AND
SYLVIA D COWART
DB 11096-169
301 GRANDIN RD

COMBINED GRID
FACTOR=0.999837708
N: 545328.84
E: 1444733.79

- NOTE:
- 1) BEARINGS AND DISTANCES SHOWN IN PARENTHESES ARE BASED ON RECORDED MAP INFORMATION.
 - 2) TOTAL AREA 14,160 SQ. FT.
 - 3) TEMP CONSTRUCTION EASEMENT 1,182 SQ. FT.
 - 4) SIDEWALK UTILITY EASEMENT 362 SQ. FT.
 - 5) AREA REMAINING 14,160 SQ. FT.

071-015-01
JOHN W. CHAPMAN AND
SARAH J. CHAPMAN
DB 22400-849
220 S. SUMMIT AVE.

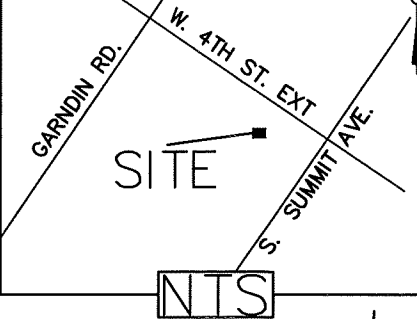

LEGEND

- PK NAIL
- IRON PIN FOUND
- CALCULATED POINT
- LINES SURVEYED
- LINES NOT SURVEYED
- RIGHT-OF-WAY
- TEMP. CONSTRUCTION EASEMENT
- SIDEWALK UTILITY EASEMENT

STATE OF NORTH CAROLINA
COUNTY OF MECKLENBURG

I, _____, REVIEW OFFICER OF MECKLENBURG COUNTY, CERTIFY THAT THE MAP OR PLAT TO WHICH THIS CERTIFICATION IS AFFIXED MEETS ALL STATUTORY REQUIREMENTS FOR RECORDING.

REVIEW OFFICER

DATE

PREPARED BY:
CITY OF CHARLOTTE
ENGINEERING & PROPERTY
MANAGEMENT DEPARTMENT
600 EAST FOURTH STREET
CHARLOTTE, NC 28202
704-336-2291

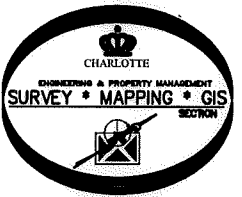

071-014-06
CHRISTOPHER WAYNE ROGERS and
wife, STACY MICHELLE ROGERS
DB 26965-291
304 S SUMMIT AV

071-014-05
ALMALET LLC.
DB 20960 PG 218
308 S Summit Av.

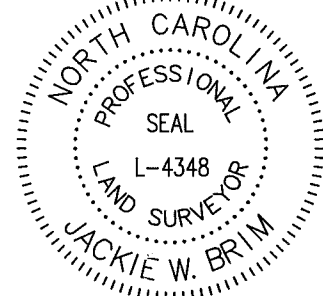

I, JACKIE W. BRIM, CERTIFY THAT THIS PLAT WAS PREPARED UNDER MY SUPERVISION AND THAT THE PLAT WAS PREPARED FOR THE PURPOSE OF EASEMENTS ONLY, AND IS NOT INTENDED TO BE A BOUNDARY SURVEY OF PROPERTY SHOWN.

Jackie W. Brim 5-9-2016
JACKIE W. BRIM, NC P.L.S. L-4348 DATE

CHARLOTTE ENGINEERING & PROPERTY MANAGEMENT DEPARTMENT		
REVISIONS	<h1>W 4th St Extension</h1>	JOB NO. 512-15-043
		215043
SCALE 0 1' = 20" 20'	PROPERTY OF CHRISTOPHER WAYNE ROGERS and wife, STACY MICHELLE ROGERS CHARLOTTE, MECKLENBURG CO., NC	SHEET 1
DRAWN BY P.S.		OF 2
CHECKED BY JB	SURVEY SUPVR.	

K:\A:\toCad\En_m-LD4\206018 Johnson & Wales-4th-Trade st\New 4th 8-2015\PLATS\#15 071-041-07.dwg

Line Table		
Line #	Length	Direction
L1	7.00	N34°51'52"E
L2	1.42	N34°51'52"E
L3	170.38	S54°56'56"E
L4	1.40	S54°52'25"E
L5	4.03	S54°52'25"E
L6	15.67	S02°14'58"W
L7	36.64	S57°43'43"E
L8	16.67	S50°43'50"E
L9	120.04	S54°59'13"E
L10	14.52	S12°43'05"W

I, JACKIE W. BRIM, CERTIFY THAT THIS PLAT WAS PREPARED UNDER MY SUPERVISION AND THAT THE PLAT WAS PREPARED FOR THE PURPOSE OF EASEMENTS ONLY, AND IS NOT INTENDED TO BE A BOUNDARY SURVEY OF PROPERTY SHOWN.

Jackie W. Brim 5-9-2016
 JACKIE W. BRIM, NC P.L.S. L-4348 DATE

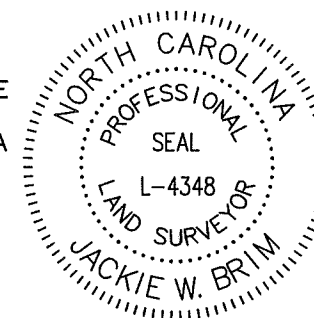

STATE OF NORTH CAROLINA
 COUNTY OF MECKLENBURG

I, _____, REVIEW OFFICER OF MECKLENBURG COUNTY, CERTIFY THAT THE MAP OR PLAT TO WHICH THIS CERTIFICATION IS AFFIXED MEETS ALL STATUTORY REQUIREMENTS FOR RECORDING.

REVIEW OFFICER

DATE

PREPARED BY:
 CITY OF CHARLOTTE
 ENGINEERING & PROPERTY
 MANAGEMENT DEPARTMENT
 600 EAST FOURTH STREET
 CHARLOTTE, NC 28202
 704-336-2291

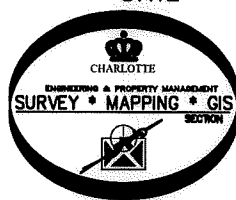

Curve Table				
Curve #	Length	Radius	CHORD BEARING	CHORD
C1	7.98	25.00	N45°44'53"W	7.95
C2	11.72	25.00	N23°10'24"W	11.61
C3	15.35	25.00	N7°50'31"E	15.11
C4	4.19	25.00	N30°13'58"E	4.19

CHARLOTTE ENGINEERING & PROPERTY MANAGEMENT DEPARTMENT		
REVISIONS	W 4th St Extension	JOB NO. 512-15-043
		215043
SCALE 1" = 20" 	PROPERTY OF CHRISTOPHER WAYNE ROGERS and wife, STACY MICHELLE ROGERS CHARLOTTE, MECKLENBURG CO., NC	SHEET 2
DRAWN BY P.S.		OF 2
	CHECKED BY JB SURVEY SUPVR.	

K:\AutoCad\En_su-LD4\208018 Johnson & Wales-4th-Trade et\New 4th 6-2015\PLATS\#15 071-041-07.dwg