

I, JAMES E. DAVIS, CERTIFY THAT THIS PLAT WAS PREPARED UNDER MY SUPERVISION AND THAT THE PLAT WAS PREPARED FOR THE PURPOSE OF ACQUISITION AND EASEMENTS ONLY, AND IS NOT INTENDED TO BE A BOUNDARY SURVEY OF PROPERTY SHOWN.

JED
JAMES E. DAVIS, NC P.L.S. L-3747 DATE _____

State of North Carolina
 County of Mecklenburg

_____, Review Officer of Mecklenburg County, certify that the map or plat to which this certification is affixed meets all statutory requirements for recording.

Review Officer _____ Date _____

- NOTE:**
- HORIZONTAL DATUM FOR PROJECT IS NC GRID NAD83(2011) AND VERTICAL DATUM IS NAVD88 FROM GPS OBSERVATIONS COMPLETED ON APRIL 04, 2017 UTILIZING THE NC VRS NETWORK. NCGS POINT "NC77" WAS UTILIZED AS THE NETWORK BASE AND NGS GEIOD 12B WAS THE GEIOD MODEL. THE LOCALIZATION POINT FOR THE PROJECT WAS MERRICK #205 HAVING NC GRID COORDINATES OF N=549229.675 FEET, E=1443216.005 FEET, ELEVATION=695.98 FEET AND A COMBINED FACTOR OF 0.999844756.
 - ALL DISTANCES SHOWN ARE HORIZONTAL GROUND DISTANCES.
 - AREAS DETERMINED BY COORDINATE COMPUTATIONS.
 - TRAVERSE ADJUSTED BY LEAST SQUARE ADJUSTMENT METHOD.

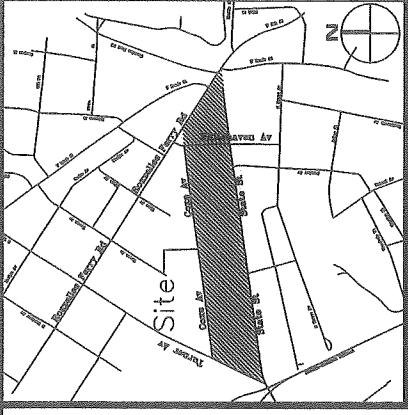

VICINITY MAP (NOT TO SCALE)

STATE ST. - 50' R/W
 (MB: 24 PG: 925)

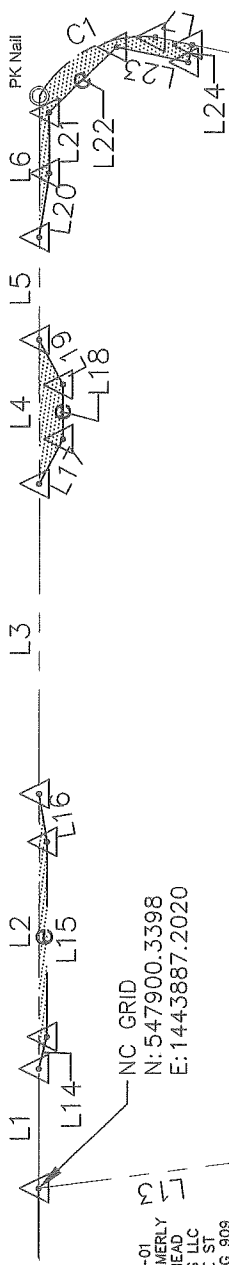

071-071-01
 NOW OR FORMERLY
 FOUNTAINHEAD
 PROPERTIES LLC
 303 STATE ST
 DB 22858 PG 909
 PB 4 PG 453

071-071-18
 NOW OR FORMERLY
 TERRY S. CORNELL AND
 WIFE DELMETRICE W. CORNELL
 302 KATONAH AVE
 DB 08481 PG 115
 PB 4 PG 589

KATONAH AV. - 25' R/W
 (MB: 25 PG: 731)

071-071-20
 NOW OR FORMERLY
 NASRIN SAAD
 309 KATONAH AVE
 DB 32466 PG 835
 PB 4 PG 589

071-071-35
 NOW OR FORMERLY
 DONALD W BATTLE
 306 S BRUNS AVE
 DB 10762 PG 163
 PB 4 PG 589

30
 071-071-37
 NOW OR FORMERLY
 CHESHIRE SEVERSVILLE, LLC
 1703, 1707, 1711, 1715
 SUMTER AV
 DB 27084 PG 817
 PB 24 PG 925

071-071-19
 NOW OR FORMERLY
 HOUSING PARTNERSHIP
 CHARLOTTE MECKLENBURG
 303 KATONAH AVE
 DB 07360 PG 560
 PB 25 PG 731

SUMTER AV. - 40' R/W
 (MB: 24 PG: 925)

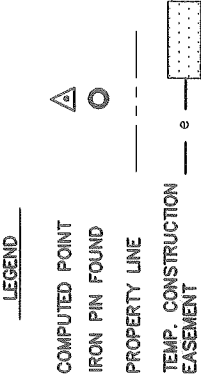

AREAS:

1. TOTAL AREA	94,077	SQ. FT.
2. TEMP CONSTRUCTION EASEMENT	810	SQ. FT.
3. AREA REMAINING	94,077	SQ. FT.

PREPARED BY:
MERRICK & COMPANY
 1001 MOREHEAD SQUARE DR.
 SUITE 530
 CHARLOTTE, NC 28203
 704-529-6500



CHARLOTTE
 ENGINEERING & PROPERTY MANAGEMENT

REVISIONS	JOB NO. PMES181539
REV 08-07-18	FILE NO. -
1" SCALE 1" = 60'	SHEET 1
DRAWN BY: RRH	OF 2
DATE 05/31/2018	CHECKED BY SURVEY SUPVR.
STATE STREET PEDESTRIAN IMPROVEMENT PROJECT	
PROPERTY ACQUISITION OWNER: CHESHIRE SEVERSVILLE LLC CHARLOTTE, MECKLENBURG CO., NC	

DB 33102-400

I, JAMES E. DAVIS, CERTIFY THAT THIS PLAT WAS PREPARED UNDER MY SUPERVISION AND THAT THE PLAT WAS PREPARED FOR THE PURPOSE OF ACQUISITION AND EASEMENTS ONLY, AND IS NOT INTENDED TO BE A BOUNDARY SURVEY OF PROPERTY SHOWN.

[Signature]
 JAMES E. DAVIS
 PROFESSIONAL LAND SURVEYOR
 SEAL L-3747
 08-07-18

JAMES E. DAVIS, NC P.L.S. L-3747 DATE
 State of North Carolina
 County of Mecklenburg

_____, Review Officer of Mecklenburg County, certify that the map or plat to which this certification is affixed meets all statutory requirements for recording.

Review Officer _____ Date _____

- NOTE: HORIZONTAL DATUM FOR PROJECT IS NC GRID NAD83(2011) AND VERTICAL DATUM IS NAVD83 FROM GPS OBSERVATIONS COMPLETED ON APRIL 04, 2017 UTILIZING THE NC VRS NETWORK. NCGS POINT "NC77" WAS UTILIZED AS THE NETWORK BASE AND NGS GEOID 12B WAS THE GEOID MODEL. THE LOCALIZATION POINT FOR THE PROJECT WAS MERRICK #205 HAVING NC GRID COORDINATES OF N=549229.675 FEET, E=1443216.005 FEET, ELEVATION=695.98 FEET AND A COMBINED FACTOR OF 0.999844756. ALL DISTANCES SHOWN ARE HORIZONTAL GROUND DISTANCES.
- AREAS DETERMINED BY COORDINATE COMPUTATIONS.
 - TRAVERSE ADJUSTED BY LEAST SQUARE ADJUSTMENT METHOD.

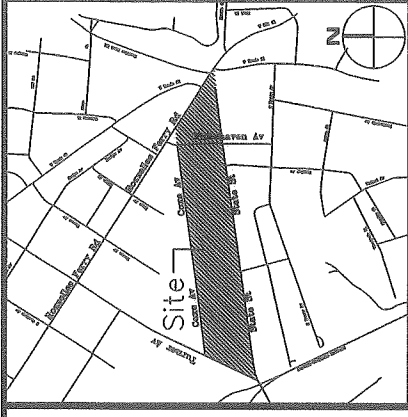

VICINITY MAP (NOT TO SCALE)

Parcel Line Table		
Line #	Length	Direction
L1	37.44	N81° 57' 26"E
L2	85.98	N81° 57' 16"E
L3	97.00	N81° 57' 29"E
L4	45.09	N81° 57' 29"E
L5	32.05	N81° 57' 29"E
L6	44.15	N81° 57' 29"E
L7	11.74	S3° 38' 59"W
L8	259.08	S3° 38' 59"W
L9	253.69	N87° 33' 32"W
L10	107.43	S14° 37' 41"E
L11	25.00	S14° 37' 41"E
L12	65.00	S14° 37' 41"E

Parcel Line Table		
Line #	Length	Direction
L13	75.60	N15° 30' 01"W
L14	10.31	S83° 57' 15"E
L15	61.00	N81° 57' 15"E
L16	15.21	N72° 28' 31"E
L17	15.89	S69° 54' 05"E
L18	17.06	N81° 52' 50"E
L19	15.89	N53° 53' 55"E
L20	20.27	S89° 03' 41"E
L21	19.00	N81° 38' 32"E
L22	29.42	S51° 50' 26"E
L23	23.00	S3° 48' 23"W
L24	5.54	S86° 11' 37"E

Curve Table					
Curve #	Length	Radius	Delta	Chord Direction	Chord Length
C1	43.15	37.26	66.36	S34° 42' 26"E	40.78
C2	30.99	20.00	88.77	S48° 02' 44"W	27.98

PREPARED BY:
 MERRICK & COMPANY
 1001 MOREHEAD SQUARE DR.
 SUITE 530
 CHARLOTTE, NC 28203
 704-529-6500



DB 33102-400

CHARLOTTE
 ENGINEERING & PROPERTY MANAGEMENT

STATE STREET PEDESTRIAN IMPROVEMENT PROJECT
 PROPERTY ACQUISITION
 OWNER: CHESHIRE SEVERVILLE LLC
 CHARLOTTE, MECKLENBURG CO., NC

REVISIONS
 REV 08-07-18
 SCALE 1" = 40'
 DRAWN BY: RRH
 DATE 05/31/2018

JOB NO. P1MES181539
 FILE NO. -
 SHEET 2 OF 2
 CHECKED BY SURVEY SUPVR.