

I, JAMES E. DAVIS, CERTIFY THAT THIS PLAT WAS PREPARED UNDER MY SUPERVISION AND THAT THE PLAT WAS PREPARED FOR THE PURPOSE OF ACQUISITION AND EASEMENTS ONLY, AND IS NOT INTENDED TO BE A BOUNDARY SURVEY OF PROPERTY SHOWN.

J. E. Davis
JAMES E. DAVIS, NC P.L.S. L-3747 DATE

State of North Carolina
 County of Mecklenburg

_____, Review Officer of Mecklenburg County, certify that the map or plat to which this certification is affixed meets all statutory requirements for recording.

Review Officer _____ Date _____

NOTE:

- HORIZONTAL DATUM FOR PROJECT IS NC GRID NAD83(2011) AND VERTICAL DATUM IS NAVD88 FROM GPS OBSERVATIONS COMPLETED ON APRIL 04, 2017 UTILIZING THE NC VRS NETWORK. NCGS POINT "NC77" WAS UTILIZED AS THE NETWORK BASE AND NGS GEOID 12B WAS THE GEOID MODEL. THE LOCALIZATION POINT FOR THE PROJECT WAS MERRICK #205 HAVING NC GRID COORDINATES OF N=549229.675 FEET E=1443218.005 FEET, ELEVATION=695.98 FEET AND A COMBINED FACTOR OF 0.999844756.
- ALL DISTANCES SHOWN ARE HORIZONTAL GROUND DISTANCES.
- AREAS DETERMINED BY COORDINATE COMPUTATIONS.
- TRAVERSE ADJUSTED BY LEAST SQUARE ADJUSTMENT METHOD.

Parcel Line Table

Line #	Length	Direction
L1	50.47	S57° 22' 08"E
L2	30.00	S56° 35' 37"E
L3	23.65	S58° 29' 15"E
L4	13.99	S7° 54' 58"E
L5	3.72	S7° 54' 58"E
L6	77.47	S82° 18' 46"W
L7	4.33	N9° 02' 58"W
L8	80.73	N9° 02' 58"W
L9	21.49	N82° 23' 39"E
L10	9.87	S84° 36' 26"E
L11	20.60	N82° 20' 01"E
L12	25.91	N78° 38' 05"E
L13	55.14	S82° 18' 50"W

LEGEND

- COMPUTED POINT
- IRON PIN FOUND
- PROPERTY LINE
- TEMP. CONSTRUCTION EASEMENT

- AREAS:**
- | | | |
|-------------------------------|-------|---------|
| 1. TOTAL AREA | 3,994 | SQ. FT. |
| 2. TEMP CONSTRUCTION EASEMENT | 242 | SQ. FT. |
| 3. AREA REMAINING | 3,994 | SQ. FT. |

PREPARED BY:
MERRICK & COMPANY
 1001 MOREHEAD SQUARE DR.
 SUITE 530
 CHARLOTTE, NC 28203
 704-529-6500



DB 33192-446

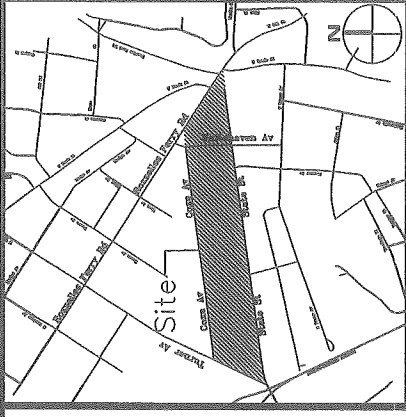

VICINITY MAP (NOT TO SCALE)

J. E. Davis
 SEAL PROFESSIONAL LAND SURVEYOR
 JAMES E. DAVIS
 L-3747
 B. 1.18

NC GRID NAD 83 (2011)

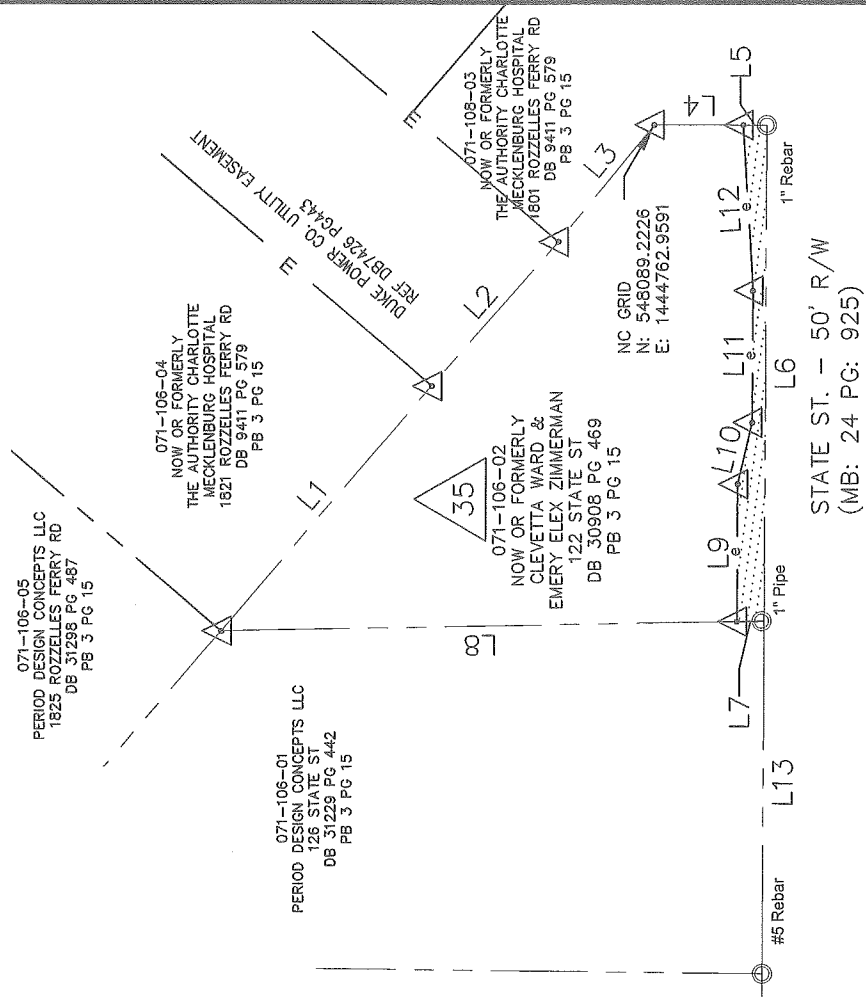

STATE ST. - 50' R/W
 (MB: 24 PG: 925)

CHARLOTTE
 ENGINEERING & PROPERTY MANAGEMENT

STATE STREET PEDESTRIAN IMPROVEMENT PROJECT

PROPERTY ACQUISITION
 OWNER: CLEVVETTA WARD & EMORY ELEXIS ZIMMERMAN
 CHARLOTTE, MECKLENBURG CO., NC

REVISIONS

SCALE 1" = 30'

DRAWN BY: RRR
 DATE: 05/31/2018
 CHECKED BY: SURVEY SUPVR.

JOB NO. PMES181539
 FILE NO. _____
 SHEET 1 OF 1