

I, JAMES E. DAVIS, CERTIFY THAT THIS PLAT WAS PREPARED UNDER MY SUPERVISION AND THAT THE PLAT WAS PREPARED FOR THE PURPOSE OF ACQUISITION AND EASEMENTS ONLY, AND IS NOT INTENDED TO BE A BOUNDARY SURVEY OF PROPERTY SHOWN.

J. E. Davis
JAMES E. DAVIS, NC P.L.S. L-3747 DATE _____



State of North Carolina
 County of Mecklenburg

_____, Review Officer of Mecklenburg County, certify that the map or plat to which this certification is affixed meets all statutory requirements for recording.

Review Officer _____ Date _____

- NOTE:**
- HORIZONTAL DATUM FOR PROJECT IS NC GRID NAD83(2011) AND VERTICAL DATUM IS NAVD88 FROM GPS OBSERVATIONS COMPLETED ON APRIL 04, 2017 UTILIZING THE NC VRS NETWORK. NCGS POINT "NC77" WAS UTILIZED AS THE NETWORK BASE AND NGS GEOID 12B WAS THE GEOID MODEL. THE LOCALIZATION POINT FOR THE PROJECT WAS MERRICK #205 HAVING NC GRID COORDINATES OF N=549229.675 FEET, E=1443216.005 FEET, ELEVATION=696.98 FEET AND A COMBINED FACTOR OF 0.999844756.
 - ALL DISTANCES SHOWN ARE HORIZONTAL GROUND DISTANCES.
 - AREAS DETERMINED BY COORDINATE COMPUTATIONS.
 - TRAVERSE ADJUSTED BY LEAST SQUARE ADJUSTMENT METHOD.

LEGEND

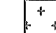
- COMPUTED POINT 
- IRON PIN FOUND 
- PROPERTY LINE 
- SIDEWALK UTILITY EASEMENT 

AREAS:

1. TOTAL AREA	24,489	SQ. FT.
2. SIDEWALK UTILITY EASEMENT	388	SQ. FT.
3. AREA REMAINING	24,489	SQ. FT.

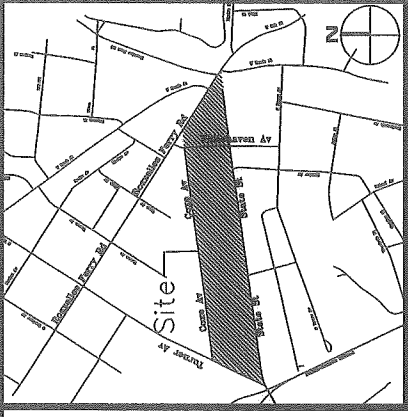

VICINITY MAP (NOT TO SCALE)

Line #	Length	Direction
L1	30.00	S57° 18' 37"E
L2	195.70	S57° 18' 37"E
L3	20.21	S25° 33' 06"E
L4	192.19	S82° 11' 03"W
L5	5.85	S82° 41' 55"W
L6	30.03	S82° 05' 02"W
L7	5.89	N7° 54' 58"W
L8	3.72	N7° 54' 58"W
L9	13.99	N7° 54' 58"W
L10	23.65	N57° 16' 21"W
L11	30.00	N57° 29' 58"W
L12	140.94	N32° 30' 02"E
L13	140.89	S32° 30' 02"W
L14	140.89	S32° 30' 02"W
L15	37.54	N57° 21' 34"W
L16	25.90	N7° 54' 58"W
L17	5.92	N78° 24' 50"E
L18	11.54	N7° 54' 58"W
L19	30.09	N78° 24' 50"E
L20	11.98	S7° 36' 21"E

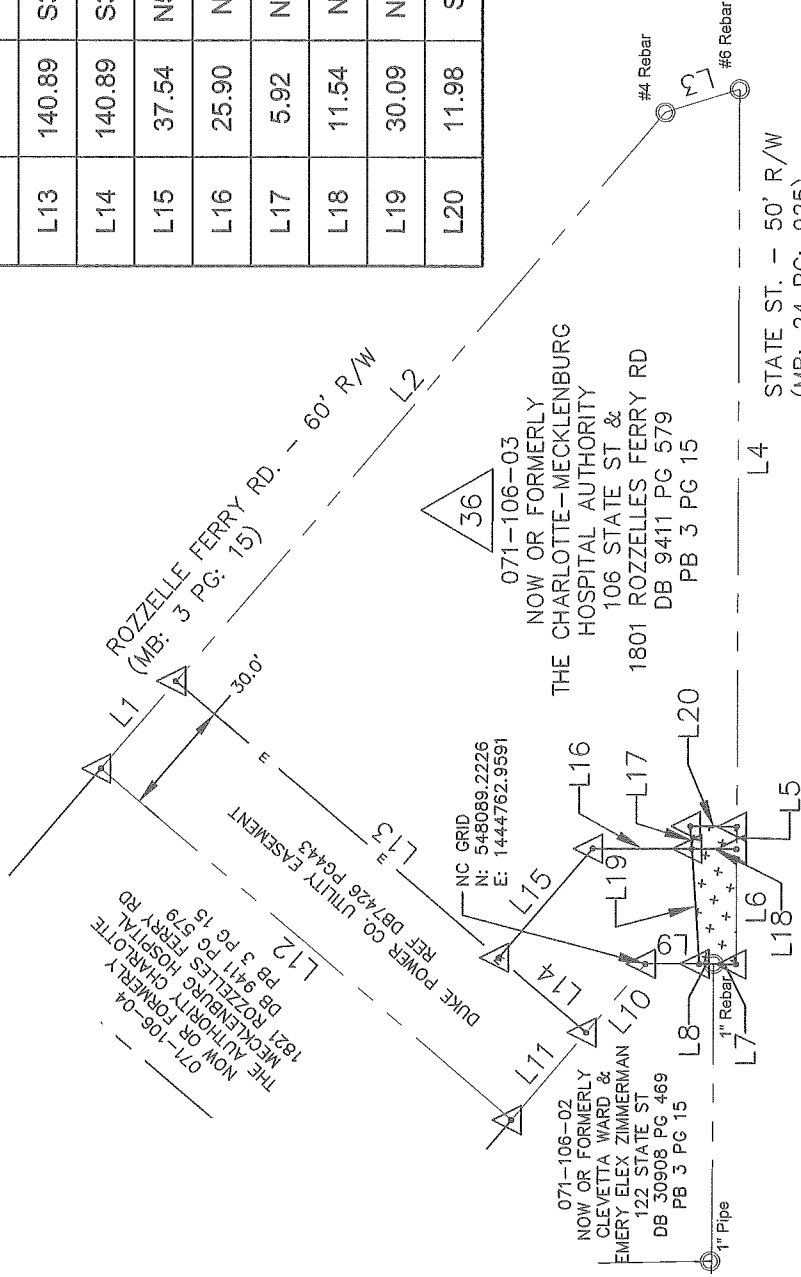

CHARLOTTE
 ENGINEERING & PROPERTY MANAGEMENT

REVISIONS

REV 08-07-18
 REV-1



DRAWN BY: RRH
 DATE: 07/16/2018

JOB NO. PME181539	FILE NO. -	SHEET 1	OF 1
STATE STREET PEDESTRIAN IMPROVEMENT PROJECT			
PROPERTY ACQUISITION OWNER: THE CHARLOTTE-MECKLENBURG HOSPITAL AUTHORITY CHARLOTTE, MECKLENBURG CO., NC			
CHECKED BY: SURVEY SUPVR.			1

PREPARED BY:
MERRICK & COMPANY
 1001 MOREHEAD SQUARE DR.
 SUITE 530
 CHARLOTTE, NC 28203
 704-529-6500

DB 33449-253