

I, DAVID H. SNIDER, CERTIFY THAT THIS PLAT WAS PREPARED UNDER MY SUPERVISION AND THAT THE PLAT WAS PREPARED FOR THE PURPOSE OF EASEMENTS ONLY, AND IS NOT INTENDED TO BE A BOUNDARY SURVEY OF PROPERTY SHOWN.

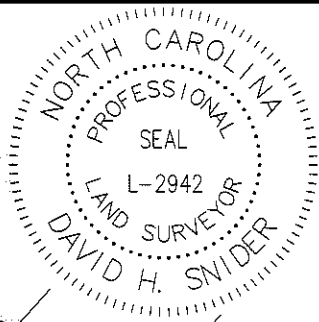

DAVID H. SNIDER, NC P.L.S. L-2942 DATE
David H. Snider 12/12/12

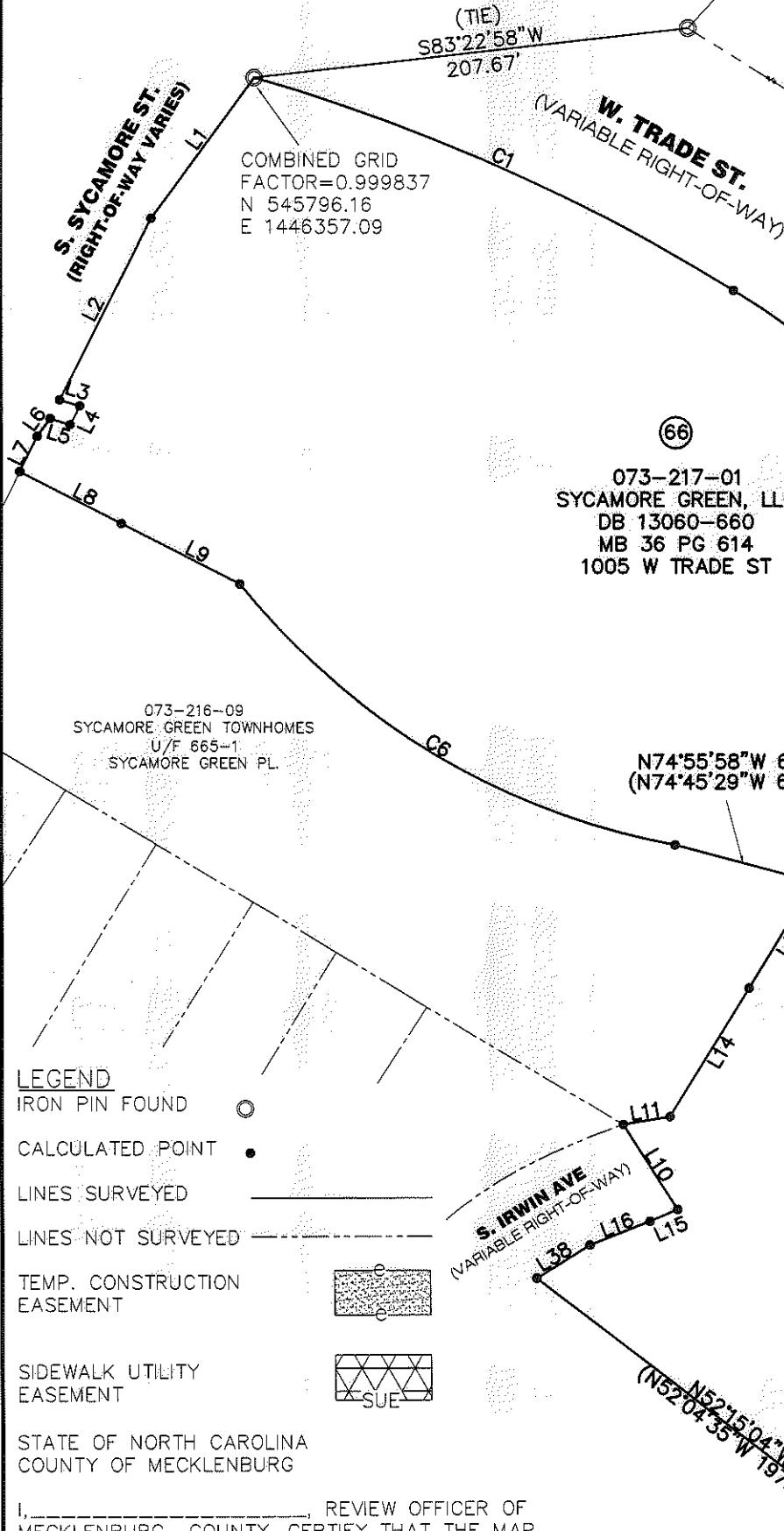
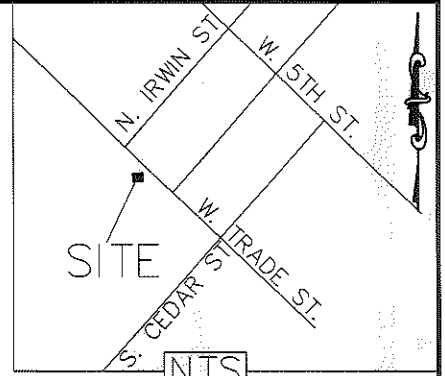

- 1) BEARINGS AND DISTANCES SHOWN IN PARENTHESES ARE BASED ON RECORDED MAP INFORMATION.
- 2) TOTAL AREA 176,048 SQ. FT.
- 3) TEMP. CONSTRUCTION EASEMENT 1,811 SQ. FT.
- 4) SIDEWALK UTILITY EASEMENT 640 SQ. FT.
- 5) AREA REMAINING 175,408 SQ. FT.

- LEGEND**
- IRON PIN FOUND
 - CALCULATED POINT
 - LINES SURVEYED
 - LINES NOT SURVEYED
 - TEMP. CONSTRUCTION EASEMENT
 - SIDEWALK UTILITY EASEMENT

STATE OF NORTH CAROLINA
 COUNTY OF MECKLENBURG

I, _____, REVIEW OFFICER OF MECKLENBURG COUNTY, CERTIFY THAT THE MAP OR PLAT TO WHICH THIS CERTIFICATION IS AFFIXED MEETS ALL STATUTORY REQUIREMENTS FOR RECORDING.

REVIEW OFFICER _____ DATE _____

PREPARED BY:
 CITY OF CHARLOTTE
 ENGINEERING DEPARTMENT
 600 EAST FOURTH STREET
 CHARLOTTE, NC 28202
 704-336-2291

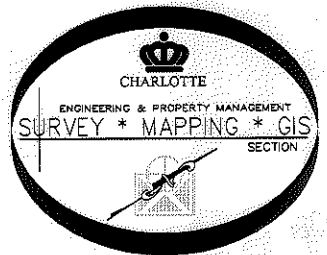

CHARLOTTE ENGINEERING DEPARTMENT		
REVISIONS 11/15/12 TCE REVISION 8/23/12 PROJECT TITLE 8/2/12 RECOMBINATION & SUE	JOHNSON & WALES WY/ 4TH ST./ TRADE ST. PROJECT	JOB NO. 512-08-018 208018
SCALE 1" = 80' 	PROPERTY OF SYCAMORE GREEN, LLC CHARLOTTE, MECKLENBURG CO., NC	SHEET 1 OF 3
DRAWN BY P.S.	CHECKED BY DS	SURVEY SUPR. <i>DS</i>
K:\AutoCad\En_su-LD4\208018 Johnson&Wales-4thst-Trade st\dwg\PLATS\#66 073-217-01		

ACQUISITION BY DB 28435 PG 530-535

I, DAVID H. SNIDER, CERTIFY THAT THIS PLAT WAS PREPARED UNDER MY SUPERVISION AND THAT THE PLAT WAS PREPARED FOR THE PURPOSE OF EASEMENTS ONLY, AND IS NOT INTENDED TO BE A BOUNDARY SURVEY OF PROPERTY SHOWN.

DAVID H. SNIDER, N.C.P.L.S. L-2942 DATE 12/12/12

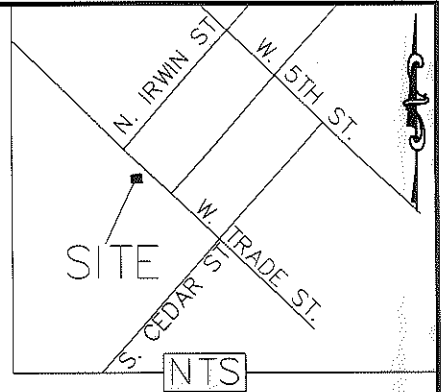
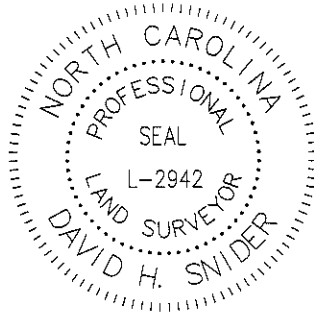

LINE	LENGTH	BEARING	(LENGTH)	(BEARING)
L1	83.52	S35°57'25"W	(83.52')	(S36°01'01"W)
L2	97.02	S26°37'45"W	(97.02')	(S26°41'21"W)
L3	10.00	S72°46'29"E	(10.00')	(S72°42'53"E)
L4	10.00	S26°37'45"W	(10.00')	(S26°41'21"W)
L5	10.00	N72°46'29"W	(10.00')	(N72°42'53"W)
L6	10.49	S35°34'24"W	(10.49')	(S35°38'00"W)
L7	18.65	S26°23'06"W	(18.65')	(S26°26'42"W)
L8	54.15	N62°50'47"W	(54.15')	(S62°40'18"E)
L9	63.15'	N62°50'47"W	(63.15')	(S62°40'18"E)
L10	48.20'	N32°11'36"W	(48.20')	(S32°01'07"E)
L11	22.40'	N80°35'02"E	(22.40')	(S80°45'31"W)
L12	7.51'	N74°55'58"W	(7.51')	(S74°45'29"E)
L13	59.39	N31°39'00"E	(59.39')	(S31°49'29"W)
L14	72.01'	N31°39'00"E	(72.01')	(N31°49'29"E)
L15	14.28'	N66°53'30"E	(14.28')	(S67°03'59"E)
L16	30.68'	N68°19'58"E	(30.68')	(N68°30'27"E)
L17	72.87'	S46°14'18"E		(S46°32'16"E)
L18	6.08'	N50°29'31"E		
L19	31.17'	S36°43'56"E		
L20	27.44'	N03°50'27"W	(28.28')	(N03°46'47"W)
L21	32.39'	N23°16'49"W		
L22	4.88'	S65°03'17"W		
L23	9.34'	S61°58'10"E		
L24	7.76'	N03°50'23"W	(7.76')	(N03°46'47"W)
L25	7.20'	N66°42'01"E		
L26	25.69'	S21°12'09"E		
L27	9.86'	S23°17'59"E		
L28	7.72'	N66°42'01"E		
L29	15.85'	S86°19'16"W		
L30	45.19'	N04°29'49"W		
L31	46.04'	N04°29'49"W		
L32	7.76'	S86°19'16"W		
L33	12.02'	S46°14'22"E		
L34	10.57'	S46°14'49"E		
L35	26.55'	N03°50'23"W		
L36	38.98'	S33°00'57"E		
L37	8.00'	S3°50'23"E		
L38	29.83'	N58°04'26"E		
L39	4.87'	N46°20'03"W		
L40	19.26'	S34°31'05"W		
L41	72.79'	S22°47'57"E		
L42	13.06'	S24°56'43"E		

1) BEARINGS AND DISTANCES SHOWN IN PARENTHESES ARE BASED ON RECORDED MAP INFORMATION.

- 2) TOTAL AREA 176,048 SQ. FT.
- 3) TEMP. CONSTRUCTION EASEMENT 1,811 SQ. FT.
- 4) SIDEWALK UTILITY EASEMENT 640 SQ. FT.
- 5) AREA REMAINING 175,408 SQ. FT.



CURVE	LENGTH	RADIUS	CHORD	BEARING
C1	250.36	905.94	249.56'	N66°00'18"W
C2	151.33	462.31	150.65'	S48°42'39"E
C3	37.20	462.31	37.19'	N25°26'39"W
C4	35.57	462.31	35.56'	N20°56'00"W
C5	39.54	462.31	39.53'	N16°16'46"W
C6	246.26	351.50	241.25'	N59°01'21"W
C7	12.84	462.31	12.84'	N13°02'02"W
C8	80.06	462.31	80.50'	S8°50'04"E
C9	94.89	462.31	94.72'	N33°37'41"W
C10	37.20	462.31	37.19'	S25°26'33"E
C11	35.57	462.31	35.56'	N20°56'00"W
C12	39.54	462.31	39.53'	N16°16'46"W

LEGEND

- IRON PIN FOUND
- CALCULATED POINT
- LINES SURVEYED
- LINES NOT SURVEYED
- TEMP. CONSTRUCTION EASEMENT
- SIDEWALK UTILITY EASEMENT

STATE OF NORTH CAROLINA
COUNTY OF MECKLENBURG

I, _____, REVIEW OFFICER OF MECKLENBURG COUNTY, CERTIFY THAT THE MAP OR PLAT TO WHICH THIS CERTIFICATION IS AFFIXED MEETS ALL STATUTORY REQUIREMENTS FOR RECORDING.

REVIEW OFFICER _____

DATE _____

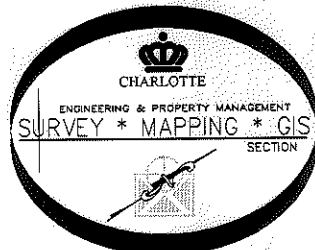

PREPARED BY:
CITY OF CHARLOTTE
ENGINEERING DEPARTMENT
600 EAST FOURTH STREET
CHARLOTTE, NC 28202
704-336-2291

		CHARLOTTE ENGINEERING DEPARTMENT
REVISIONS	JOHNSON & WALES WY/ 4TH ST./ TRADE ST. PROJECT	JOB NO. 512-08-018
11/15/12 TCE REVISION 8/23/12 PROJECT TITLE 8/2/12 RECOMBINATION & SUE		208018
SCALE 1" = 80'	PROPERTY OF SYCAMORE GREEN, LLC CHARLOTTE, MECKLENBURG CO., NC	SHEET 2 OF 3
DRAWN BY P.S.	CHECKED BY DS	SURVEY SUPVR.
DATE		

ACQUISITION BY DB 28435 PG 530-535

I, DAVID H. SNIDER, CERTIFY THAT THIS PLAT WAS PREPARED UNDER MY SUPERVISION AND THAT THE PLAT WAS PREPARED FOR THE PURPOSE OF EASEMENTS ONLY, AND IS NOT INTENDED TO BE A BOUNDARY SURVEY OF PROPERTY SHOWN.

DAVID H. SNIDER, NCP.L.S. L-2942 DATE
David H. Snider 12/12/12

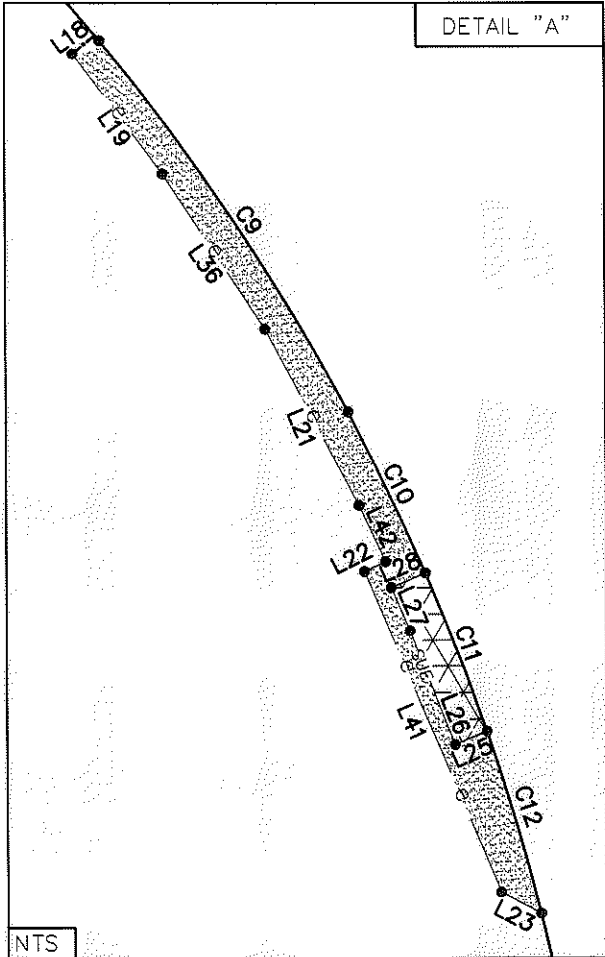
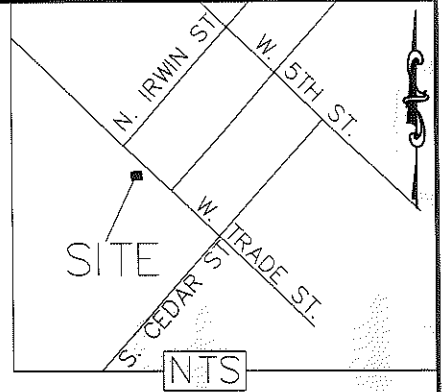

- 1) BEARINGS AND DISTANCES SHOWN IN PARENTHESES ARE BASED ON RECORDED MAP INFORMATION.
- 2) TOTAL AREA 176,048 SQ. FT.
- 3) TEMP. CONSTRUCTION EASEMENT 1,811 SQ. FT.
- 4) SIDEWALK UTILITY EASEMENT 640 SQ. FT.
- 5) AREA REMAINING 175,408 SQ. FT.



- LEGEND**
- IRON PIN FOUND
 - CALCULATED POINT
 - LINES SURVEYED
 - LINES NOT SURVEYED
 - TEMP. CONSTRUCTION EASEMENT
 - SIDEWALK UTILITY EASEMENT

STATE OF NORTH CAROLINA
 COUNTY OF MECKLENBURG

I, _____, REVIEW OFFICER OF MECKLENBURG COUNTY, CERTIFY THAT THE MAP OR PLAT TO WHICH THIS CERTIFICATION IS AFFIXED MEETS ALL STATUTORY REQUIREMENTS FOR RECORDING.

REVIEW OFFICER _____

DATE _____

PREPARED BY:
 CITY OF CHARLOTTE
 ENGINEERING DEPARTMENT
 600 EAST FOURTH STREET
 CHARLOTTE, NC 28202
 704-336-2291

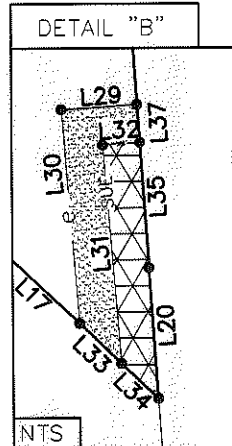
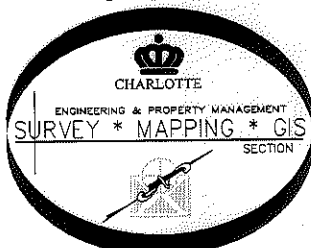

		CHARLOTTE ENGINEERING DEPARTMENT
JOHNSON & WALES WY/ 4TH ST./ TRADE ST. PROJECT		JOB NO. 512-08-018
PROPERTY OF SYCAMORE GREEN, LLC CHARLOTTE, MECKLENBURG CO., NC		208018
SCALE 1" = 80'		SHEET 3
DRAWN BY P.S.		OF 3
DATE _____		CHECKED BY DS SURVEY SUPVR. <i>DS</i>
K:\AutoCad\En_su-LD4\208018 Johnson&Wales-4thst-Trade st\dwg\PLATS\#66 073-217-01		

ACQUISITION BY DB 28435 PG 518-535