

This Plat was prepared under my supervision
Wayne B. Caldwell L-1909
 N. C. Registered Surveyor Reg. No.

NOTE: Property corners shown circled were located by actual survey. Bearings are based on _____ SURVEY.

This map was prepared for the purpose of obtaining right of way only and is not intended to be a boundary survey of the property shown.

TOTAL AREA: 23,858.89 SQ. FT. = 0.548 ACRES
 AREA TAKEN: 1,515.16 SQ. FT. = 0.035 ACRES
 AREA REMAINING 22,343.73 SQ. FT. = 0.513 ACRES

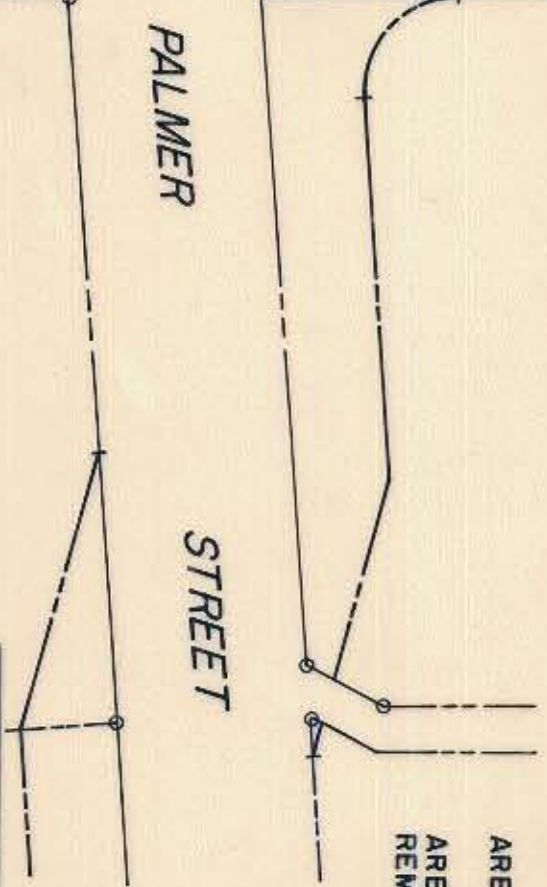

CITY OF CHARLOTTE NORTH CAROLINA		JOB NO. 75175
COMMUNITY DEVELOPMENT DEPARTMENT		FILE NO.
REVISIONS	WEST PALMER STREET	SHEET
DRAWN BY C.T.A.	PROPERTY OF	1
CHECKED BY S.A.G.	LORAIN T. KINNEY	OF
DATE June, 1977	SCALE 1" = 40'	18

73-267-05