

I, DANIEL E. SMITH, CERTIFY THAT THIS PLAT WAS PREPARED UNDER MY SUPERVISION AND THAT THE PLAT WAS PREPARED FOR THE PURPOSE OF ACQUISITION AND EASEMENTS ONLY, AND IS NOT INTENDED TO BE A BOUNDARY SURVEY OF PROPERTY SHOWN!

DANIEL E. SMITH N.C.P.L.S. L-4338 DATE 06/03/09

State of North Carolina  
County of Mecklenburg

I, Daniel E. Smith, Review Officer of Mecklenburg County, certify that the map or plat to which this certification is affixed meets all statutory requirements for recording.

Review Officer \_\_\_\_\_ Date \_\_\_\_\_

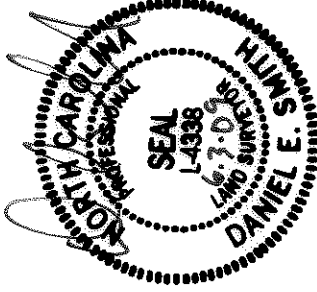

VICINITY MAP (NOT TO SCALE)

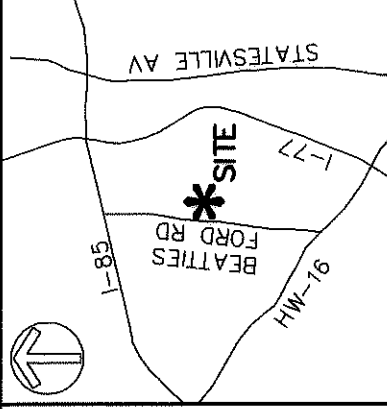

**LEGEND**

- IRON PIN FOUND ○
- TEMPORARY CONSTRUCTION EASEMENT [Dotted Pattern]
- SIDEWALK/UTILITY EASEMENT [Hatched Pattern]

SIDEWALK/UTILITY EASEMENT LINE  
SIDEWALK/UTILITY EASEMENT

ST LUKE STREET  
(50' R/W)  
(S83°45'00"E 100.00')

14+62.41  
23.91 RT.

125.00  
(N06°15'00"E 125.00')

113.20  
N05°43'37"E

125.00  
(N06°15'00"E 125.00')

119.02  
N05°51'44"E

119.02  
N05°51'44"E

119.02  
N05°51'44"E

119.02  
N05°51'44"E

119.02  
N05°51'44"E

119.02  
N05°51'44"E

119.02  
N05°51'44"E

119.02  
N05°51'44"E

119.02  
N05°51'44"E

119.02  
N05°51'44"E

119.02  
N05°51'44"E

119.02  
N05°51'44"E

119.02  
N05°51'44"E

119.02  
N05°51'44"E

119.02  
N05°51'44"E

119.02  
N05°51'44"E

119.02  
N05°51'44"E

119.02  
N05°51'44"E

119.02  
N05°51'44"E

119.02  
N05°51'44"E

119.02  
N05°51'44"E

119.02  
N05°51'44"E

119.02  
N05°51'44"E

119.02  
N05°51'44"E

119.02  
N05°51'44"E

119.02  
N05°51'44"E

119.02  
N05°51'44"E

119.02  
N05°51'44"E

119.02  
N05°51'44"E

119.02  
N05°51'44"E

LINE	LENGTH	BEARING
L1	5.98	N05°51'44"E
L2	36.20	S84°12'17"E
L3	2.59	S05°43'37"W
L4	9.21	S05°43'37"W
L5	1.44	S68°09'21"W
L6	9.85	N84°23'18"W
L7	7.07	N61°49'33"W
L8	14.29	N86°03'30"W
L9	6.54	S44°03'17"W
L10	2.90	N86°03'30"W
L11	8.55	N50°17'33"W
L12	16.73	N86°03'30"W
L13	7.23	N61°55'44"W

075-032-01  
WILLIE LOUISE STANARD  
DB 8462 PG 664  
2025 ST LUKE ST.

NOTE:  
1) BEARINGS AND DISTANCES SHOWN IN PARENTHESES ARE BASED ON RECORDED MAP INFORMATION.

- 2) TOTAL AREA 12,518 SQ.FT.
- 3) CONSTRUCTION EASEMENT 888 SQ.FT.
- 4) SIDEWALK/UTILITY EASEMENT 162 SQ.FT.
- 5) AREA REMAINING 12,518 SQ.FT.

075-032-02  
MANGIE MCQUEEN  
DB 03903 PG 480  
2028 ST MARK ST.

CURVE	RADIUS	LENGTH	CHORD	BEARING
C1	37930.60	57.11	57.11	S84°21'17"E

PREPARED BY:  
**MFKIM & CREED**  
ENGINEERS, PLANNERS, SURVEYORS  
8020 TOWER POINT DRIVE  
CHARLOTTE, NORTH CAROLINA 28227  
PHONE (704) 841-2588  
FAX (704) 841-2567  
C-0542



CHARLOTTE  
ENGINEERING & PROPERTY MANAGEMENT

REVISIONS	DATE 05/05/09	DRAWN BY MDB	CHECKED BY MDB	SURVEY SUPERV. DES
LINCOLN/WILSON HEIGHTS NEIGHBORHOOD IMPROVEMENT		JOB NO. 512-07-039		
EASEMENT ACQUISITION OWNER: WILLIE LOUISE STANARD		FILE NO. X000X		
CHARLOTTE, MECKLENBURG CO., NC		SHEET 1		
		OF 1		

I, DANIEL E. SMITH, CERTIFY THAT THIS PLAT WAS PREPARED UNDER MY SUPERVISION AND THAT THE PLAT WAS PREPARED FOR THE PURPOSE OF ACQUISITION AND EASEMENTS ONLY, AND IS NOT INTENDED TO BE A BOUNDARY SURVEY OF PROPERTY SHOWN

DANIEL E. SMITH N.C.P.L.S. L-4338 08/12/09  
DATE

State of North Carolina  
County of Mecklenburg

I, Daniel E. Smith, Review Officer of Mecklenburg County, certify that the map or plat to which this certification is affixed meets all statutory requirements for recording.

Review Officer \_\_\_\_\_ Date \_\_\_\_\_

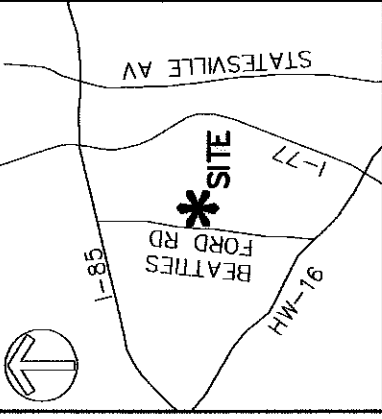

VICINITY MAP (NOT TO SCALE)

LEGEND

- IRON PIN FOUND ○
- TEMPORARY CONSTRUCTION EASEMENT [Hatched Box]
- SIDEWALK/UTILITY EASEMENT [Dashed Box]

SIDEWALK/UTILITY EASEMENT LINE

SIDEWALK/UTILITY EASEMENT

ST LUKE STREET  
(50' R/W)  
100.00'

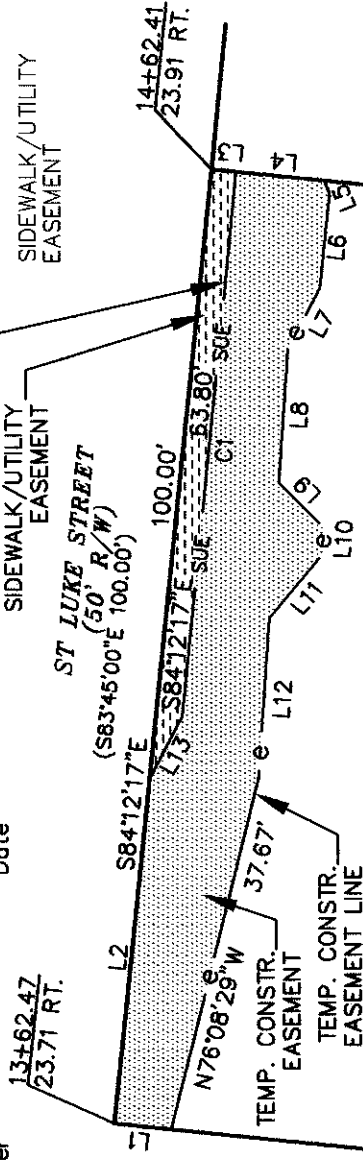

LINE	LENGTH	BEARING
L1	5.98	N05°51'44\"E
L2	36.20	S84°12'17\"E
L3	2.59	S08°43'37\"W
L4	9.21	S08°43'37\"W
L5	1.44	S68°09'21\"W
L6	9.85	N84°23'18\"W
L7	7.07	N61°49'33\"W
L8	14.29	N86°03'30\"W
L9	6.54	S44°03'17\"W
L10	2.90	N86°03'30\"W
L11	8.55	N50°17'33\"W
L12	16.73	N86°03'30\"W
L13	7.23	N61°55'44\"W

075-032-01  
WILLIE LOUISE STANARD  
DB. 8462 PG. 664  
WB. 03-E-1624  
2025 ST LUKE ST.

NOTE:  
1) BEARINGS AND DISTANCES SHOWN IN PARENTHESES ARE BASED ON RECORDED MAP INFORMATION.

- 2) TOTAL AREA 12,518 SQ.FT.
- 3) CONSTRUCTION EASEMENT 888 SQ.FT.
- 4) SIDEWALK/UTILITY EASEMENT 162 SQ.FT.
- 5) AREA REMAINING 12,518 SQ.FT.

075-032-02  
MANGIE MCQUEEN  
DB 03903 PG 480  
2028 ST MARK ST.

CURVE RADIUS	LENGTH	CHORD	BEARING
C1	37930.60	57.11	S84°21'17\"E

PREPARED BY:  
**MFKIM & CREED**  
ENGINEERS, PLANNERS, SURVEYORS  
8020 TOWER POINT DRIVE  
CHARLOTTE, NORTH CAROLINA 28227  
PHONE (704) 841-2588  
FAX (704) 841-2567  
C-0342



CHARLOTTE  
ENGINEERING & PROPERTY MANAGEMENT

LINCOLN/WILSON HEIGHTS  
NEIGHBORHOOD IMPROVEMENT

EASEMENT ACQUISITION  
OWNER: WILLIE LOUISE  
STANARD

CHARLOTTE, MECKLENBURG CO., NC  
SURVEY SUPERVISOR: DES

REVISIONS  
08/12/09-REV. DEED REFERENCE

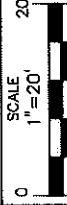

DRAWN BY MDB

DATE 05/05/09

CHECKED BY MDB

JOB NO. 512-07-039  
FILE NO. XXXXX  
SHEET 1 OF 1

RECORDED IN CITY BOOK 25184-123 DATE 10-29-09



075-032-11  
WILLIE LOUISE STANARD  
DB. 8462 PG. 664  
WB. 03-E-1624



075-032-03  
ANNA M. FERGUSON  
DB 8666 PG 398  
2020 ST MARK ST.