

I, DAVID H. SNIDER, CERTIFY THAT THIS PLAT WAS PREPARED UNDER MY SUPERVISION AND THAT THE PLAT WAS PREPARED FOR THE PURPOSE OF ACQUISITION AND EASEMENTS ONLY, AND IS NOT INTENDED TO BE A BOUNDARY SURVEY OF PROPERTY SHOWN.

David H. Snider 11/20/12
 DAVID H. SNIDER, NC P.L.S. L-2942 DATE

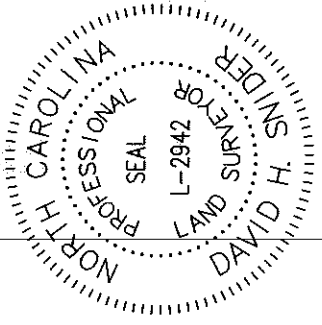

07504238
 MECKLENBURG COUNTY
 DB 17350/PG 594
 1819 CATHERINE SIMMONS AVENUE

CATHERINE SIMMONS AVENUE
 (50' PUBLIC R/W)

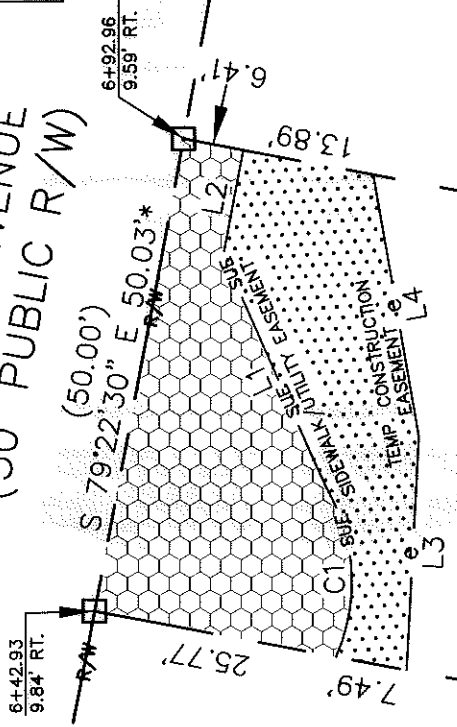

N 10°37'30\"/>
 116.74' (150.00')* (TOTAL)
 N 79°22'30\"/>
 (50.00')
 MECKLENBURG COUNTY
 DB 17863/PG 944
 2028 HAINES STREET

⑤
 07504237
 MECKLENBURG COUNTY
 DB 18181/PG 637
 1815 CATHERINE SIMMONS AVENUE

129.70'
 S 10°37'30\"/>
 W 150.00'* (TOTAL)
 150.00'

⑥
 07504236
 MECKLENBURG COUNTY
 DB 18092/PG 140
 1811 CATHERINE SIMMONS AVENUE

STATE OF NORTH CAROLINA
 COUNTY OF MECKLENBURG

REVIEW OFFICER OF
 MECKLENBURG COUNTY, CERTIFY THAT THE MAP
 OR PLAT TO WHICH THIS CERTIFICATION IS AFFIXED
 MEETS ALL STATUTORY REQUIREMENTS FOR
 RECORDING.

REVIEW OFFICER _____ DATE _____

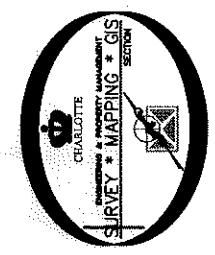
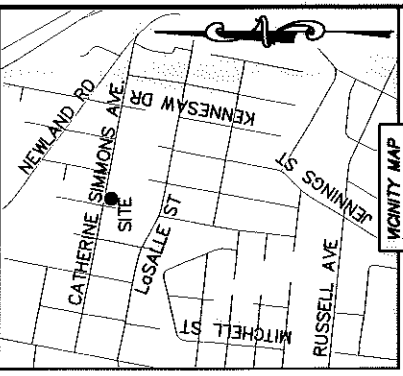

| LINE TABLE | | |
|------------|--------|----------------------------|
| LINE | LENGTH | BEARING |
| L1 | 26.28' | N 65°40'42\"/> E |
| L2 | 11.18' | S 79°05'24\"/> E |
| L3 | 24.42' | S 87°05'09\"/> E |
| L4 | 27.58' | N 80°05'31\"/> E |

| CURVE TABLE | | |
|-------------|------------------|-----------------------------------|
| CURVE | RADIUS & ARC | CHORD |
| C1 | R=19.70 L=18.53' | N 86°29'53\"/> E 17.86' |

NOTE:
 1) BEARINGS AND DISTANCE SHOWN IN PARENTHESIS ARE BASED ON RECORDED INFORMATION.
 2) COMPUTED PROJECT DISTANCE -- *
 3) TOTAL AREA 7,500 SQ.FT.
 4) TEMP. CONSTRUCTION EASEMENT 610 SQ.FT.
 5) SIDEWALK/UTILITY EASEMENT 804 SQ.FT.
 6) TOTAL AREA REMAINING 7,500 SQ.FT.
 7) MECKLENBURG COUNTY OWNER OF PARCELS #2 TO #21.

LEGEND

- REBAR OR IRON PIN FOUND
- COMPUTED POINT
- PROPERTY LINES
- EXISTING RIGHT-OF-WAY
- SIDEWALK/UTILITY EASEMENT
- TEMP. CONSTRUCTION EASEMENT
- TEMP. CONSTRUCTION EASEMENT
- SIDEWALK/UTILITY EASEMENT

PREPARED BY:
 CITY OF CHARLOTTE
 ENGINEERING & PROPERTY MANAGEMENT
 600 EAST FOURTH STREET
 CHARLOTTE, NC 28202
 704-336-2291

| | | | |
|---|--|------------------------|------------|
| CHARLOTTE ENGINEERING & PROPERTY MANAGEMENT | | JOB NO. | 512-07-082 |
| | | FILE NO. | 075-042-37 |
| REVISIONS CATHERINE SIMMONS AVE. SIDEWALK | | SHEET | 1 |
| SCALE 1"=20' DRAWN BY LG DATE | | PROPERTY ACQUISITION | OF |
| OWNER: MECKLENBURG COUNTY CHARLOTTE, MECKLENBURG CO., NC | | SURVEY SUPV. <i>DK</i> | 1 |
| K:\AUTOCAD\EN_SJ-LD4\207082-CATHERINESIMMONS\DWG\CATHERINESIMMONS\PIPLATS.DWG | | | |