

I, DAVID H. SNIDER, CERTIFY THAT THIS PLAT WAS PREPARED UNDER MY SUPERVISION AND THAT THE PLAT WAS PREPARED FOR THE PURPOSE OF ACQUISITION AND EASEMENTS ONLY, AND IS NOT INTENDED TO BE A BOUNDARY SURVEY OF PROPERTY SHOWN.

David H. Snider 11/20/12
 DAVID H. SNIDER, NC P.L.S. L-2942 DATE

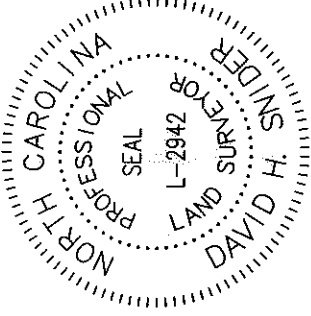

07504335
 MECKLENBURG COUNTY
 DB 18181/PG 637
 1705 CATHERINE SIMMONS AVENUE

07504341
 MECKLENBURG COUNTY
 DB 18181/PG 637
 1701 CATHERINE SIMMONS AVENUE

07504339
 MECKLENBURG COUNTY
 DB 17907/PG 373
 2029 JENNINGS STREET

LEGEND

- REBAR OR IRON PIN FOUND
- COMPUTED POINT
- PROPERTY LINES
- EXISTING RIGHT-OF-WAY
- SIDEWALK/UTILITY EASEMENT
- TEMP. CONSTRUCTION EASEMENT
- TEMP. CONSTRUCTION EASEMENT
- SIDEWALK/UTILITY EASEMENT

PREPARED BY:
 CITY OF CHARLOTTE
 ENGINEERING & PROPERTY MANAGEMENT
 600 EAST FOURTH STREET
 CHARLOTTE, NC 28202
 704-336-2291

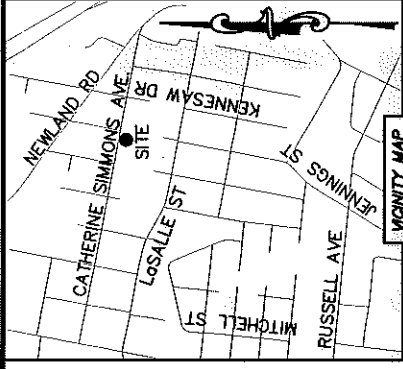

CATHERINE SIMMONS AVENUE
 (50' PUBLIC R/W)

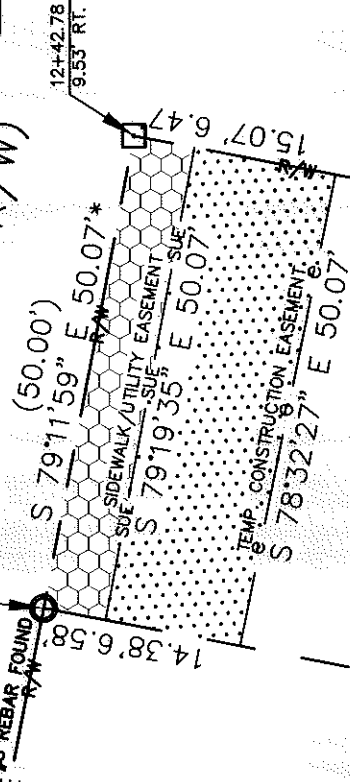

JENNINGS STREET
 (50' PUBLIC R/W-NOT OPEN)

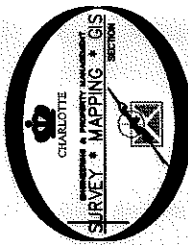

STATE OF NORTH CAROLINA
 COUNTY OF MECKLENBURG

REVIEW OFFICER OF MECKLENBURG COUNTY, CERTIFY THAT THE MAP OR PLAT TO WHICH THIS CERTIFICATION IS AFFIXED MEETS ALL STATUTORY REQUIREMENTS FOR RECORDING.

REVIEW OFFICER _____ DATE _____

- NOTE:
- 1) BEARINGS AND DISTANCE SHOWN IN PARENTHESIS ARE BASED ON RECORDED INFORMATION.
 - 2) COMPUTED PROJECT DISTANCE - * 7,500 SQ.FT.
 - 3) TOTAL AREA 737 SQ.FT.
 - 4) TEMP. CONSTRUCTION EASEMENT 327 SQ.FT.
 - 5) SIDEWALK/UTILITY EASEMENT 7,500 SQ.FT.
 - 6) TOTAL AREA REMAINING 7,500 SQ.FT.
 - 7) MECKLENBURG COUNTY OWNER OF PARCELS #2 TO #21.

		JOB NO. 512-07-082 FILE NO. 075-043-41 SHEET 1 OF 1
		CATHERINE SIMMONS AVE. SIDEWALK
SCALE 1" = 20' DRAWN BY LG DATE	PROPERTY ACQUISITION OWNER: MECKLENBURG COUNTY CHARLOTTE, MECKLENBURG CO., NC	CHECKED BY: DHS SURVEY SUPR. <i>[Signature]</i>
K:\AUTOCAD\EN_LSU-LD\207082-CATHERINESIMMONS\DWG\CATHERINESIMMONS\PLATS.DWG		

ACQUISITION BY DB 20873 PG 47L