

THIS PLAT WAS PREPARED UNDER MY SUPERVISION

R. Dennis Smith 12-11-92

N.C. REG. LAND SURVEYOR NO. L - 1482

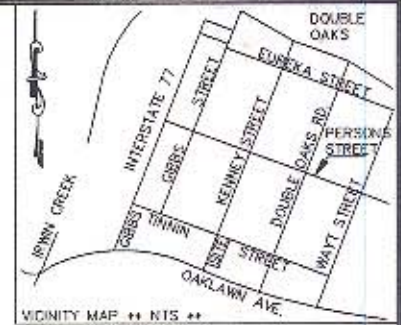

MB 6 PG 216

SEE DETAIL

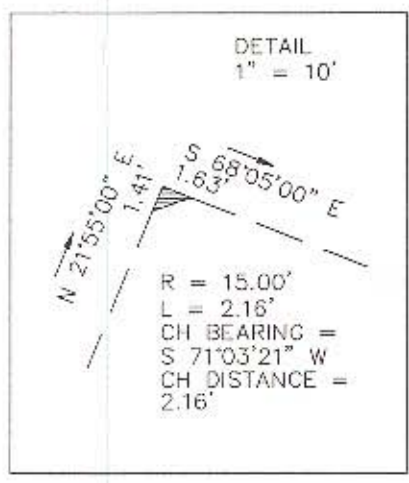

LEGEND

- IRON PIN FOUND
- ▭ AREA IN PERMANENT SIDEWALK EASEMENT

THIS PLAT WAS PREPARED FOR PURPOSE OF ACQUIRING A PERMANENT SIDEWALK EASEMENT ONLY AND IS NOT INTENDED TO BE A BOUNDARY SURVEY OF THE PROPERTY SHOWN.

NOTES

- 1) BROKEN LINES INDICATE PROPERTY NOT SURVEYED.
- 2) BEARINGS AND DISTANCES IN PARENTHESES ARE BASED ON DEED INFORMATION.
- 3) TOTAL AREA BY DEED 5,500 SQ. FT.
- 4) AREA IN PERMANENT SIDEWALK EASEMENT 1 SQ. FT.
- 5) AREA REMAINING 5,499 SQ. FT.

PREPARED BY:
CITY OF CHARLOTTE
ENGINEERING DEPARTMENT
600 EAST FOURTH STREET
CHARLOTTE, NC 28202
704-336-2291

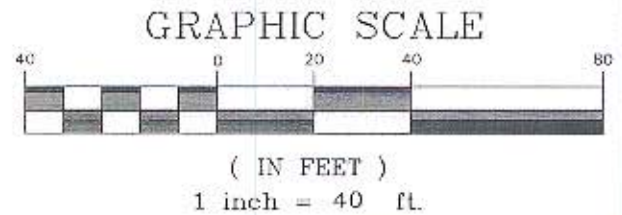

		CHARLOTTE ENGINEERING DEPARTMENT
REVISIONS	GENESIS PARK PERM SIDEWALK EASEMENT CHARLOTTE, MECKLENBURG CO., NC	JOB NO. 91060
	PROPERTY OF S. ATLANTIC CONF. ASSOC. OF 7TH DAY ADVENT.	FILE NO.
DRAWN BY DB		ESMTJB
CHECKED BY <i>RSJ</i>		SHEET 1
SURVEY SUPERVISOR	DATE 12-1-92	SCALE 1"=40' OF 1