

I, DAVID H. SNIDER, CERTIFY THAT THIS PLAT WAS PREPARED UNDER MY SUPERVISION AND THAT THE PLAT WAS PREPARED FOR THE PURPOSE OF EASEMENTS ONLY, AND IS NOT INTENDED TO BE A BOUNDARY SURVEY OF PROPERTY SHOWN. FURTHER, WITH RESPECT TO SUCH EASEMENTS, I HEREBY CERTIFY TO SOUTHPORT INVESTMENTS, LLC, THAT THE DERIVATIONS SHOWN ON THIS SURVEY REFERENCE THE TRUE AND CORRECT VESTING DEEDS FOR PARCEL 078-124-01.

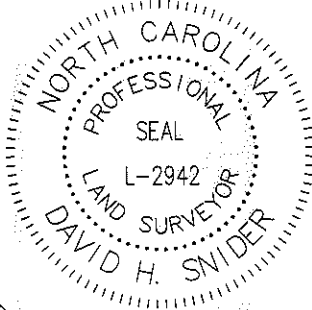

*David H. Snider* 3/12/13  
 DAVID H. SNIDER, NC P.L.S. L-2942 DATE

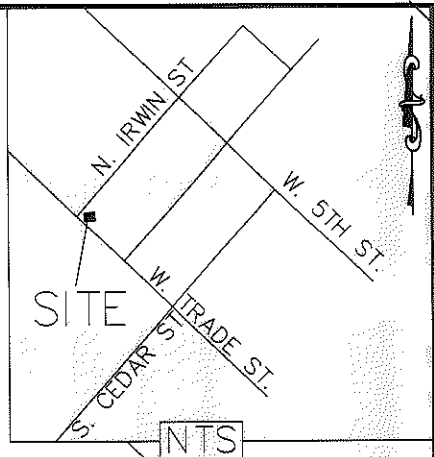

Line Table		
Line #	Length	Direction
L1	21.77	S89°42'40"E
L2	12.15	N10°39'06"W
L3	10.18	S89°52'43"E
L4	2.00	N00°07'17"E
L5	3.04	S48°58'50"E
L6	7.38	S89°52'43"E
L7	9.69	S89°52'43"E
L8	7.64	S48°58'50"E
L9	7.62	S48°58'50"E

078-153-14  
 NATIONSBANK NA AND  
 C/O COUSINS PROPERTIES  
 125 N IRWIN AV  
 DB 9935-080

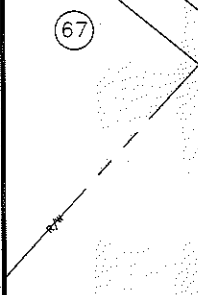

Curve Table				
Curve #	Length	Radius	CHORD BEARING	CHORD
C1	23.67	15.00	S87°54'00"W	21.29

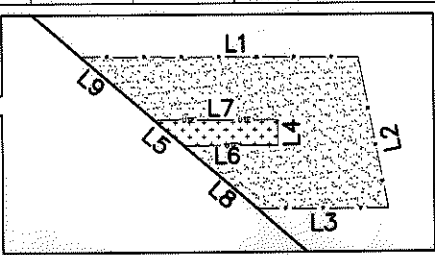

- 1) BEARINGS AND DISTANCES SHOWN IN PARENTHESES ARE BASED ON RECORDED MAP INFORMATION.
- 2) TOTAL AREA 62,024 SQ. FT.
- 3) TEMP. CONSTRUCTION EASEMENT 174 SQ. FT.
- 4) UTILITY EASEMENT 17 SQ. FT.
- 5) AREA REMAINING 62,024 SQ. FT.

078-124-01  
 SOUTHPORT INVESTMENTS, L.L.C.  
 DB 10103 PG 399, DB 9301 PG  
 550, AND DB 9448 PG 272  
 900 W TRADE ST

078-124-02  
 CHARLOTTE GATEWAY  
 VILLAGE LLC AND C/O  
 COUSINS PROPERTIES  
 DB 10126 PG 259  
 800 W TRADE ST

STATE OF NORTH CAROLINA  
 COUNTY OF MECKLENBURG

COMBINED GRID  
 FACTOR=0.999837  
 N 545437.53  
 E 1447078.79

LEGEND

- IRON PIN FOUND ○
- CALCULATED POINT ●
- LINES SURVEYED ———
- LINES NOT SURVEYED - - - - -
- TEMP. CONSTRUCTION EASEMENT [Pattern]
- UTILITY EASEMENT [Pattern]

I, \_\_\_\_\_, REVIEW OFFICER OF MECKLENBURG COUNTY, CERTIFY THAT THE MAP OR PLAT TO WHICH THIS CERTIFICATION IS AFFIXED MEETS ALL STATUTORY REQUIREMENTS FOR RECORDING.

REVIEW OFFICER \_\_\_\_\_ DATE \_\_\_\_\_

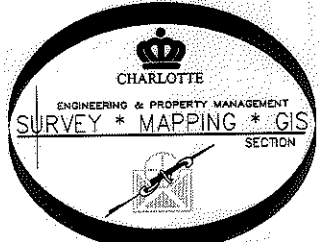

PREPARED BY:  
 CITY OF CHARLOTTE  
 ENGINEERING DEPARTMENT  
 600 EAST FOURTH STREET  
 CHARLOTTE, NC 28202  
 704-336-2291

		CHARLOTTE ENGINEERING DEPARTMENT	
JOHNSON & WALES WY/ 4TH ST./ TRADE ST. PROJECT		JOB NO. 512-08-018	
PROPERTY OF SOUTHPORT INVESTMENTS, L.L.C.		208018	
CHARLOTTE, MECKLENBURG CO., NC		SHEET 1	
DRAWN BY P.S.		OF 1	
DATE _____		CHECKED BY DS SURVEY SUPVR. <i>DS</i>	
K:\AutoCad\En_su-LD4\208018 Johnson&Wales-4thst-Trade st\dwg\PLATS\#68 078-124-01			

ACQUISITION BY DB 28259 PG 145-149