

81-06

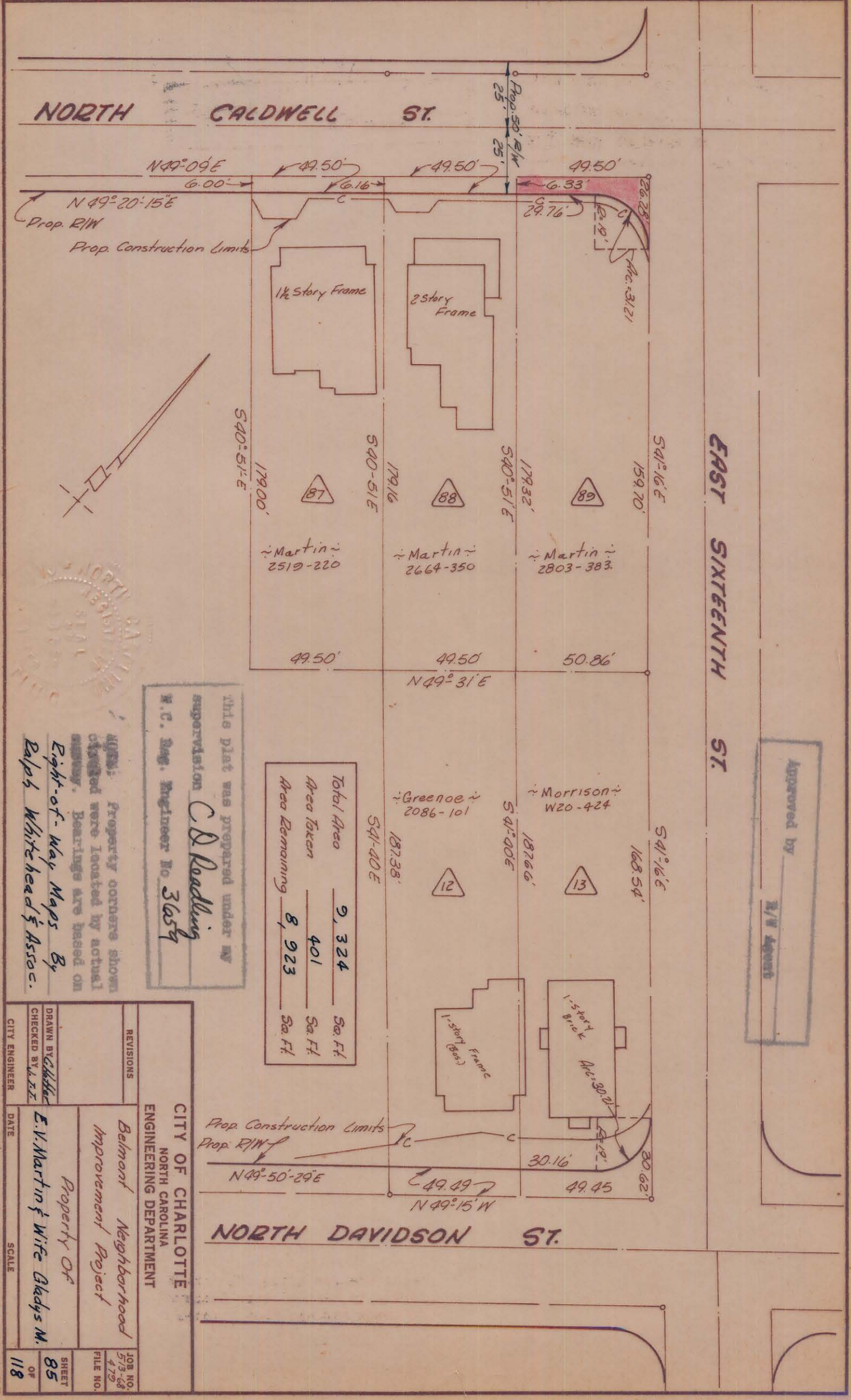

EAST SIXTEENTH ST.

Approved by
 [Signature Box]
 E. V. Martin

| | | |
|----------------|-------|---------|
| Total Area | 9,324 | Sq. Ft. |
| Area Taken | 401 | Sq. Ft. |
| Area Remaining | 8,923 | Sq. Ft. |

This plat was prepared under my supervision
C. D. Roadling
 P. C. Eng. Engineer No. 3654

NOTES: Property corners shown checked were located by actual survey. Bearings are based on Right-of-Way Maps By Ralph Whitehead's Assoc.

| | | |
|---|--|--------------------------|
| CITY OF CHARLOTTE NORTH CAROLINA ENGINEERING DEPARTMENT | | JOB NO. 513-68 |
| REVISIONS Belmont Neighborhood Improvement Project | PROPERTY OF E. V. Martin & Wife Gladys M. | FILE NO. 419 |
| DRAWN BY CHECKED BY CITY ENGINEER | DATE | SHEET 85 OF 118 |

081-066-07