

20-092-02

This plat was prepared under my supervision
C D Reading
 N. C. Reg. Engineer No. 3639

Approved by
 N/E Agent

NOTE: Property corners shown circled were located by actual survey. Bearings are based on Eight - of - Way Maps By Ralph Whitehead & Assoc.

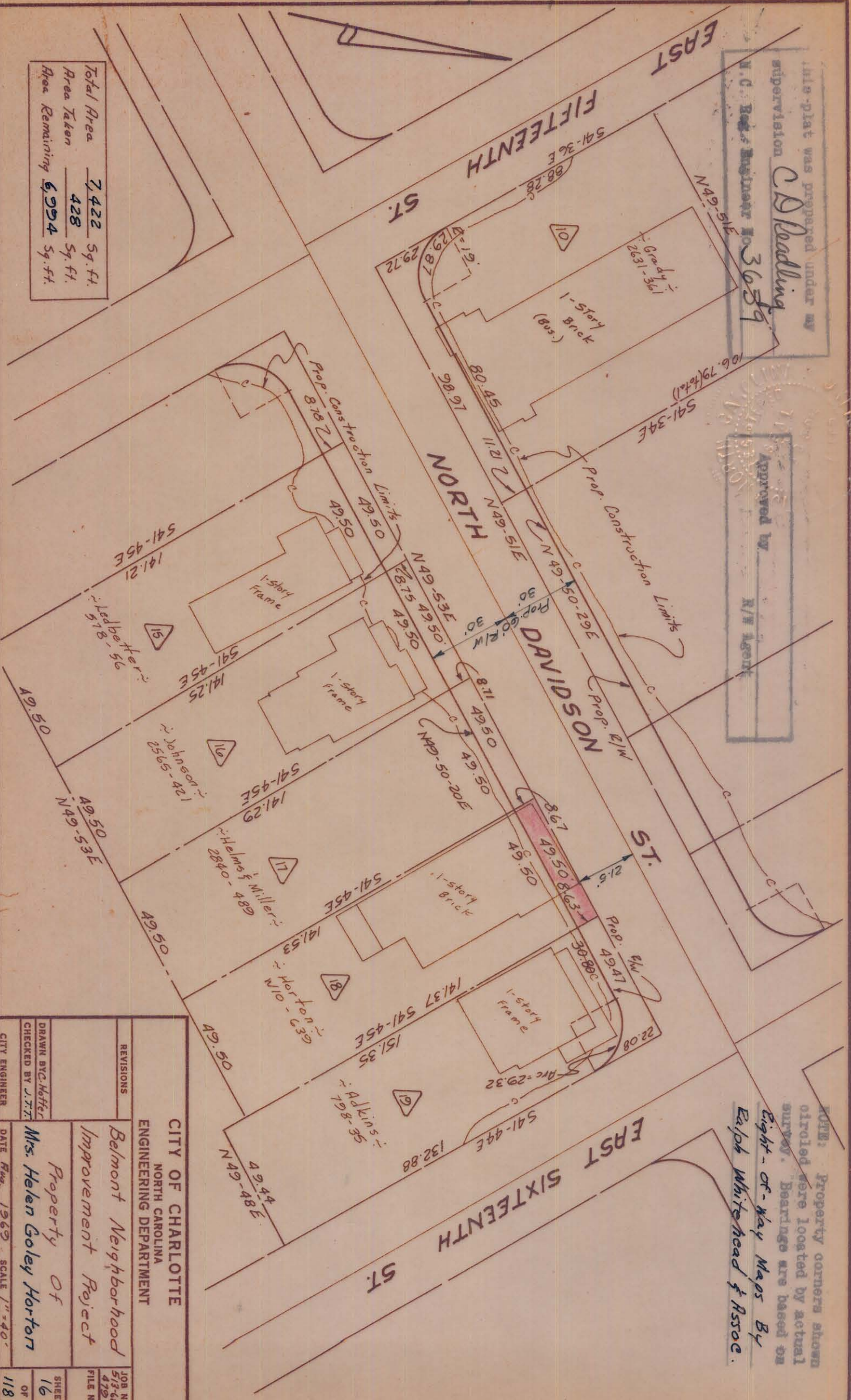

Total Area	7,422	Sq. Ft.
Area Taken	428	Sq. Ft.
Area Remaining	6,994	Sq. Ft.

CITY OF CHARLOTTE NORTH CAROLINA ENGINEERING DEPARTMENT	
REVISIONS	
Belmont Neighborhood Improvement Project	
Property Of Mrs. Helen Goley Horton	
DRAWN BY: Hoffel CHECKED BY: J.T.T. CITY ENGINEER	JOB NO. 513-68 FILE NO. 479
DATE: Aug. 1969 SCALE: 1" = 40'	SHEET 16 OF 118