

4-0760-18

Approved by _____
R/W Agent

This plat was prepared under my supervision
C. D. Reading
N.C. Reg. Engineer No. 3654

NOTE: Property corners shown circled were located by actual survey. Bearings are based on Right-of-Way Maps By Ralph Whitehead & Assoc.

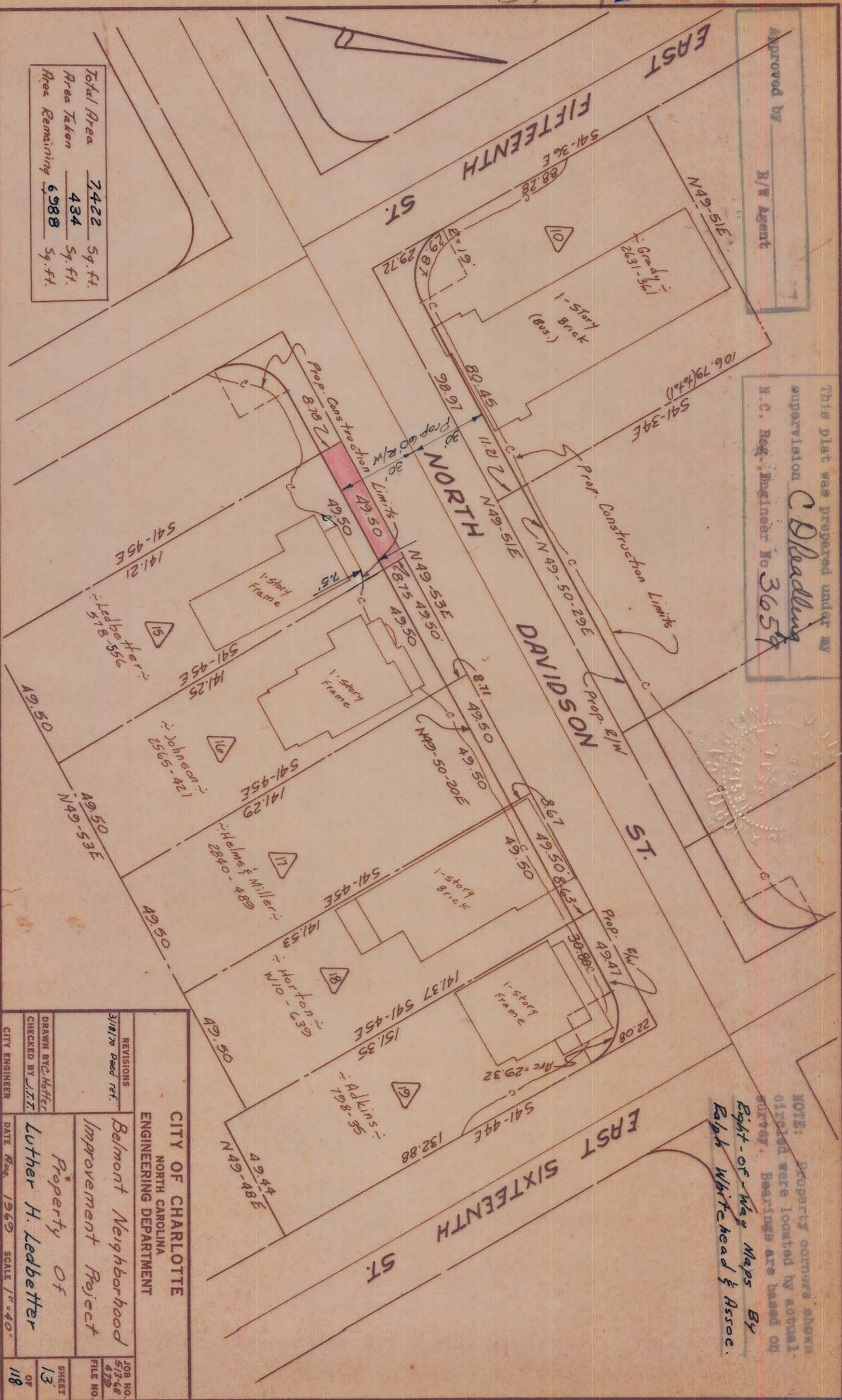

Total Area	2422	Sq. ft.
Area Taken	434	Sq. ft.
Area Remaining	6988	Sq. ft.

CITY OF CHARLOTTE NORTH CAROLINA ENGINEERING DEPARTMENT		REVISIONS 3/18/70 David ref.
Belmont Neighborhood Improvement Project		DRAWN BY: C. Hoffer CHECKED BY: J.T.N.
Property of Luther H. Ledbetter		DATE Recd. 1969 SCALE 1"=40'
JOB NO. 513-68 479	FILE NO.	SHEET 13 OF 118