

I, JACKIE W. BRIM, CERTIFY THAT THIS PLAT WAS PREPARED UNDER MY SUPERVISION AND THAT THE PLAT WAS PREPARED FOR THE PURPOSE OF EASEMENTS ONLY, AND IS NOT INTENDED TO BE A BOUNDARY SURVEY OF PROPERTY SHOWN.

*Jackie W. Brim* 8-19-15

JACKIE W. BRIM, NC P.L.S. L-4348 DATE  
STATE OF NORTH CAROLINA  
COUNTY OF MECKLENBURG

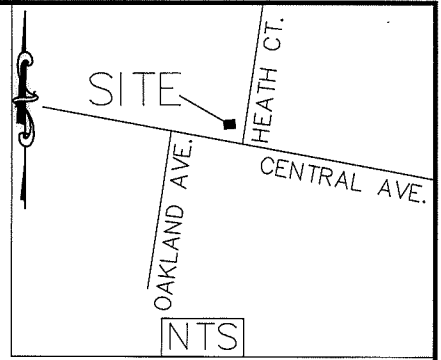
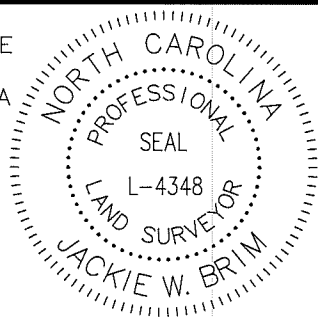

I, \_\_\_\_\_, REVIEW OFFICER OF MECKLENBURG COUNTY, CERTIFY THAT THE MAP OR PLAT TO WHICH THIS CERTIFICATION IS AFFIXED MEETS ALL STATUTORY REQUIREMENTS FOR RECORDING.

Not a Certified Document as to the Original Document but Only as to the Revisions - This document originally issued and sealed by David Snider, L-2942, on May 29, 2015. This document is only certified as to the revisions".

REVIEW OFFICER \_\_\_\_\_ DATE \_\_\_\_\_

3  
THE SALVATION ARMY CORP.  
TAX CODE: 081-113-07  
DB 1470 PG 506  
DB 2937 PG 183  
DB 3000 PG 173  
DB 3286 PG 411  
DB 4406 PG 324  
DB 6964 PG 725  
LESS R/W DB 6130 PG 784  
1011 CENTRAL AVE.

**LEGEND**

- IRON PIN FOUND
- CALCULATED POINT
- LINES SURVEYED
- LINES NOT SURVEYED
- TEMP. CONSTRUCTION EASEMENT
- SIDEWALK UTILITY EASEMENT

COMBINED GRID  
FACTOR=0.999840164  
N: 540686.89  
E: 1456593.84



4  
BETTY ANN WEBB.  
TAX CODE: 081-113-04  
DB 11722 PG 47  
LESS R/W DB 6066 PG 72  
1041 CENTRAL AVE.

5  
081-113-05  
1045 CENTRAL AVENUE, LLC  
DB 25327 PG 225  
LESS R/W DB 6061 PG 558  
1045 CENTRAL AVE.

CENTRAL AVE.  
(RIGHT-OF-WAY VARIES)

Line Table		
Line #	Length	Direction
L1	5.91	S13°56'37"W
L2	30.68	S14°11'05"W
L3	42.03	S75°48'55"E
L4	6.23	N14°11'05"E
L5	29.40	S75°48'55"E
L6	0.53	N48°43'37"E
L7	20.53	S13°56'37"W
L8	1.03	S64°26'21"E
L9	38.03	S75°48'55"E
L10	31.79	S69°55'07"E
L11	0.52	S16°04'43"W

- 1) BEARINGS AND DISTANCES SHOWN IN PARENTHESES ARE BASED ON RECORDED MAP INFORMATION.
- 2) TOTAL AREA 11,109 SQ. FT.
- 3) TEMP CONSTRUCTION EASEMENT 1,819 SQ. FT.
- 4) SIDEWALK UTILITY EASEMENT 284 SQ. FT.
- 5) AREA REMAINING 11,109 SQ. FT.

PREPARED BY:  
CITY OF CHARLOTTE  
ENGINEERING DEPARTMENT  
600 EAST FOURTH STREET  
CHARLOTTE, NC 28202  
704-336-2291

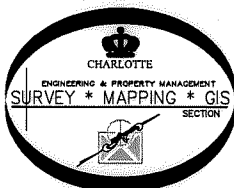

**CHARLOTTE**  
ENGINEERING DEPARTMENT

REVISIONS	10th/Central/Louise Pedestrian Improvements	JOB NO. 512-12-029
DEED REFERENCE 8/19/15	PROPERTY OF <b>BETTY ANN WEBB</b> CHARLOTTE, MECKLENBURG CO., NC	212029
SCALE 0 1" = 20" 1"		SHEET 1
DRAWN BY P.S.		OF 1
DATE	CHECKED BY DS	SURVEY SUPVR.

K:\AutoCad\En\_su-LD4\212029 10thCentral Louise Ped Imp\PLAT\#4 081-113-04.dwg