

This map was prepared for the purpose of right of way or easement acquisition only and it is not intended to be a boundary survey of the property shown.

NOTE: Property corners shown circled were located by actual survey. Bearings are based on North Carolina Grid System.

● EIP Symbol

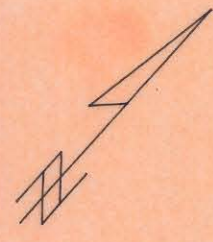

198.00 N 47°55'15"E

TANGENT TABLE

NO.	DISTANCE	BEARING
1	17.64	N 41°59'58"W
2	17.61	N 49°29'55"E
3	4.99	S 64°03'30"E
4	15.41	S 77°41'47"E
5	28.47	S 47°55'15"W
6	5.00	N 41°59'58"W
7	20.83	N 47°55'15"E
8	27.85	S 77°41'47"E
9	8.61	S 47°55'15"W

Deed 4468-0782

HARPER - CRAWFORD BAG COMPANY, INC.

43

E. 18TH STREET

TOT. 211.00 N 41°59'58"W

211.00 S 41°59'58"E

TOTAL AREA 41778 SF = 0.959 AC
 AREA TAKEN 390 SF = 0.009 AC
 REMAINING 41388 SF = 0.950 AC
 CONST EASM'T 265 SF = 0.006 AC

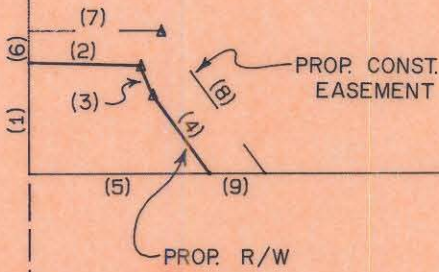

198.00 S 47°55'15"W

44

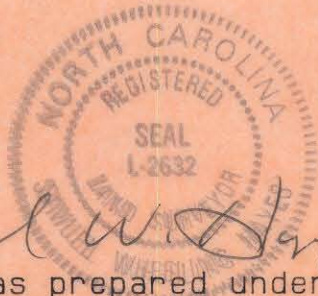

This plat was prepared under my supervision.

N. C. Reg. Surveyor No. L-2632

CHARLOTTE ENGINEERING DEPARTMENT		JOB NO.
REVISIONS 4-1-86 <i>SWH</i>	PARKWOOD AVENUE EXTENSION	FILE NO.
DRAWN BY		SHEET
CHECKED BY <i>R. Dennis Smith</i>	PROPERTY OF HARPER - CRAWFORD	OF
SURVEY SUPVR.		DATE 11-15-85 SCALE 1"=30'

83-071-26