

ACQUISITION BY CITY
RECORDED IN DEED BOOK

17217-701
DATE 05/19/2004

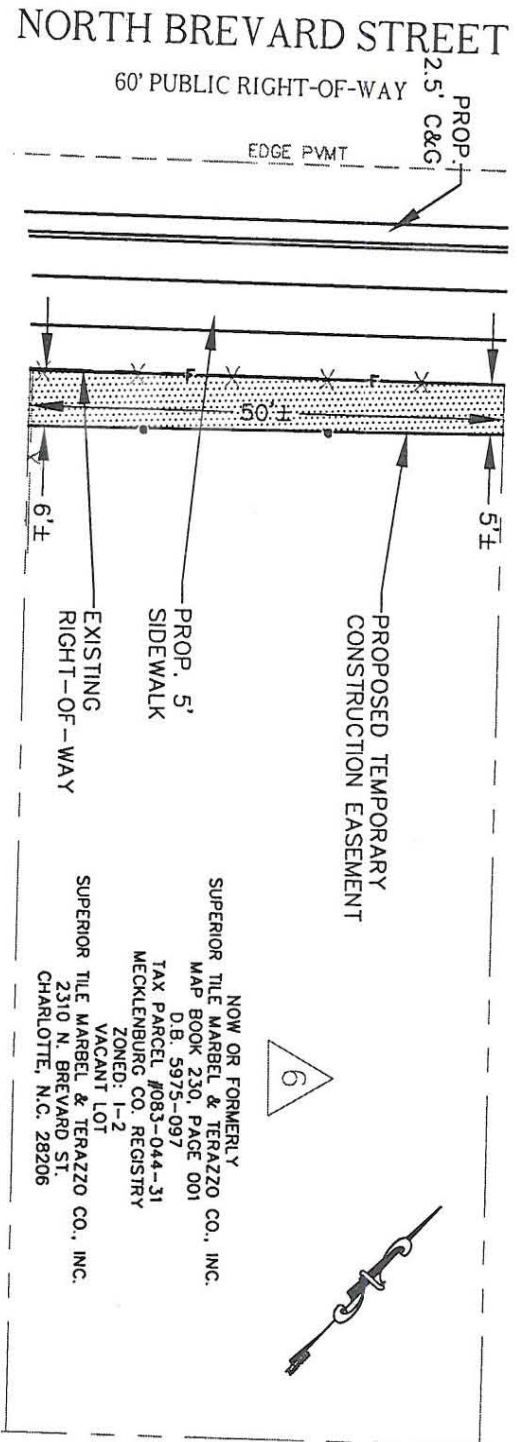

- 1) TOTAL AREA = ±5,524 SQ. FT.
- 2) TEMPORARY CONSTRUCTION EASEMENT = ±281 SQ. FT.

LEGEND

- Temporary Construction Easement
- Temporary Construction Easement
- Existing Edge of Pavement
- Existing Property Line

Note:

This map is not a certified survey and has not been reviewed by a local government agency for compliance with any applicable land development regulations.

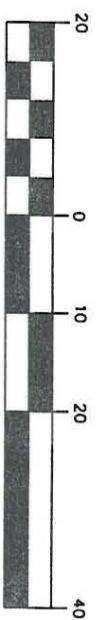

GRAPHIC SCALE



Kimley-Horn
© 2003

and Associates, Inc.
4601 CHARLOTTE PARK DR, STE 350
Charlotte, North Carolina 28217
TEL: (704) 333-5131
FAX: (704) 333-0845

 CHARLOTTE ENGINEERING & PROPERTY MANAGEMENT		512-02-047 JOB NO.		1" = 20' SCALE	
		PREPARED BY SS		08/23/03 DATE	
SUPERIOR TILE MARBEL & TERAZZO CO., INC. 2310 N. BREVARD ST. CHARLOTTE, N.C. 28206		TAX ID# 083-044-31 D.B. 5975 - P.G. 097		015016\037\CADD\015016037PLATS.DWG CAD FILE PTH	