

I, JACKIE W. BRIM, CERTIFY THAT THIS PLAT WAS PREPARED UNDER MY SUPERVISION AND THAT THE PLAT WAS PREPARED FOR THE PURPOSE OF ACQUISITION AND EASEMENTS ONLY, AND IS NOT INTENDED TO BE A BOUNDARY SURVEY OF PROPERTY SHOWN.

*Jackie W. Brim* 5-4-2017  
 JACKIE W. BRIM, NC P.L.S. L-4348 DATE

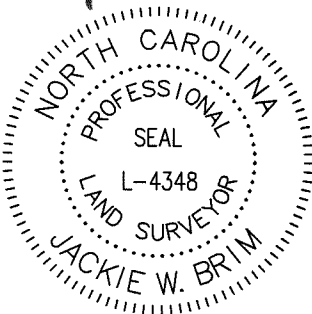

STATE OF NORTH CAROLINA  
 COUNTY OF MECKLENBURG

REVIEW OFFICER OF MECKLENBURG COUNTY, CERTIFY THAT THE MAP OR PLAT TO WHICH THIS CERTIFICATION IS AFFIXED MEETS ALL STATUTORY REQUIREMENTS FOR RECORDING

REVIEW OFFICER \_\_\_\_\_ DATE \_\_\_\_\_

5

HOWARD F. STARNES, Jr.  
 TAX CODE: 083-053-07  
 DB 15735 PG 234  
 DB 31027 PG 375 (less R/W)  
 425 E. 25th. STREET

#4 rebar  
 COMBINED GRID  
 FACTOR=0.99984438  
 N.547660.09  
 E.1457399.93

#4 rebar  
 \*tie line\*  
 N42°12'19"W  
 83.17'

68' DUKE POWER EASEMENT  
 DB 1900 PG 093  
 DB 1902 PG 243

68' DUKE POWER EASEMENT  
 DB 1900 PG 093  
 DB 1902 PG 243

(S28°48'27"W 211.40'  
 (S28°34'40"W 211.43'\*  
 180.62'

DB 1631 PG 313  
 SEWER EASEMENT

SEE DETAIL "A"  
 PAGE 2 OF 2

(S42°30'00"E 187.58')  
 (S42°16'28"E 187.13')  
 25TH. STREET  
 RIGHT-OF-WAY VARIES

#4 rebar  
 \*tie line\*  
 N42°16'28"W  
 20.00'  
 #5 rebar

PREPARED BY:  
 CITY OF CHARLOTTE  
 ENGINEERING & PROPERTY  
 MANAGEMENT DEPT.  
 600 EAST FOURTH STREET  
 CHARLOTTE, NC 28202  
 704-336-2291

NOTES:

- 1.) BEARINGS AND DISTANCES SHOWN IN PARENTHESES ARE BASED ON DB 1279-1607, DB 2211-184, DB 2789-453
- 2.) COMPUTED PROJECT DISTANCE \_\_\_\_\_\*
- 3.) TOTAL AREA 106,246 SQ. FT.
- 4.) TEMPORARY CONSTRUCTION EASEMENT 1,501 SQ. FT.
- 5.) TEMPORARY CONSTRUCTION EASEMENT OVERLAPS SEWER EASEMENT (DB 1631 PG 313) 347 SQ. FT.
- 6.) FEE SIMPLE OUTSIDE EXISTING R/W 4,748 SQ. FT.
- 7.) AREA REMAINING 101,498 SQ. FT.

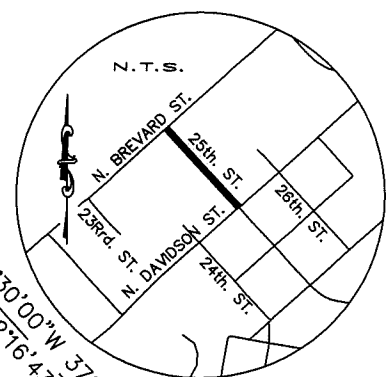

LEGEND

- #5 REBAR SET OR PK NAIL
- IRON PIN FOUND
- CALCULATED POINT
- LINES SURVEYED
- LINES NOT SURVEYED
- TEMP. CONSTRUCTION EASEMENT (e)
- SEWER EASEMENT (DB 1631 PG 313)
- FEE SIMPLE OUTSIDE EXISTING R/W

**FOUNTAINS NODA HOLDINGS, LLC**  
 TAX CODE: 083-053-08  
 DB 30619 PG 944  
 420 E. 28th. STREET  
 430 E. 28th. STREET  
 504 E. 28th. STREET  
 511 E. 25th. STREET

6

375.66'  
 (N47°30'00"E 400.00' total)  
 N47°42'56"E  
 #5 rebar

7

CITY OF CHARLOTTE  
 TAX CODE: 083-053-15  
 DB 28101 PG 166  
 E. 25th. STREET

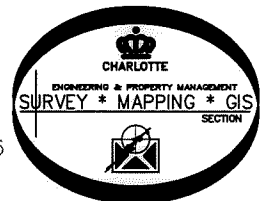

NC GRID NAD 83(2011)

<b>CHARLOTTE</b> ENGINEERING & PROPERTY MANAGEMENT DEPT.		
REVISIONS	<b>25 th. STREET CONNECTION</b>	JOB NO. 512-14-005
		214005
SCALE 1"=60'	PROPERTY OF FOUNTAINS NODA HOLDINGS, LLC TAX CODE: 083-053-08	SHEET 1
DRAWN BY G.F.	CHARLOTTE, MECKLENBURG CO., NC	OF 2
DATE	CHECKED BY JWB SURVEY SUPVR.	
K: \AutoCad\En_su-LD4\214005\PLAT MAPS\Plat-6 revised 12-06-16		

DB 32894 - 323

I, JACKIE W. BRIM, CERTIFY THAT THIS PLAT WAS PREPARED UNDER MY SUPERVISION AND THAT THE PLAT WAS PREPARED FOR THE PURPOSE OF ACQUISITION AND EASEMENTS ONLY, AND IS NOT INTENDED TO BE A BOUNDARY SURVEY OF PROPERTY SHOWN.

JACKIE W. BRIM, NC P.L.S. L-4348 DATE

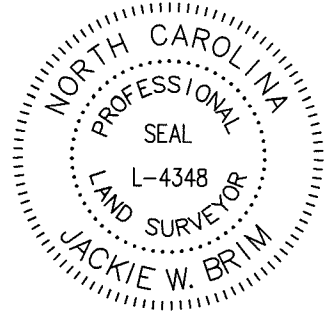

⑤  
 HOWARD F. STARNES, Jr.  
 TAX CODE: 083-053-07  
 DB 15735 PG 234  
 DB 31027 PG 375 (less R/W)  
 425 E. 25th. STREET

#4 rebar

DB 1631 PG 313  
 SEWER EASEMENT



⑥  
 FOUNTAINS NODA HOLDINGS, LLC  
 TAX CODE: 083-053-08  
 DB 30619 PG 944  
 420 E. 26th. STREET  
 430 E. 26th. STREET  
 504 E. 26th. STREET  
 511 E. 25th. STREET

RIGHT-OF-WAY VARIES  
 25TH. STREET

375.66'  
 (N47°30'00"E 400.00'total)  
 N47°42'56"E

⑦  
 CITY OF CHARLOTTE  
 TAX CODE: 083-053-15  
 DB 28101 PG 166  
 E. 25th. STREET

Line Table		
Line #	Length	Direction
L1	14.26	S28°48'27"W
L2	89.69	S41°57'52"E
L3	13.11	S48°02'14"W
L4	4.07	S47°47'41"W
L5	3.27	S47°45'13"W

PREPARED BY:  
 CITY OF CHARLOTTE  
 ENGINEERING & PROPERTY  
 MANAGEMENT DEPT.  
 600 EAST FOURTH STREET  
 CHARLOTTE, NC 28202  
 704-336-2291

		CHARLOTTE	
ENGINEERING & PROPERTY MANAGEMENT DEPT.			
REVISIONS		25 th. STREET CONNECTION	
 SCALE 1"=30' 0 1"		PROPERTY OF FOUNTAINS NODA HOLDINGS, LLC TAX CODE: 083-053-08 CHARLOTTE, MECKLENBURG CO., NC	
DRAWN BY G.F. DATE	CHECKED BY JWB SURVEY SUPVR.	JOB NO. 512-14-005 214005	SHEET 2 OF 2
K: \AutoCad\En_su-LD4\214005\PLAT MAPS\Plat-6 revised 12-06-16			

DB 22894-223