

I, MICHAEL C. SAWHILL, HEREBY CERTIFY THAT THIS MAP WAS PREPARED UNDER MY SUPERVISION AND THAT THE PLAT WAS PREPARED FOR THE PURPOSE OF ACQUISITION AND EASEMENTS ONLY, AND IS NOT INTENDED TO BE A BOUNDARY SURVEY OF PROPERTY SHOWN.

Michael C. Sawhill 4/9/2010
 MICHAEL C. SAWHILL, PLS L-3223

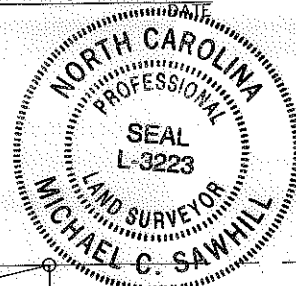

STATE OF NORTH CAROLINA
 COUNTY OF MECKLENBURG
 I, _____, REVIEW OFFICER OF MECKLENBURG COUNTY, CERTIFY THAT THIS MAP OR PLAT TO WHICH THIS CERTIFICATION IS AFFIXED MEETS ALL STATUTORY REQUIREMENTS FOR RECORDING.

REVIEW OFFICER _____ DATE _____

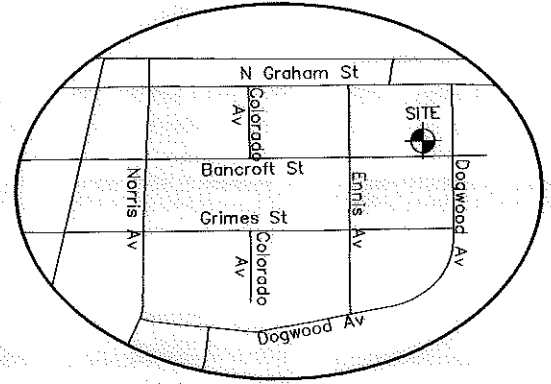

NCCS STATION "CHME"
 N: 560,980.534
 E: 1,436,243.620
 U.S. SURVEY FEET

FABRICATIONS, INC.
 DEED BOOK 23114, PAGE 559
 P/O LOTS C-E MAP BOOK 1166, PAGE 61
 TAX # 085-051-04
 2908 N. GRAHAM STREET

OLANDA CARR AND DELIA K CARR
 DEED BOOK 4773, PAGE 522
 P/O LOT 3, BLOCK 5 MAP BOOK 03, PAGE 01
 TAX # 085-051-03
 2928 NORTH GRAHAM STREET

CALVIN BYNUM
 DEED BOOK 5252, PAGE 389
 P/O LOT E, BLOCK 5 MAP BOOK 884, PAGE 339
 TAX # 085-051-11
 2927 BANCROFT STREET

LARRY J SMITH AND BEVERLY J SMITH
 DEED BOOK 3069, PAGE 125
 LOT D, BLOCK 5 MAP BOOK 1166, PAGE 61
 TAX # 085-051-10
 2921 BANCROFT STREET

TEMPORARY CONSTRUCTION EASEMENT 103 SQ. FT.

FOUND 1" OPEN TOP PIPE

BANCROFT STREET
 50' PUBLIC R/W

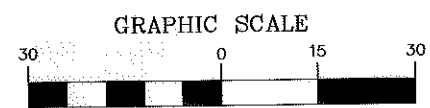

LEGEND

- Temporary Construction Easement
- Existing Right Of Way Line.....
- Existing Property Line
- Temporary Construction Easement
- Calculated Point.....
- Found Iron Pin.....
- Bearing And Distance Per Plat.....(N42°36'30"W) (100.00')

LINE TABLE		
LINE	LENGTH	BEARING
L1	0.97	S15°25'05"E

AREA TABLE	
PARCEL AREA =	11,326 SQ. FT.
TEMPORARY CONSTRUCTION EASEMENT =	103 SQ. FT.
AREA REMAINING=	11,326 SQ. FT.

 CHARLOTTE ENGINEERING & PROPERTY MANAGEMENT	CALVIN BYNUM 2927 BANCROFT STREET Tax ID # 085-051-11 Parcel # 135
	TRYON HILLS NEIGHBORHOOD IMPROVEMENT PROJECT Project Number: 512-07-031
THE SURVEY COMPANY, INC. 600 S. TRYON AVENUE, SUITE 200 CHARLOTTE, NC 28217 (704) 333-9999 (704) 333-9992 FAX	1" = 30' SCALE 03/18/10 DATE
	Path PATH