

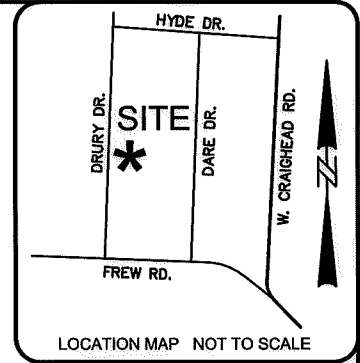

LOCALIZED GRID COORDINATES
N:554479.84
E:1461357.30

AREA TABLE	
TOTAL PARCEL AREA	10,204 SF
TOTAL PERMANENT UTILITY EASEMENT (PUE)	16 SF
TOTAL TEMP CONSTRUCTION EASEMENT (TCE)	953 SF
TOTAL PARCEL AREA REMAINING	10,204 SF



NOTE: PROPERTY CORNERS SHOWN CIRCLED WERE LOCATED BY ACTUAL FIELD SURVEY. BEARINGS ARE BASED ON N.C. STATE GRID NORTH. THIS MAP WAS PREPARED FOR THE PURPOSE OF RIGHT-OF-WAY AND/OR EASEMENT ACQUISITION ONLY, AND IS NOT INTENDED TO BE A BOUNDARY SURVEY OF THE PROPERTY SHOWN. THIS MAP WAS PREPARED UNDER MY SUPERVISION.

DRURY DRIVE
40' PUBLIC RIGHT OF WAY

085-114-14
VINCENT SHELDON GRIER
AND PATRICIA SCOTT GRIER
MB 5 PG 1
DB 19513 PG 933
406 DRURY DR.

085-114-09
RANDALL FRANKLIN BALLARD
MB 5 PG 1
DB 1173 PG 569
411 DARE DR.

1
085-114-20
ADRIAN N. JONES
MB 5 PG 1
DB 31544 PG 357
336 DRURY DR.
CHARLOTTE, MECKLENBURG,
NORTH CAROLINA

085-114-08
NEW FELLOWSHIP WORSHIP
CENTER INC
MB 5 PG 1
DB 27491 PG 525
333 DARE DR.

085-114-03
VL PROPERTIES LLC
MB 5 PG 1
DB 27557 PG 356
326 DRURY DR.

LINE	BEARING	DISTANCE
L1	S 09°29'27" W	27.83'
L2	N 80°36'43" W	17.41'
L3	S 08°54'01" W	21.10'
L4	N 81°05'59" W	10.00'
L5	N 30°32'52" W	29.75'
L6	N 80°00'00" W	4.00'
L7	N 10°00'00" E	4.00'
L8	S 80°00'00" E	4.00'
L9	S 10°00'00" W	4.00'

STATE OF NORTH CAROLINA
COUNTY OF MECKLENBURG

I, _____ REVIEW OFFICER OF MECKLENBURG COUNTY, CERTIFY THAT THE MAP OR PLAT TO WHICH THIS CERTIFICATION IS ATTACHED MEETS ALL STATUTORY REQUIREMENTS FOR RECORDING.

REVIEW OFFICER _____ DATE _____

DATUM DESCRIPTION:
THE COORDINATE SYSTEM DEVELOPED FOR THIS PROJECT IS BASED ON THE NAD83 STATE PLANE COORDINATES FOR NATIONAL GEODETIC SURVEY MONUMENT "M 044" WITH A NORthing OF 550069.86, EASTING OF 1449773.25. THE AVERAGE COMBINED FACTOR USED ON THIS PROJECT (GROUND TO GRID) IS 0.99984396 ALL LINEAR DISTANCES ARE LOCALIZED HORIZONTAL DISTANCES. THE VERTICAL DATUM IS BASED ON NAVD 88.

01/16/2017
TIMOTHY A. RUDOLPH NC PLS L-2866 DATE

LEGEND

- PERMANENT UTILITY EASEMENT (PUE)
- PERMANENT UTILITY EASEMENT UTE
- TEMPORARY CONSTRUCTION ESMT (TCE)
- TEMPORARY CONST ESMT
- RIGHT OF WAY
- EXISTING PROPERTY LINE
- ADJOINING PROPERTY LINE
- FIELD LOCATED PROPERTY IRON

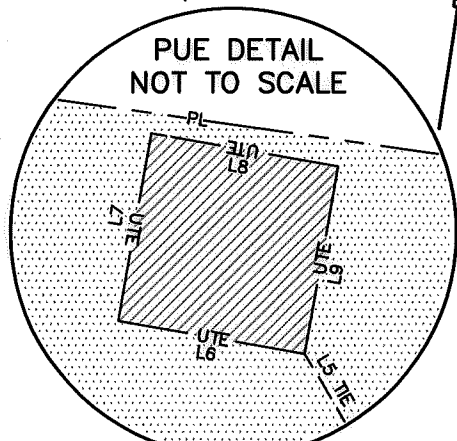
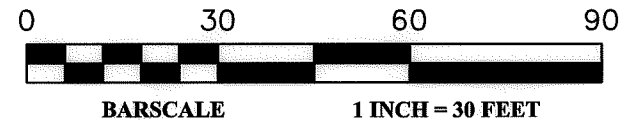

Dewberry
Engineers Inc.
LICENSE # F-0929

9300 HARRIS CORNERS PARKWAY
SUITE 220
CHARLOTTE, NC 28269-3797
PHONE: (704) 509-9918
FAX: (704) 509-9937

SWS Drury Dr 336
PM Project # SWDES00449
Easement Acquisition for Parcel 1
ADRIAN N. JONES
TAX ID NO. 085-114-20
DB 31544 PG 357 - MB 5 PG 1
336 DRURY DR.
CHARLOTTE, MECKLENBURG, NC

SWDES00449	1"=30'
JOB NO.	SCALE
M. DENNIS	01/16/2017
PREPARED BY	DATE

50077004/ PARCEL 1
DEWBERRY PROJECT / FILE NAME
1 OF 1
SHEET

DB 31714-364